

LEGEND

ROADS AND ROADWAY FEATURES		CONSERVATION AND RECREATION	
PRIMITIVE ROAD 1774 21	UNIMPROVED ROAD 1774 21	PICNIC GROUND	PLAYGROUND, BALL FIELD, ETC.
GRADED AND DRAINED 1774 21	SOIL SURFACED ROAD 1774 21	BATHING BEACH OR SWIMMING POOL	CAMP SITE
NOT GRADED OR DRAINED 1774 21	GRAVEL OR STONE ROAD 1774 21	TOURIST TRAIL	TOURIST TRAIL
GRADED AND DRAINED 1774 21	GRAVEL OR STONE ROAD WITH STABILIZED SURFACE 1774 21	SMALL PARK	FISH HATCHERY
BITUMINOUS ROAD-LOW TYPE 1774 21	PAVED ROAD 1774 21	BIRD SANCTUARY	GAME FARM
DIVIDED HIGHWAY	HIGHWAY WITH FULL CONTROL OF ACCESS	GAME PRESERVE	RIFLE CLUB
SIDE ROADS AND STREETS IN UNINCORPORATED URBAN COMPACTS AND EXTENSIONS OF LOCAL ROADS WITHIN MUNICIPALITIES	LANE UNDIVIDED HIGHWAY	POLO GROUNDS	RIDING ACADEMY
PRIVATE ROAD	PROJECTED ROAD	YACHT CLUB	AMUSEMENT PARK OR HALL
		FAIR GROUND, RACE COURSE, SPEEDWAY	DRIVE-IN THEATRE
			FARM UNITS, DWELLINGS, ETC.
			FARM UNIT
			ROWS OR GROUPS OF DWELLINGS CLOSELY SPACED
			COMBINED DWELLING AND STORE
			DWELLING AND POST OFFICE
			DWELLING, BUSINESS, AND FILLING STATION
			TENANT HOUSE
			SEASONAL OR SUMMER COLONY DWELLING
			HOTEL, INN
			CHURCH OR OTHER RELIGIOUS INSTITUTION
			CHURCH AND SCHOOL
			CEMETERY
			CHURCH WITH CEMETERY ADJACENT
			FRESH AIR FARM OR REST HOME
			HOSPITAL
			STATE PORT OF ENTRY OR WEIGHT STATION
			GROUP OF MIXED CULTURAL FEATURES CLOSELY SPACED
			INDUSTRIAL
			STORE OR SMALL BUSINESS ESTABLISHMENT
			BUSINESS AND POST OFFICE
			BUSINESS AND FILLING STATION
			BUSINESS, FILLING STATION, AND POST OFFICE
			FACTORY OR INDUSTRIAL PLANT
			MINE-SHAFT OR DRIFT
			OIL OR GAS WELL
			OIL OR GAS FIELD
			GAS TANK
			GROUP OF STORAGE TANKS
			FILLING STATION
			PUMPING STATION
			GAUGING OR PUMPING STATION
			VALVE HOUSE
			SEASONAL INDUSTRY
			MILK DEPOT, CREAMERY OR CHEESE FACTORY
			FRUIT OR NUT ORCHARD
			FRUIT OR PRODUCE PACKING HOUSE
			ROAD STAND FARM PRODUCTS SALES
			WAREHOUSE-GENERAL
			GRAIN ELEVATOR
			GROUP OF GRAIN STORAGE BINS
			NURSERY
			STOCK YARD-LOADING PEN OR CORRAL
			STOCK PEN AT RAILROAD SIDING
			GRAVEL PIT
			QUARRY
			KILN OR OVEN
			EDUCATIONAL AND CORRECTIONAL INSTITUTIONS
			SCHOOLHOUSE
			CONSOLIDATED OR LARGE SCHOOL
			TOWNHALL, GRANGE, OR COMMUNITY HALL
			AGRICULTURAL EXPERIMENT STATION
			COUNTY FARM
			CORRECTIONAL INSTITUTION
			PUBLIC SERVICE FACILITIES
			POST OFFICE
			HIGHWAY GARAGE
			FIRE ENGINE HOUSE
			GARBAGE OR RUBBISH DUMP
			SEWAGE DISPOSAL PLANT
			AUTO SALVAGE YARD
			TRANSFORMER STATION
			POWER PLANT
			POWER SUBSTATION
			BOOSTER STATION
			WATER SUPPLY
			RADIO STATION
			RADIO RANGE STATION
			MISCELLANEOUS
			FORT, ARMY CAMP, BARRACKS, OR OTHER MILITARY POST
			TRIANGULATION STATION
			BENCH MARK
			NATURAL FEATURES
			PROMINENT ELEVATION WITH NAME
			SINK OR DEPRESSION

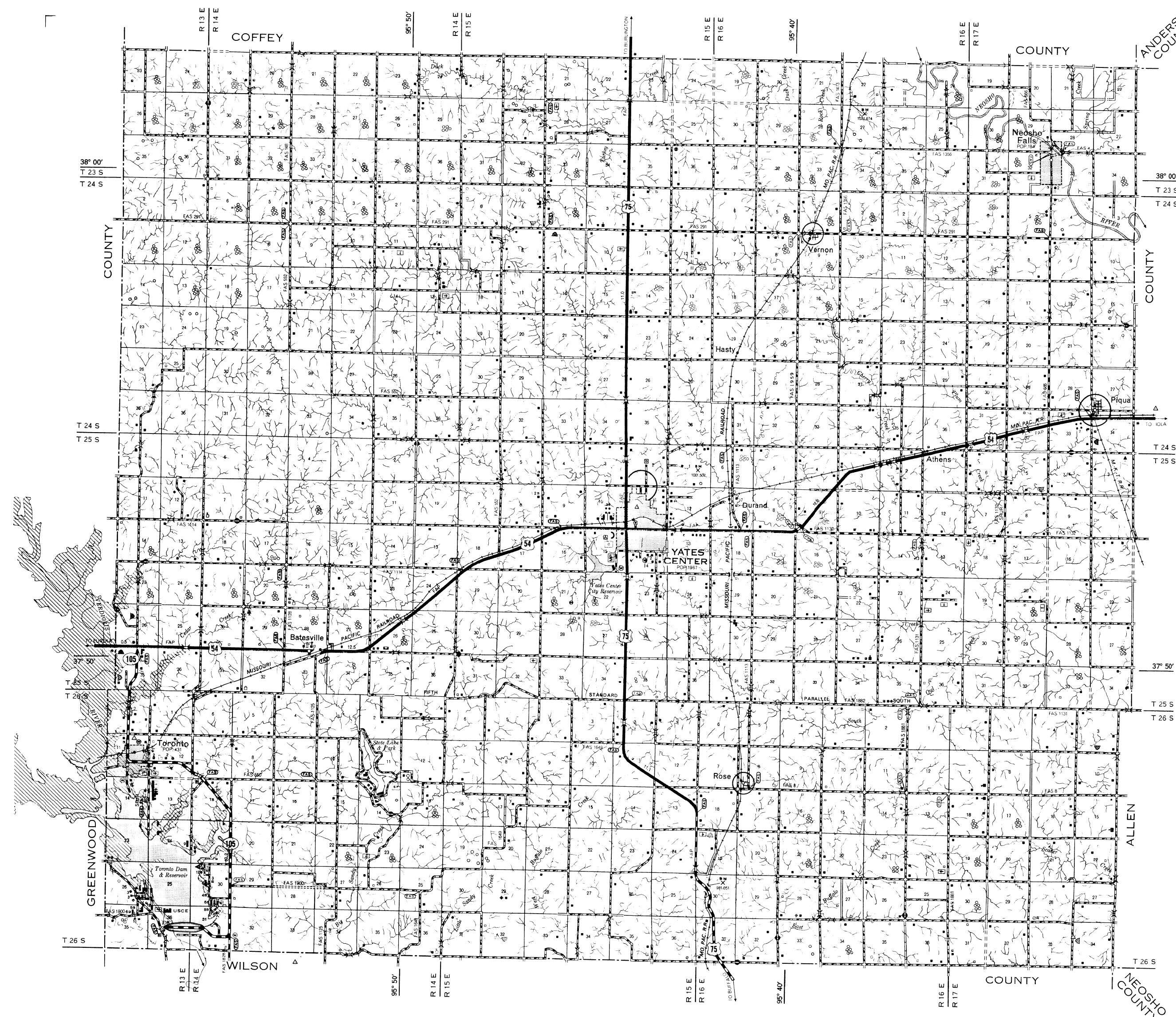

GENERAL HIGHWAY MAP
WOODSON COUNTY
 KANSAS

PREPARED BY THE
 STATE HIGHWAY COMMISSION OF KANSAS
 DEPARTMENT OF PLANNING AND DEVELOPMENT
 IN COOPERATION WITH THE
 U. S. DEPARTMENT OF TRANSPORTATION
 FEDERAL HIGHWAY ADMINISTRATION

SCALE
 0 1 2 3 4 MILES

1971

POLYCONIC PROJECTION

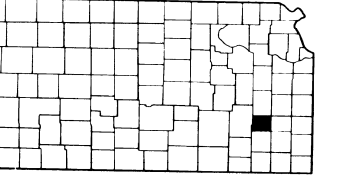

KEY TO COUNTIES

INVENTORY COMPLETED 1971
 F. A. AND STATE
 SYSTEMS REVISED TO 1971

FOR COUNTY CONTROL, BASED ON
 U. S. COUNTY AND TOWNSHIP SURVEY
 (1911) (N. T. & S. T.)

KANSAS STATE PRINTING PLANT

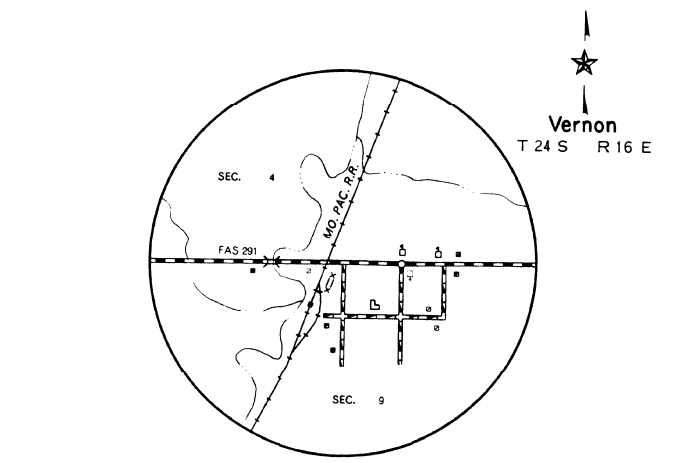

Vernon
 T 24 S R 16 E

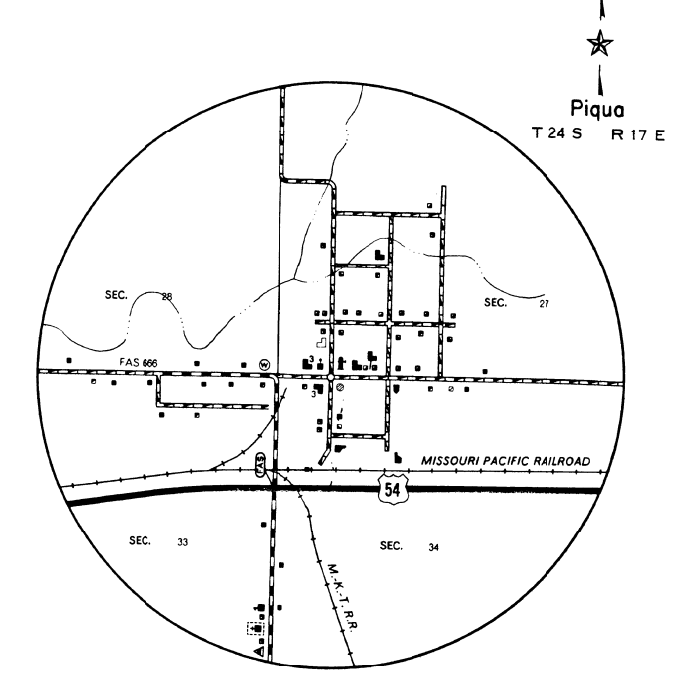

Piqua
 T 24 S R 17 E

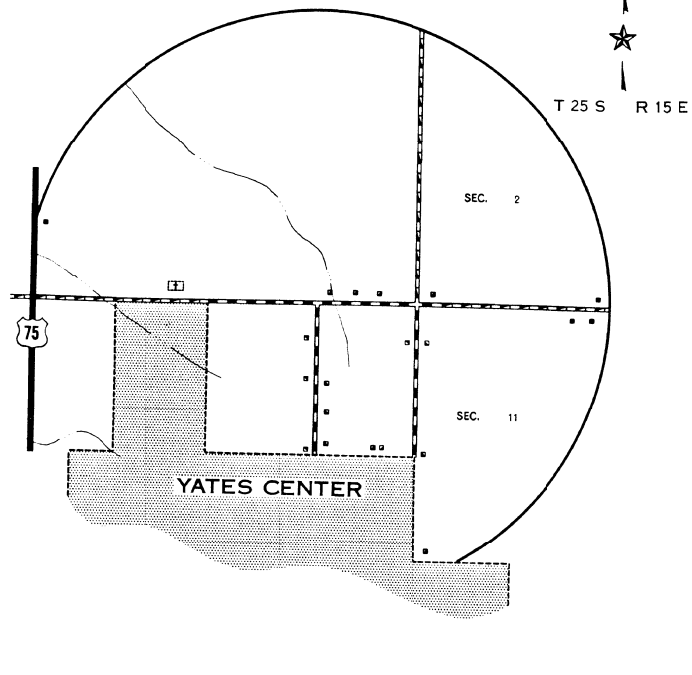

Yates Center
 T 25 S R 15 E

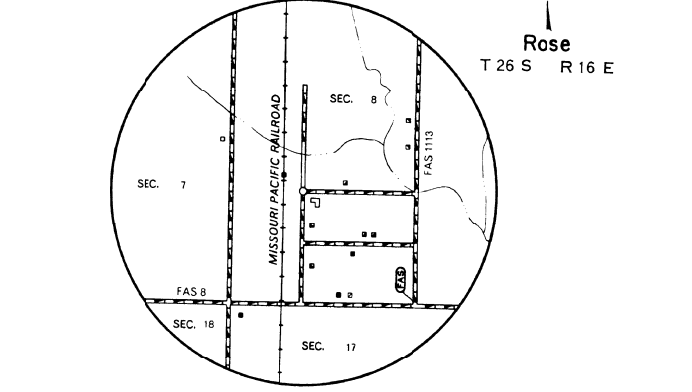

Rose
 T 26 S R 16 E

ENLARGEMENT SCALE
 0 1 MILE

DRAINAGE DELINEATED FROM AERIAL PHOTOGRAPHS