

**LEGEND**

<b>ROADS AND ROADWAY FEATURES</b>	<b>CONSERVATION AND RECREATION</b>
PRIMITIVE ROAD	PICNIC GROUND
UNIMPROVED ROAD	PLAYGROUND, BALL FIELD, ETC.
GRAVEL AND DRAINED ROAD	BATHING BEACH OR SWIMMING POOL
SOIL SURFACED ROAD	SCENIC SITE
GRAVEL OR STONE ROAD	CAMP SITE, NO PERMANENCE
GRAVEL OR STONE ROAD WITH STABILIZED SURFACE	TOWN OR VILLAGE CENTER
BITUMINOUS ROAD-LOW TYPE	CAMP OR LODGE
PAVED ROAD	CAMP OR LODGE, PERMANENT SITE WITH BUILDING
DIVIDED HIGHWAY	SMALL PARK
HIGHWAY WITH FULL CONTROL OF ACCESS	FISH HATCHERY
SIDE ROADS AND STREETS IN UNINCORPORATED URBAN COMPACTS AND EXTENSIONS OF LOCAL ROADS WITHIN MUNICIPALITIES	RIBBON SANCTUARY
4 LANE UNDIVIDED HIGHWAY	GAME FARM
PRIVATE ROAD	GAME PRESERVE
PROJECTED ROAD	RIFLE CLUB
	GOLF GROUND OR COUNTRY CLUB
	POLG GROUNDS
	RIDING ACADEMY
	YACHT CLUB
	AMUSEMENT PARK OR MALL
	FAIR GROUND, RACE COURSE, SPEEDWAY
	DRIVE-IN THEATRE
<b>ROAD SYSTEM DESIGNATION</b>	<b>FARM UNITS, DWELLINGS, ETC.</b>
FEDERAL-AID INTERSTATE HIGHWAY SYSTEM	FARM UNIT
FEDERAL-AID PRIMARY HIGHWAY SYSTEM	DWELLING (OTHER THAN FARM)
FEDERAL-AID SECONDARY HIGHWAY SYSTEM	ROWS OR GROUPS OF DWELLINGS CLOSELY SPACED
INTERSTATE NUMBERED HIGHWAY	COMBINED DWELLING AND STORE
U.S. NUMBERED HIGHWAY	DWELLING AND POST OFFICE
STATE HIGHWAY SYSTEM OR STATE NUMBERED HIGHWAY	DWELLING AND FILLING STATION
END OF DESIGNATED SYSTEM OR MARKED ROUTE	DWELLING, BUSINESS, AND FILLING STATION
	TENANT HOUSE
	SEASONAL OR SUMMER COLONY DWELLING
	HOTEL, INN
	CHURCH OR OTHER RELIGIOUS INSTITUTION
	CHURCH AND SCHOOL
	CEMETERY
	CHURCH WITH CEMETERY ADJACENT
	FRESH AIR FARM OR REST HOME
	HOSPITAL
	WELL
	STATE PORT OF ENTRY OR WEIGHT STATION
	GROUP OF MIXED CULTURAL FEATURES CLOSELY SPACED
	INDUSTRIAL
	STORE OR SMALL BUSINESS ESTABLISHMENT
	BUSINESS AND FILLING STATION
	BUSINESS, FILLING STATION, AND POST OFFICE
	FACTORY OR INDUSTRIAL PLANT
	MINE-SHAFT OR DRIFT
	OIL OR GAS WELL
	OIL OR GAS FIELD
	OIL TANK
	GAS TANK
	GROUP OF STORAGE TANKS
	FILLING STATION (NOT CONNECTED WITH OTHER BUSINESS)
	PUMPING STATION
	GAUGING OR PUMPING STATION
	VALVE HOUSE
	SEASONAL INDUSTRY
	MILK DEPOT, CREAMERY OR CHEESE FACTORY
	FRUIT OR NUT ORCHARD
	FRUIT OR PRODUCE PACKING HOUSE
	ROAD STAND FARM PRODUCTS SALES
	WAREHOUSE-GENERAL
	GRAIN ELEVATOR
	GROUP OF GRAIN OR STORAGE BINS
	GREENHOUSE
	NURSERY
	STOCK YARD-LOADING PEN OR CORRAL
	STOCK PEN AT RAILROAD SIDING
	GRAVEL PIT
	QUARRY
	KILN OR OVEN
	EDUCATIONAL AND CORRECTIONAL INSTITUTIONS
	SCHOOLHOUSE
	CONSOLIDATED OR LARGE SCHOOL
	TOWNHALL, GRANGE, OR COMMUNITY HALL
	AGRICULTURAL EXPERIMENT STATION
	COUNTY FARM
	CORRECTIONAL INSTITUTION
	PUBLIC SERVICE FACILITIES
	POST OFFICE
	HIGHWAY GARAGE
	FIRE ENGINE HOUSE
	GARBAGE OR RUBBISH DUMP
	SEWAGE DISPOSAL PLANT
	AUTO SALVAGE YARD
	TRANSFORMER STATION
	POWER PLANT
	POWER SUBSTATION
	BOOSTER STATION
	WATER SUPPLY, STAND PIPE, OR TANK
	RADIO STATION
	RADIO RANGE STATION
	MISCELLANEOUS
	FORT, ARMY CAMP, BARRACKS, OR OTHER MILITARY POST
	TRIANGULATION STATION
	BENCH MARK, WITH ELEVATION
	NATURAL FEATURES
	PROMINENT ELEVATION WITH NAME
	SINK OR DEPRESSION

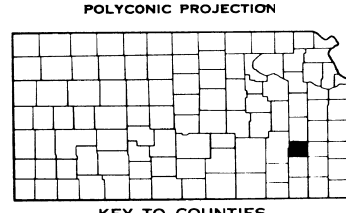
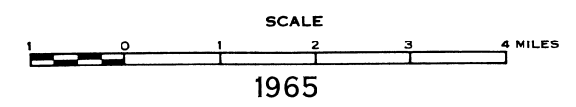
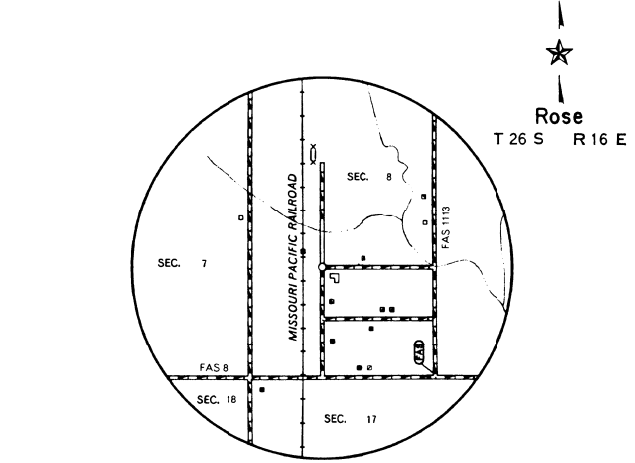
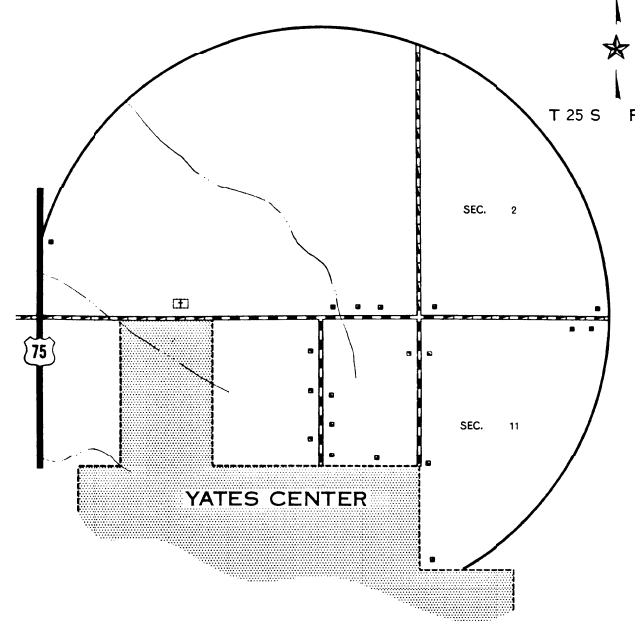
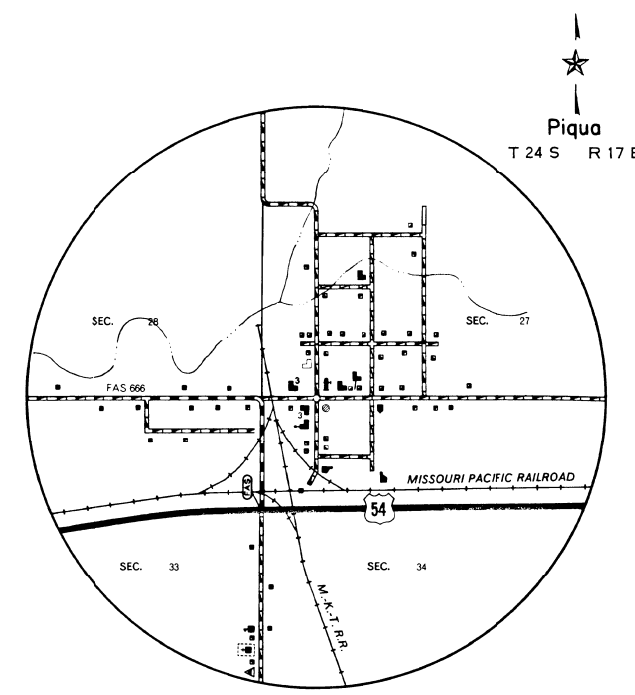
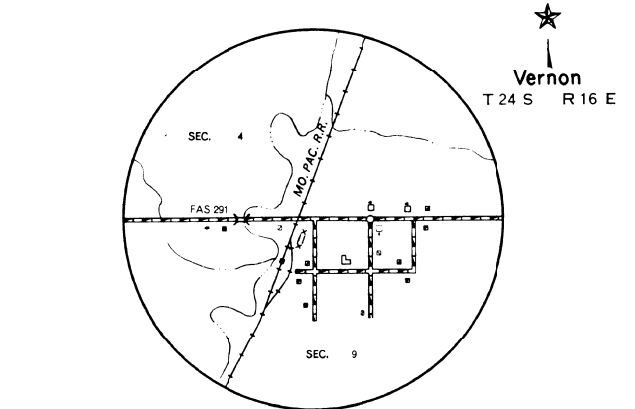
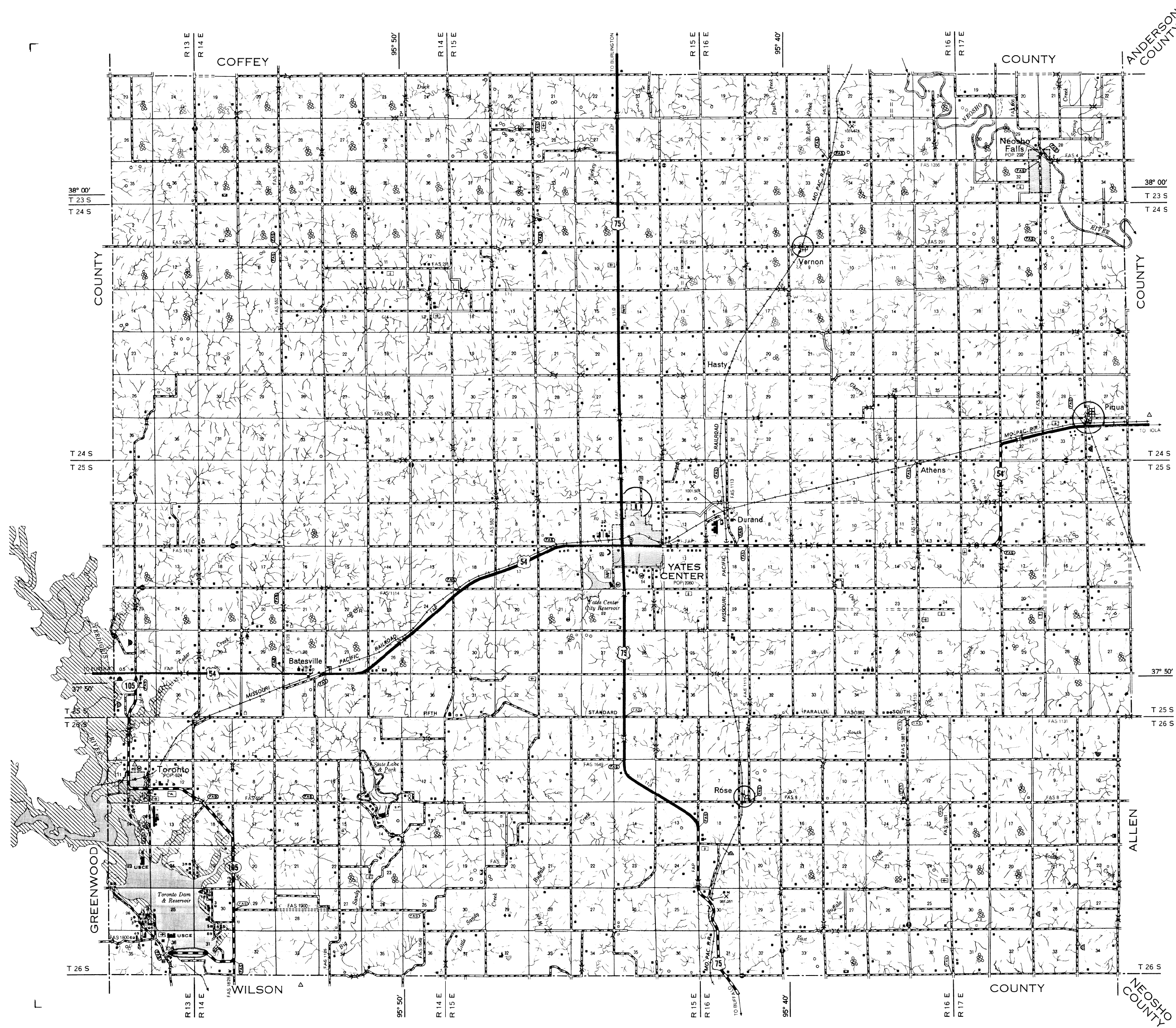

**GENERAL HIGHWAY MAP  
WOODSON COUNTY  
KANSAS**

PREPARED BY THE  
STATE HIGHWAY COMMISSION OF KANSAS  
PLANNING AND RESEARCH DEPARTMENT  
IN COOPERATION WITH THE  
U. S. DEPARTMENT OF COMMERCE  
BUREAU OF PUBLIC ROADS

INVENTORY COMPLETED 12-1-54  
P.A. AND STATE  
SYSTEMS REVISED TO 12-1-54

REVISIONS: 12-1-54  
U.S. GOVT. AND STATE SUPPLY  
1965 O-70-100