

LEGEND

ROADS AND ROADWAY FEATURES		CONSERVATION AND RECREATION	
Controlled Access (With Interchange) - Interstate	Public Recreation
Kansas Turnpike (KTA) (With Interchange)	Scenic, Tourist, or Historical Site
US Route - Controlled Access (With Interchange)	Trailer Park
US Route - Divided	Hotel or Motel
US Route - Undivided	Camp or Lodge (Permanent Site with Building)
State Route - Controlled Access (With Interchange)	Small Park (SP - State Park, CP - County Park, MP - Municipal Park, SR - Safety Rest Area)
State Route - Divided	Fish Hatchery
State Route - Undivided	Game Farm
RS Route - Paved	Game Preserve or Bird Sanctuary
RS Route - Unpaved	Rifle Club (Public)
Minor Road - Paved	Golf Course or Country Club
Minor Road - Stone or Gravel	Riding Academy, Saddle Club, or Stables
Minor Road - Soil	Race Course or Speedway
Side Road or Street in Unincorporated Area	Marina
Road System Designation	Rodeo Grounds
Rural Secondary System	Fair Grounds
County Road System		
Points Between Which Distances are Measured	FARM UNITS, DWELLINGS, ETC	
Interstate Numbered Highway	Dwelling
U.S. Numbered Highway	Multi Dwelling
State Highway System or State Numbered Highway	Church or Other Religious Institution
End of Designated System or Marked Route	Cemetery
		Church with Cemetery
		Rest Home
		Hospital
		State Port of Entry or Weigh Station
		Group of Mixed Cultural Features Closely Spaced
RAILROADS		INDUSTRIAL	
Railroad (Operating Company)	Stone or Small Business Establishment
Grade Crossing	Mine
Railroad Above	Oil or Gas Well(s)
Railroad Below	Storage Tank(s) (Gas or Oil)
		Pumping or Gauging Station
AIRWAYS AND AIRPORTS		Orchard or Tree Farm
Military Field (Some Facilities Available)	Grain Elevator
Airfield (Limited Facilities)	Stock Yard - Loading Pen or Corral
Airway Light Beacon (General)	Quarry
Airport (Complete Facilities) (Commercial or Municipal)	Feed Lot
		EDUCATIONAL AND CORRECTIONAL INSTITUTION	
		Schoolhouse
		Grange, Townhall, or Community Center
		K.S.U. Agricultural Research Center
		Correctional Institution
		Museum (General)
		PUBLIC SERVICE FACILITIES	
		Post Office
		Road Maintenance Shop
		Fire Station
		Landfill
		Sewage Disposal Plant
		Salvage Yard
		Power Plant
		Power Substation
		Water Tower
		Water Treatment Plant
		Wind Farm
		Radio Station (With Call Letters)
		U.S. Corps of Engineers Office
		NATURAL FEATURES	
		Prominent Elevation - With Name (Numerals Indicate Elevation Above Sea Level)
		MILITARY	
		Fort, Army Camp, Barracks, or Other Military Post
		CITIES OR NAMED PLACES	
		State Capital
		County Seat
		Populated Places
		Locales
		Incorporated City

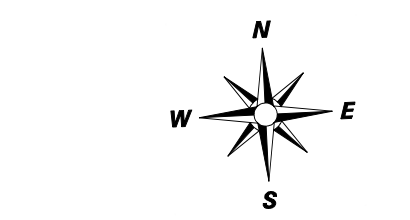
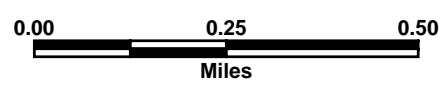
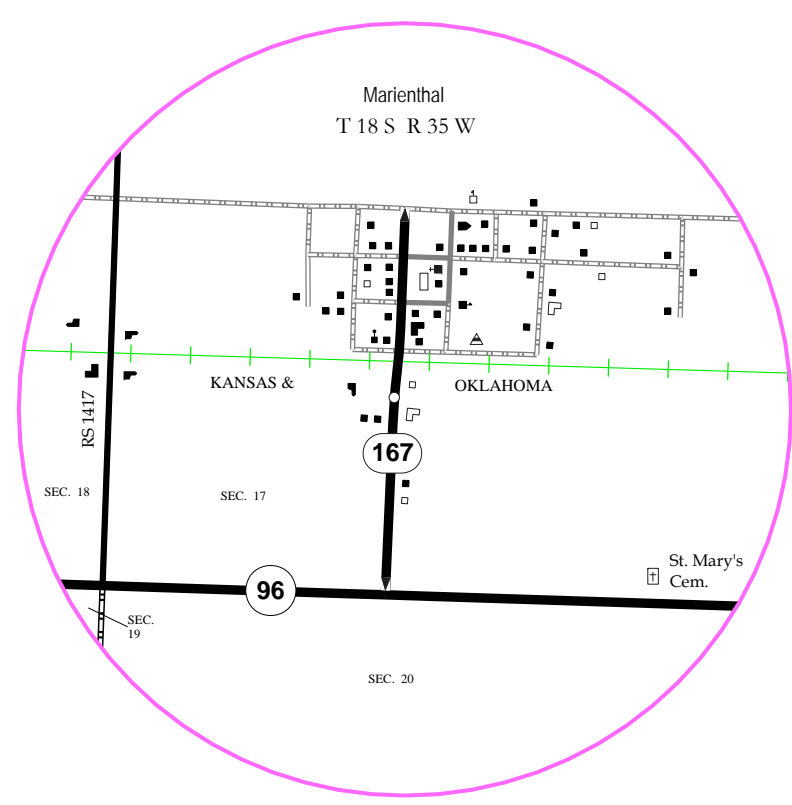
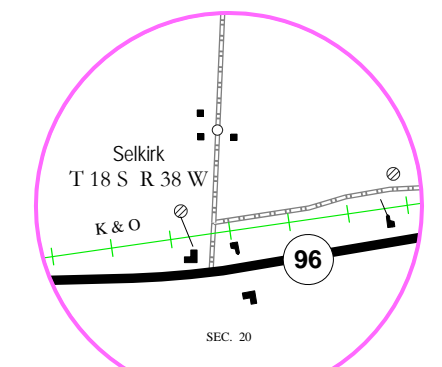

**GENERAL HIGHWAY MAP
WICHITA COUNTY
KANSAS**

PREPARED BY THE
**KANSAS DEPARTMENT OF TRANSPORTATION
BUREAU OF TRANSPORTATION PLANNING**
IN COOPERATION WITH
**U.S. DEPARTMENT OF TRANSPORTATION
FEDERAL HIGHWAY ADMINISTRATION**

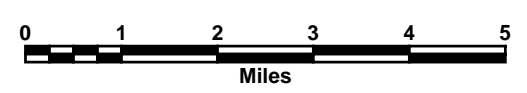

MARCH 2011

LAMBERT CONFORMAL CONIC PROJECTION

POPULATION - 2000 U.S. CENSUS
JULY 1, 2009 ESTIMATES AS
CERTIFIED TO THE SECRETARY OF STATE
BY DIVISION OF THE BUDGET JULY 1, 2010

REINVENTORY COMPLETED 10-8-2010

RURAL SECONDARY
SYSTEMS REVISED TO 11-4-2003

STATE BRIDGE DATA
REVISED TO 1-22-2010

NON-SYS BRIDGE DATA
REVISED TO 10-8-2008

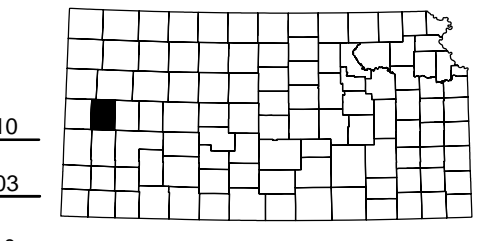

KDOT makes no warranties, guarantees, or representations for accuracy of this information and assumes no liability for errors or omissions.

**COMPUTER
GENERATED**