

- LEGEND**
- | | | | |
|--|---------------------------------------------------------------------------------------------------------------------------------|--|--------------------------------------------------------------------------------|
| | PRIMITIVE ROAD | | STATE LINE |
| | UNIMPROVED EARTH | | COUNTY LINE |
| | IMPROVED EARTH | | CORPORATE LINE |
| | METAL SURFACE (GRAVEL, STONE, CHATS, ETC.) | | SECTION LINE |
| | BITUMINOUS SURFACED (A.S.T., BIT. MIX.) | | BOUNDARY TO MARK ENLARGEMENT INSET |
| | PAVED SURFACE (CONCRETE, BRICK, BIT. MAC.) | | CITY & VILLAGE CENTERS |
| | FEDERAL AD HIGHWAY SYSTEM | | STATE CAPITAL |
| | FEDERAL AD SECONDARY HIGHWAY SYSTEM | | COUNTY SEAT |
| | STATE AID ROAD | | OTHER CITIES AND VILLAGES |
| | CLOVER LEAF | | OTHER CULTURAL FEATURES |
| | UNITED STATES HIGHWAY SYSTEM | | VACANT IN LINE |
| | STATE HIGHWAY SYSTEM | | FARM UNIT |
| | RAILROAD | | DWELLING (OTHER THAN FARM) |
| | RAILROAD (ANY NUMBER OF TRACKS) USED BY SINGLE OPERATING COMPANY | | ROW OR GROUP OF DWELLINGS (FIGURE DENOTES NUMBER OF DWELLINGS) |
| | RAILROAD (ANY NUMBER OF TRACKS) USED BY MORE THAN ONE OPERATING COMPANY ON SAME OR ADJACENT RIGHTS OF WAY (FOOT TRACAGE RIGHTS) | | COMBINED DWELLING AND STORE OR SMALL BUSINESS |
| | ELECTRIC INTERURBAN OR SUBURBAN RAILROAD | | TENANT HOUSE |
| | RAILROAD STATION | | SEASONAL DWELLINGS CLOSELY SPACED (FIGURE DENOTES NUMBER OF DWELLINGS) |
| | GRADE CROSSING | | CHURCH-OTHER RELIGIOUS INSTITUTIONS |
| | RAILROAD ABOVE | | COUNTY FARM |
| | RAILROAD BELOW | | HOSPITAL |
| | AIRWAYS | | CEMETERY |
| | ARMY, NAVY OR MARINE CORP. FIELD | | WELL |
| | CIVIL AERONAUTICS AUTHORITY INTERMEDIATE FIELD | | WHARF |
| | COMMERCIAL OR MUNICIPAL FIELD | | CHURCH WITH CEMETERY ADJACENT |
| | MARKED AUXILIARY FIELD | | GROUP OF MIXED CULTURAL FEATURES (FIGURE DENOTES NUMBER OF FEATURES) |
| | AIRPLANE LANDING FIELD-MARKED OR EMERGENCY | | STONE OR SMALL BUSINESS ESTABLISHMENT (FIGURE DENOTES NUMBER OF ESTABLISHMENT) |
| | AIRWAY BEACON LIGHT | | FACTORY OR INDUSTRIAL PLANT |
| | AIRPORT HOUSE-FLAGLIGHTS | | MINE SHAFT OR DRIFT (ANY KIND) |
| | NAVIGABLE STREAM NAVIGATION | | OIL OR GAS WELL |
| | NAVIGABLE STREAM (INTERMITTENT NAVIGATION) | | OIL TANK |
| | INTERMITTENT STREAM (NARROW) | | GAS TANK |
| | INTERMITTENT STREAM (WIDE) | | GROUP OF GAS OR OIL TANKS |
| | NARROW STREAM | | PUMPING STATION, OIL OR GAS |
| | WIDE STREAM | | GAUGING OR FLAMING STATION (GENERAL) |
| | MARSH OR SWAMP LAND | | MINE OPENING (SHAFT OR DRIFT) |
| | DRAINAGE DITCH (MAN) (ARROWS POINT IN DIRECTION OF FLOW) | | SEASONAL INDUSTRY (CANNERY OR SMALL GRAIN MILL) |
| | IRRIGATION DITCH (ARROWS POINT IN DIRECTION OF FLOW) | | BEET DUMP |
| | RESERVOIR, POND OR LAKE | | STOCK YARDS-LOADING PEN |
| | RESERVOIR WITH DAM | | GRAVEL PIT |
| | DAM | | QUARRY |
| | HIGHWAY BRIDGE (ANY TYPE) | | POST OFFICE |
| | LEVEE OR DIKE | | TOURIST CAMP |
| | LEVEE OR DIKE (WITH ROAD) | | NURSERY |
| | MINOR STRUCTURES CONCRETE FORD OR DIP | | SCHOOL HOUSE |
| | FORD - ROAD ESTABLISHED | | CONSOLIDATED OR LARGE SCHOOL |
| | PARKS & OTHER RESERVATIONS | | OTHER EDUCATIONAL INSTITUTIONS |
| | CCC CAMP | | TOWNSHIP, GRANGE OR COMMUNITY HALL |
| | BIRD SANCTUARY | | LETTERS DESIGNATE ROAD |
| | GAME FARM | | CORRECTIONAL INSTITUTION |
| | GAME PRESERVE | | WATER SUPPLY STAND PIPE |
| | INDIAN BURIAL GROUND | | TRANSMISSION LINE |
| | GOLF OR COUNTRY CLUB | | POWER PLANT |
| | ATHLETIC FIELD OR AMUSEMENT PARK | | TRANSFORMER STATION |
| | SMALL PARK (S.P. STATE, C.P. COUNTY, M.P. MUNICIPAL) | | RADIO STATION |
| | FAIRGROUND, RACE COURSE, SPEEDWAY | | RADIO STATION (WITH CALL LETTERS) |
| | CAMP OR LODGE | | K.H.C. SHOPS |
| | END OF K NUMBERED ROUTE | | PORT OF ENTRY |
| | END OF US NUMBERED ROUTE | | GARAGE OR RUBBISH DUMP |
| | | | SEWAGE DISPOSAL PLANT |
| | | | FORT, ARMY CAMP, BARRACKS OR MILITARY POST |
| | | | POINTS BETWEEN WHICH DISTANCES ARE MEASURED INDICATED THUS |
| | | | TRIANGULATION STATION |
| | | | END OF FA ROUTE |
| | | | END OF FAS ROUTE |
| | | | END OF SA ROUTE (NON FA OR FAS) |

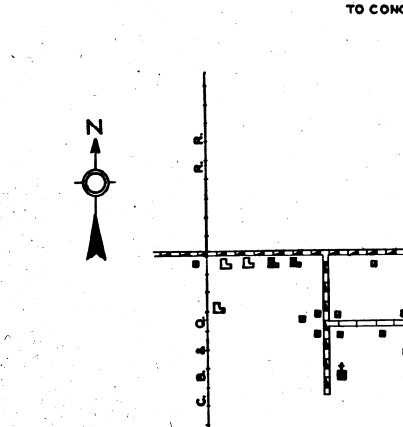
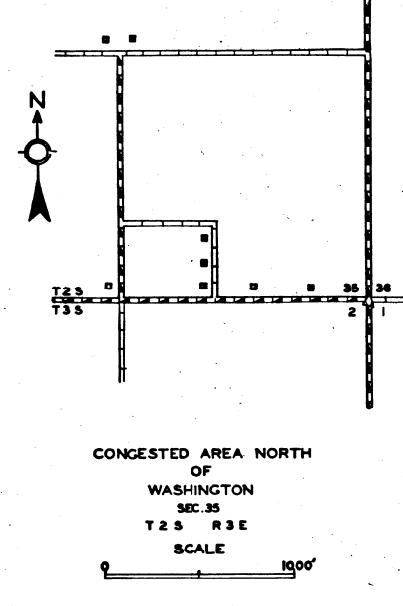
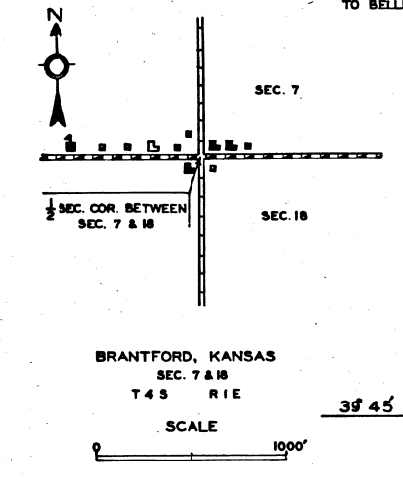

HIGHWAY & TRANSPORTATION MAP WASHINGTON COUNTY KANSAS

PREPARED BY THE
KANSAS STATE HIGHWAY DEPARTMENT
IN COOPERATION WITH THE
FEDERAL WORKS AGENCY
PUBLIC ROADS ADMINISTRATION
DATA OBTAINED FROM
STATE-WIDE HIGHWAY PLANNING SURVEY

SCALE 1 MILE

