

ROADS AND ROADWAY FEATURES		CONSERVATION AND RECREATION	
PRIMITIVE ROAD	UNIMPROVED ROAD	PICNIC GROUND	BATHING BEACH OR SWIMMING POOL
GRADED AND DRAINED ROAD	SOIL SURFACED ROAD	SCENIC SITE	CAMP SITE, NO PERMANENCE
GRAVEL OR STONE ROAD	GRAVEL OR STONE ROAD WITH TARMAC SURFACE	CAMP OR LODGE	FISH HATCHERY
BITUMINOUS ROAD-LOW TYPE	PAVED ROAD	BIRD SANCTUARY	GAME FARM
DIVIDED HIGHWAY	HIGHWAY WITH FULL CONTROL OF ACCESS	GAME PRESERVE	RIFLE CLUB
SIDE ROADS AND STREETS IN URBAN	PORTED URBAN COMPACTS AND EXTENSIONS OF LOCAL ROADS WITHIN MUNICIPALITIES	GOLF GROUND OR COUNTRY CLUB	FOLD GROUNDS
4 LANE UNDIVIDED HIGHWAY	PRIVATE ROAD	RIDING ACADEMY	YACHT CLUB
PROJECTED ROAD		AMUSEMENT PARK OR HALL	FAIR GROUND, RACE COURSE, SPEEDWAY
		DRIVE-IN THEATRE	
ROAD SYSTEM DESIGNATION		FARM UNITS, DWELLINGS, ETC.	
FEDERAL-AID INTERSTATE HIGHWAY SYSTEM	FEDERAL-AID PRIMARY HIGHWAY SYSTEM	FARM UNIT	SCHEMATIC
FEDERAL-AID SECONDARY HIGHWAY SYSTEM	POINTS BETWEEN WHICH DISTANCES ARE MEASURED INDICATED THIS	ROWS OR GROUPS OF DWELLINGS CLOSELY SPACED	COMBINED DWELLING AND STORE
INTERSTATE NUMBERED HIGHWAY	U.S. NUMBERED HIGHWAY	DWELLING AND POST OFFICE	DWELLING AND FILLING STATION
STATE HIGHWAY SYSTEM OR STATE NUMBERED HIGHWAY	END OF DESIGNATED SYSTEM OR MARKED ROUTE	DWELLING, BUSINESS, AND FILLING STATION	TEMPORARY HOUSE
		SEASONAL OR SUMMER COLONY DWELLING	HOTEL, INN
		CHURCH OR OTHER RELIGIOUS INSTITUTION	CHURCH AND SCHOOL
		CEMETERY	CHURCH WITH CEMETERY ADJACENT
		FRESH AIR FARM OR REST HOME	WELL
		STATE PORT OF ENTRY OR WEIGHT STATION	GROUP OF MISCELLANEOUS FEATURES CLOSELY SPACED
RAILROADS		INDUSTRIAL	
RAILROAD	RAILROADS IN JUNCTURE POSITION	STORE OR SMALL BUSINESS ESTABLISHMENT	BUSINESS AND POST OFFICE
RAILROAD STATION	NARROW GAUGE RAILROAD	BUSINESS FILLING STATION AND POST OFFICE	FACTORY OR INDUSTRIAL PLANT
ELECTRIC INTERURBAN OR SUBURBAN RAILROAD	ABANDONED RAILROAD	MINE SHAFT OR DRIFT	OIL OR GAS WELL
ABANDONED RAILROAD	ABANDONED ELECTRIC LINE	OIL TANK	GAS TANK
RAILROAD CROSSING	RAILROAD STATION	GROUP OF STORAGE TANKS	FILLING STATION
RAILROAD ABOVE	RAILROAD BELOW	PUMPING STATION	GAUGING OR PUMPING STATION
RAILROAD BRIDGE		VALVE HOUSE	SEASONAL INDUSTRY
		FRUIT OR NUT ORCHARD	ROAD STAND FARM PRODUCTS SALES
		GRAIN ELEVATOR	GROUP OF GRAIN STORAGE BINS
		GREENHOUSE	HURIBERY
		STOCK YARD-LOADING PEN OR CORRAL	STOCK PEN AT RAILROAD SIDING
		TRAVEL PIT	QUARRY
		BRIDGES FOR LONG RIVER CROSSINGS	
AIRWAYS AND AIRPORTS		EDUCATIONAL AND CORRECTIONAL INSTITUTIONS	
AIR ROUTE	AIRFIELD, LIMITED FACILITIES	SCHOOLHOUSE	CONSOLIDATED OR LARGE SCHOOL
AIRPORT, COMPLETE FACILITIES	LANDING AREA OR STRIP	TOWNSHIP GRADING COMMUNITY HALL	AGRICULTURAL EXPERIMENT STATION
AIRWAY LIGHT BEACON	AIRPORT-GENERAL	COUNTY FARM	CORRECTIONAL INSTITUTION
NAVIGATION		PUBLIC SERVICE FACILITIES	
NAVIGABLE STREAM	DRAINAGE	POST OFFICE	HIGHWAY GARAGE
INTERMITTENT STREAM	NARROW STREAM	FIRE ENGINE HOUSE	GARAGE OR RUBBISH DUMP
WIDE STREAM	IRIGATION DITCH	WATER SUPPLY STAND PIPE OR TANK	SEWAGE DISPOSAL PLANT
LAKE, RESERVOIR, OR POND	LAKE, RESERVOIR, OR POND WITH DAM	TRANSMISSION LINE	POWER PLANT
DRY LAKE SUBJECT TO FLOOD	MARSH OR SWAMP LAND	POWER SUBSTATION	BOOSTER STATION
OVERFLOW LAND		UNDERGROUND TELEPHONE OR RADIO CABLE	RADIO STATION
STRUCTURES		MISCELLANEOUS	
HIGHWAY BRIDGE, GENERAL	SMALL BRIDGES CLOSELY SPACED	FORT, ARMY CAMP, BARRACKS, OR OTHER	MILITARY POST
TRUSS OR GIRDER	CANTILEVER BRIDGE	TRIANGULATION STATION	BENCH MARK
COVERED BRIDGE	HIGHWAY GRADE SEPARATION		
GENERAL	MISCELLANEOUS STRUCTURES		
DAM WITH ROAD	LEVEE OR DIKE		
CONCRETE FORD OR DIP	FORD-ROAD ESTABLISHED		
CATTLE GUARD	GATE ACROSS ROAD		
BOUNDARIES		NATURAL FEATURES	
STATE	COUNTY	PROMINENT ELEVATION WITH NAME	SINK OR DEPRESSION
CORPORATE LINES	BOUNDARY LINES ESTABLISHED FOR DELIMITED URBAN PLACES		
SECTION LINE	MATCH LINE BETWEEN ADJOINING SHEETS OF SAME COUNTY		
BOUNDARY TO MARK ENLARGEMENT INSET	PARKS AND OTHER RESERVATIONS NATIONAL		
	STATE, COUNTY, OR MUNICIPAL		
	FEDERAL DEVELOPMENT PROJECT		
	MONUMENT-SMALL HISTORIC SITE		
	CITY AND VILLAGE CENTERS		
	STATE CAPITAL		
	COUNTY SEAT		
	OTHER CITIES AND VILLAGES		
	INCORPORATED CITY OR VILLAGE		
	BOUNDARY LIMITS FIXED FOR SPECIAL TAXING AREAS AND OTHER UNINCORPORATED URBAN PLACES DELIMITED		

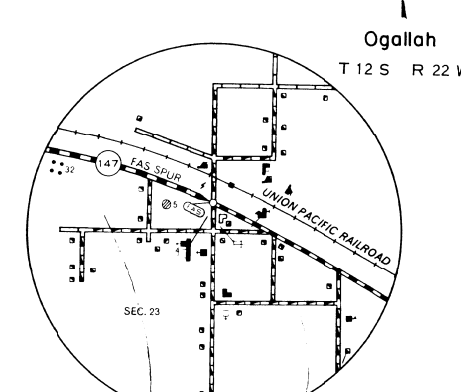

# GENERAL HIGHWAY MAP TREGO COUNTY KANSAS

PREPARED BY THE  
STATE HIGHWAY COMMISSION OF KANSAS  
HIGHWAY PLANNING DEPARTMENT  
IN COOPERATION WITH THE  
U. S. DEPARTMENT OF COMMERCE  
BUREAU OF PUBLIC ROADS

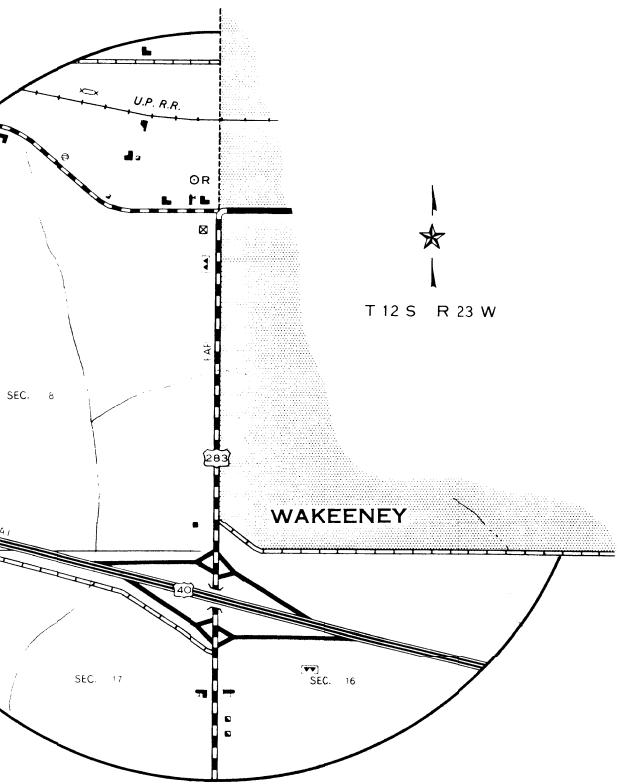
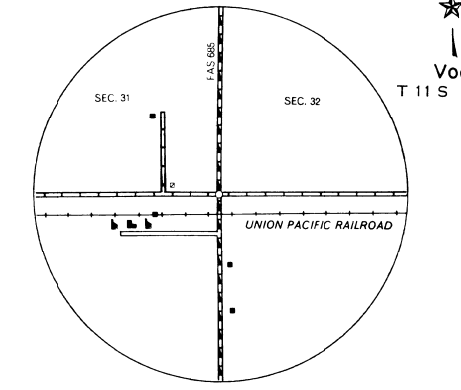
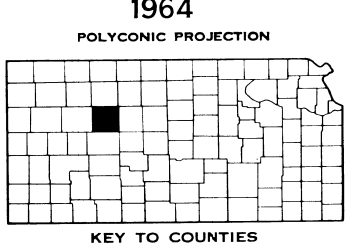
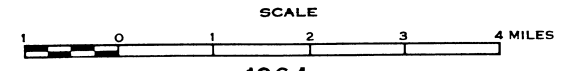

REVISIONS COMPLETED 2-28-64  
F. A. AND STATE  
SYSTEMS REVISED TO 2-7-64

HORIZONTAL CONTROL BASED ON  
U. S. COAST AND GEOD. SURVEY  
SYSTEMS REVISED TO 2-7-64