

LEGEND

<p>ROADS AND ROADWAY FEATURES</p> <p>PRIMITIVE ROAD TYPE #1</p> <p>UNIMPROVED ROAD TYPE #1</p> <p>GRADED AND DRAINED ROAD TYPE #1</p> <p>SOIL SURFACED ROAD TYPE #1</p> <p>GRAVEL OR STONE ROAD</p> <p>NOT GRADED OR DRAINED TYPE #1</p> <p>GRAVEL OR STONE ROAD</p> <p>GRADED AND DRAINED TYPE #1</p> <p>GRAVEL OR STONE ROAD WITH STABILIZED SURFACE TYPE #1</p> <p>BITUMINOUS ROAD-LOW TYPE TYPE #1</p> <p>PAVED ROAD TYPE #1</p> <p>DIVIDED HIGHWAY</p> <p>HIGHWAY WITH FULL CONTROL OF ACCESS</p> <p>SIDE ROADS AND STREETS IN UNINCORPORATED URBAN COMPACTS AND EXTENSIONS OF LOCAL ROADS WITHIN MUNICIPALITIES</p> <p>4 LANE UNDIVIDED HIGHWAY</p> <p>PRIVATE ROAD</p> <p>PROJECTED ROAD</p> <p>ROAD SYSTEM DESIGNATION</p> <p>FEDERAL-AID INTERSTATE HIGHWAY SYSTEM</p> <p>FEDERAL-AID PRIMARY HIGHWAY SYSTEM</p> <p>FEDERAL-AID SECONDARY HIGHWAY SYSTEM</p> <p>POINTS BETWEEN WHICH DISTANCES ARE MEASURED INDICATED THUS</p> <p>INTERSTATE NUMBERED HIGHWAY</p> <p>U.S. NUMBERED HIGHWAY</p> <p>STATE HIGHWAY SYSTEM OR STATE NUMBERED HIGHWAY</p> <p>TERMINUS OF DESIGNATED SYSTEM OR MARKED ROUTE</p> <p>RAILROADS</p> <p>RAILROAD</p> <p>RAILROAD</p> <p>RAILROAD</p> <p>NARROW GAUGE RAILROAD</p> <p>ELECTRIC INTERURBAN OR SUBURBAN RAILROAD</p> <p>RAILROAD</p> <p>ABANDONED RAILROAD</p> <p>ABANDONED ELECTRIC LINE (TRACK REMOVED)</p> <p>RAILROAD STATION</p> <p>RAILROAD CROSSINGS</p> <p>RAILROAD ABOVE</p> <p>RAILROAD BELOW</p> <p>RAILROAD BRIDGE</p> <p>AIRWAYS AND AIRPORTS</p> <p>AIR ROUTE</p> <p>MILITARY FIELD (WITH FACILITIES AVAILABLE)</p> <p>AIRPORT, COMPLETE FACILITIES (GENERAL OR NONFEDERAL)</p> <p>AIRFIELD, LIMITED FACILITIES</p> <p>LANDING AREA OR STRIP (INCLUDING PRIVATE AIR FIELDS)</p> <p>AIRWAY LIGHT BEACON, GENERAL</p> <p>AIRPORT, GENERAL</p> <p>NAVIGATION</p> <p>NAVIGABLE STREAM (AS INDICATED BY NAVIGATION)</p> <p>DRAINAGE</p> <p>INTERMITTENT STREAM</p> <p>PERMANENT STREAM</p> <p>NARROW STREAM</p> <p>WIDE STREAM</p> <p>DRAINAGE DITCH</p> <p>IRRIGATION DITCH</p> <p>LAKE, RESERVOIR, OR POND</p> <p>LAKE, RESERVOIR, OR POND WITH DAM</p> <p>DRY LAKE SUBJECT TO FLOOD</p> <p>MARSH OR SWAMP LAND</p> <p>OVERFLOW LAND</p> <p>STRUCTURES</p> <p>HIGHWAY BRIDGES, GENERAL</p> <p>SMALL BRIDGES CLOSELY SPACED</p> <p>BRIDGES FOR LONG RIVER CROSSINGS</p> <p>GENERAL</p> <p>ARCH</p> <p>TRUSS OR GIRDER (WOOD & STEEL)</p> <p>CANTILEVER BRIDGE</p> <p>COVERED BRIDGE</p> <p>HIGHWAY GRADE SEPARATION</p> <p>MISCELLANEOUS STRUCTURES</p> <p>DAM WITH ROAD</p> <p>LEVEE OR DIKE</p> <p>LEVEE OR DIKE WITH ROAD</p> <p>CONCRETE FORD OR DIP</p> <p>FORD-ROAD ESTABLISHED</p> <p>CATTLE GUARD</p> <p>GATE ACROSS ROAD</p> <p>BOUNDARIES</p> <p>STATE</p> <p>COUNTY</p> <p>CORPORATE LINES</p> <p>BOUNDARY LINES ESTABLISHED FOR DELIMITED URBAN PLACES</p> <p>SECTION LINE</p> <p>MATCH LINE BETWEEN ADJOINING SHEETS OF SAME COUNTY</p> <p>BOUNDARY TO MARK ENLARGEMENT INSET PARKS AND OTHER RESERVATIONS, NATIONAL, STATE, COUNTY, OR MUNICIPAL PARK</p> <p>INDIAN RESERVATION, NATIONAL MONUMENT, FEDERAL DEVELOPMENT PROJECT</p> <p>MONUMENT—SMALL HISTORIC SITE</p> <p>CITY AND VILLAGE CENTERS</p> <p>STATE CAPITAL</p> <p>COUNTY SEAT</p> <p>OTHER CITIES AND VILLAGES</p> <p>INCORPORATED CITY OR VILLAGE</p> <p>BOUNDARY LIMITS FIXED FOR SPECIAL TOWNING AREAS AND OTHER UNINCORPORATED URBAN PLACES DELIMITED</p>	<p>CONSERVATION AND RECREATION</p> <p>PICNIC GROUND</p> <p>PLAYGROUND, BALL FIELD, ETC.</p> <p>BATHING BEACH OR SWIMMING POOL</p> <p>SCENIC SITE</p> <p>CAMP SITE, NO PERMANENCE (TENTS OR TRAILER PARKING)</p> <p>TOURIST COURT OR MOTEL (DASHES INDICATE)</p> <p>CAMP OR LODGE (PERMANENT SITE WITH BUILDINGS)</p> <p>SMALL PARK (NON-INCORPORATED)</p> <p>FISH HATCHERY</p> <p>BIRD SANCTUARY</p> <p>GAME FARM</p> <p>GAME PRESERVE</p> <p>RIFLE CLUB</p> <p>GOLF GROUND OR COUNTRY CLUB</p> <p>RIDING ACADEMY</p> <p>YACHT CLUB</p> <p>AMUSEMENT PARK OR HALL</p> <p>FAIR GROUND, RACE COURSE, SPEEDWAY</p> <p>DIVERSION THEATRE</p> <p>FARM UNITS, DWELLINGS, ETC.</p> <p>FARM UNIT</p> <p>DWELLING (OTHER THAN RANCH)</p> <p>ROWS OR GROUPS OF DWELLINGS CLOSELY SPACED (FRAMES SHOW NUMBER OF DWELLINGS)</p> <p>COMBINED DWELLING AND STORE</p> <p>DWELLING AND POST OFFICE</p> <p>DWELLING AND FILLING STATION</p> <p>DWELLING, BUSINESS, AND FILLING STATION</p> <p>SEASONAL OR SUMMER COLONY DWELLING</p> <p>HOTEL, INN</p> <p>CHURCH OR OTHER RELIGIOUS INSTITUTION</p> <p>CHURCH AND SCHOOL (JOINT USE)</p> <p>CEMETERY</p> <p>CHURCH WITH CEMETERY ADJACENT</p> <p>FRESH AIR FARM OR REST HOME</p> <p>HOSPITAL</p> <p>WELL</p> <p>STATE PORT OF ENTRY OR WEIGHT STATION</p> <p>GROUP OF UNIMPROVED CULTURAL FEATURES CLOSELY SPACED (WITH NUMBER OF EACH INCLUDED IN SQUARE OF SYMBOL)</p> <p>INDUSTRIAL</p> <p>STORE OR SMALL BUSINESS ESTABLISHMENT</p> <p>BUSINESS AND POST OFFICE</p> <p>BUSINESS, FILLING STATION, AND POST OFFICE</p> <p>FACTORY OR INDUSTRIAL PLANT</p> <p>MINE-SHAFT OR DRIFT (ANY KIND)</p> <p>OIL OR GAS WELL</p> <p>OIL OR GAS FIELD</p> <p>OIL TANK</p> <p>GAS TANK</p> <p>GROUP OF STORAGE TANKS (OIL OR GAS)</p> <p>FILLING STATION (NOT CONNECTED TO OTHER BUSINESS)</p> <p>PUMPING STATION (OIL OR GAS)</p> <p>GAUGING OR PUMPING STATION (GENERAL)</p> <p>VALVE HOUSE</p> <p>SEASONAL INDUSTRY (CANNERY OR SMALL BREAD BAKERY)</p> <p>MILK DEPOT, CREAMERY OR CHEESE FACTORY</p> <p>FRUIT OR NUT ORCHARD</p> <p>FRUIT OR PRODUCE PACKING HOUSE</p> <p>ROAD STATION FARM PRODUCTS SALES</p> <p>WAREHOUSE—GENERAL (IF SEVERAL USES STATE OR U.S. GRAIN ELEVATOR)</p> <p>GROUP OF GRAIN STORAGE BINS</p> <p>GREENHOUSE</p> <p>NURSERY</p> <p>STOCK YARD—LOADING PEN OR CORRAL</p> <p>STOCK PEN AT RAILROAD SIDING (SMALL)</p> <p>GRAVEL PIT</p> <p>QUARRY</p> <p>KILN OR OVEN (LIME, CLAY PRODUCTS, ETC.)</p> <p>EDUCATIONAL AND CORRECTIONAL INSTITUTIONS</p> <p>SCHOOLHOUSE</p> <p>CONSOLIDATED OR LARGE SCHOOL</p> <p>TOWNSHIP, GRADE, OR COMMUNITY HALL</p> <p>AGRICULTURAL EXPERIMENT STATION</p> <p>COUNTY FARM</p> <p>CORRECTIONAL INSTITUTION</p> <p>PUBLIC SERVICE FACILITIES</p> <p>POST OFFICE</p> <p>HIGHWAY GARAGE</p> <p>FIRE ENGINE HOUSE</p> <p>GARBAGE OR RUBBISH DUMP</p> <p>SEWAGE DISPOSAL PLANT</p> <p>AUTO SALVAGE YARD</p> <p>TRANSFORMER STATION</p> <p>BOOSTER STATION</p> <p>POWER SUBSTATION</p> <p>WATER SUPPLY, STAND PIPE, OR TANK</p> <p>RADIO STATION (WITH CALL LETTERS)</p> <p>RADIO RANGE STATION</p> <p>US WEATHER STATION</p> <p>MISCELLANEOUS</p> <p>FORT, ARMY CAMP, BARRACKS, OR OTHER MILITARY POST</p> <p>TRIANGULATION STATION</p> <p>BENCH MARK (WITH ELEVATION)</p> <p>NATURAL FEATURES</p> <p>PROMINENT ELEVATION WITH NAME</p> <p>AND DATE</p> <p>SINK OR DEPRESSION</p>
--	---

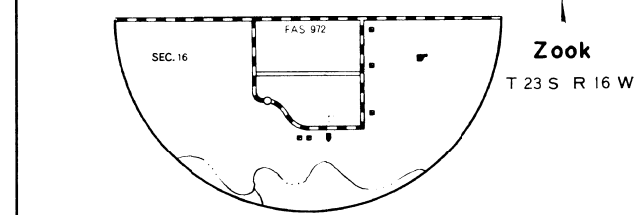
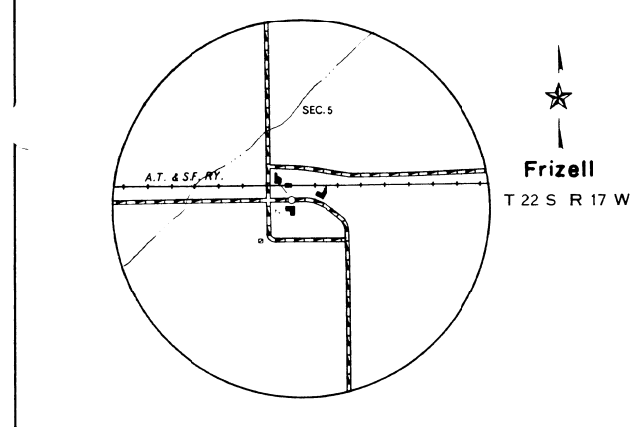
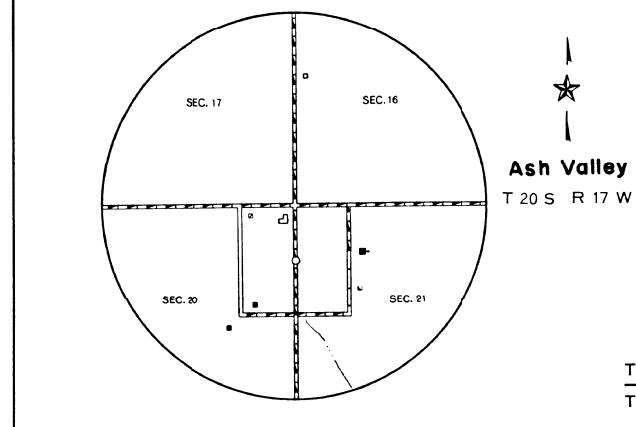

GENERAL HIGHWAY MAP PAWNEE COUNTY KANSAS

PREPARED BY THE
STATE HIGHWAY COMMISSION OF KANSAS
DEPARTMENT OF PLANNING AND DEVELOPMENT
IN COOPERATION WITH THE
U. S. DEPARTMENT OF TRANSPORTATION
FEDERAL HIGHWAY ADMINISTRATION

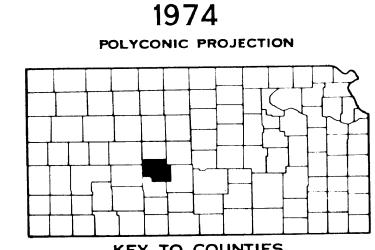
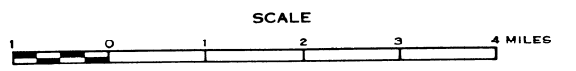

INVENTORY COMPLETED BY: [unclear]
AND DATE: [unclear]
SYSTEMS REVISED TO: [unclear]