

LEGEND

ROADS AND ROADWAY FEATURES		CONSERVATION AND RECREATION	
PRIMITIVE ROAD 1794 A1	PICNIC GROUND
UNIMPROVED ROAD 1794 B1	PLAYGROUNDS BALL FIELD, ETC.
GRADED AND DRAINED ROAD 1794 C1	BATHING BEACH OR SWIMMING POOL
SOIL SURFACED ROAD 1794 D1	SCENIC SITE
GRAVEL OR STONE ROAD	CAMP SITE - NO PERMANENCE (TRIP OR TRAIL MARKING)
NOT GRADED OR DRAINED 1794 E1	TOURIST COURT OR MOTEL
GRAVEL OR STONE ROAD	CAMP OR LODGE (PERMANENT SITE WITH BUILDINGS)
GRAVEL OR STONE ROAD WITH STABILIZED SURFACE 1794 F1	SMALL PARK
BITUMINOUS ROAD-LOW TYPE 1794 G1	FISH HATCHERY
PAVED ROAD 1794 H1	BIRD SANCTUARY
DIVIDED HIGHWAY	GAME FARM
HIGHWAY WITH FULL CONTROL OF ACCESS	GAME PRESERVE
SIDE ROADS AND STREETS IN UNINCORPORATED URBAN COMPACTS AND EXTENSIONS OF LOCAL ROADS WITHIN MUNICIPALITIES	RIFLE CLUB
4 LANE UNDIVIDED HIGHWAY	GOLF GROUND OR COUNTRY CLUB
PRIVATE ROAD	POLO GROUNDS
PROJECTED ROAD	RIDING ACADEMY
ROAD SYSTEM DESIGNATION		YACHT CLUB
FEDERAL AID INTERSTATE HIGHWAY SYSTEM	AMUSEMENT PARK OR HALL
FEDERAL AID PRIMARY HIGHWAY SYSTEM	FAIR GROUND, RACE COURSE, SPEEDWAY
FEDERAL AID SECONDARY HIGHWAY SYSTEM	DRIVE-IN THEATRE
POINTS BETWEEN WHICH DISTANCES ARE MEASURED INDICATED THUS	FARM UNITS, DWELLINGS, ETC.	
INTERSTATE NUMBERED HIGHWAY	FARM UNIT
STATE HIGHWAY SYSTEM OR STATE NUMBERED HIGHWAY	DWELLING (OTHER THAN FARM)
END OF DESIGNATED SYSTEM OR MARKED ROUTE	ROWS OR GROUPS OF DWELLINGS CLOSELY SPACED
RAILROADS		COMBINED DWELLING AND STORE
RAILROAD (ANY NUMBER OF TRACKS) 20 A	DWELLING AND FILLING STATION
RAILROAD IN JUNCTURE	DWELLING, BUSINESS, AND FILLING STATION
RAILROAD (ANY NUMBER OF TRACKS) 20 B	SEASONAL OR SUMMER COLONY DWELLING
NARROW GAUGE RAILROAD	HOTEL, INN
ELECTRIC INTERURBAN OR SUBURBAN RAILROAD	CHURCH OR OTHER RELIGIOUS INSTITUTION
ABANDONED RAILROAD (TRACKS REMOVED)	CHURCH AND SCHOOL
RAILROAD STATION	CHURCH WITH CEMETERY ADJACENT
RAILROAD CROSSINGS		FRESH AIR FARM OR REST HOME
RAILROAD ABOVE	HOSPITAL
RAILROAD BELOW	WELL
RAILROAD BRIDGE	STATE PORT OF ENTRY OR WEIGHT STATION
AIRWAYS AND AIRPORTS		GROUP OF MIXED CULTURAL FEATURES CLOSELY SPACED
AIR ROUTE	INDUSTRIAL	
MILITARY FIELD (LIGHT FACILITIES AVAILABLE)	STORE OR SMALL BUSINESS ESTABLISHMENT
AIRPORT, COMPLETE FACILITIES (COMMERCIAL OR MUNICIPAL)	BUSINESS AND POST OFFICE
AIRFIELD-LIMITED FACILITIES	BUSINESS, FILLING STATION, AND POST OFFICE
LANDING AREA OR STRIP (INCLUDING PRIVATE AIR FIELDS)	FACTORY OR INDUSTRIAL PLANT
AIRWAY LIGHT BEACON, GENERAL	MINE-SHAFT OR DRIFT (ANY KIND)
AIRPORT-GENERAL	OIL OR GAS WELL
NAVIGATION		OIL OR GAS FIELD
NAVIGABLE STREAM (WITH OR WITHOUT DAM)	OIL TANK
DRAINAGE		GAS TANK
INTERMITTENT STREAM (NARROW)	GROUP OF STORAGE TANKS (OIL OR GAS)
INTERMITTENT STREAM (WIDE)	FILLING STATION (NOT CONNECTED WITH OTHER BUSINESS)
NARROW STREAM	PUMPING STATION (OIL OR GAS)
WIDE STREAM	GAUGING OR PUMPING STATION (GENERAL)
DRAINAGE DITCH	VALVE HOUSE
IRRIGATION DITCH	SEASONAL INDUSTRY (CANNERY OR SMALL SCALE MILK)
LAKE, RESERVOIR, OR POND WITH DAM	MILK DEPOT, CREAMERY OR CHEESE FACTORY
DRY LAKE SUBJECT TO FLOOD	FRUIT OR NUT ORCHARD
OVERFLOW LAND	FRUIT OR PRODUCE PACKING HOUSE
STRUCTURES		ROAD STAND FARM PRODUCTS SALES
HIGHWAY BRIDGE, GENERAL	WAREHOUSE-GENERAL (IF ADJACENT ADD STATE OR U.S. HIGHWAY NUMBER)
TRUSS OR GIRDER (WOOD OR STEEL)	GRAIN ELEVATOR
CANTILEVER BRIDGE	GROUP OF GRAIN STORAGE BINS
COVERED BRIDGE	GREENHOUSE
HIGHWAY GRADE SEPARATION	NURSERY
MISCELLANEOUS STRUCTURES	STOCK YARD-LOADING PEN OR CORRAL
DAM WITH ROAD	STOCK PEN AT RAILROAD SIDING (SMALL)
LEVEE OR DIKE WITH ROAD	GRAVEL PIT
CONCRETE FORD OR DIP	QUARRY
FORD-ROAD ESTABLISHED	KILN OR OVEN (CLAY PRODUCTS, COKE, ETC.)
CATTLE GUARD	EDUCATIONAL AND CORRECTIONAL INSTITUTIONS	
GATE ACROSS ROAD (ANY TYPE)	SCHOOLHOUSE
BOUNDARIES		CANTILEVER BRIDGE
STATE	CONSOLIDATED OR LARGE SCHOOL
COUNTY	TOWNHALL, GRANGE, OR COMMUNITY HALL
BOUNDARY LINES ESTABLISHED FOR DELIMITED URBAN PLACES	AGRICULTURAL EXPERIMENT STATION
SECTION LINE	COUNTY FARM
MATCH LINE BETWEEN ADJOINING SHEETS OF SAME COUNTY	CORRECTIONAL INSTITUTION
BOUNDARY TO MARK ENLARGEMENT INSET, PARKS AND OTHER RESERVATIONS, NATIONAL, STATE, COUNTY, OR MUNICIPAL PARK, INDIAN RESERVATION, NATIONAL MONUMENT, FEDERAL DEVELOPMENT PROJECT, MONUMENT-SMALL HISTORIC SITE	PUBLIC SERVICE FACILITIES	
CITY AND VILLAGE CENTERS		POST OFFICE
STATE CAPITAL	HIGHWAY GARAGE
COUNTY SEAT	FIRE ENGINE HOUSE
OTHER CITIES AND VILLAGES	GARAGE OR RUBBISH DUMP
INCORPORATED CITY OR VILLAGE	SEWAGE DISPOSAL PLANT
BOUNDARY LIMITS FIXED FOR SPECIAL TAXING AREAS AND OTHER UNINCORPORATED URBAN PLACES DELIMITED	AUTO SALVAGE YARD
NATURAL FEATURES		TRANSFORMER STATION
PROMINENT ELEVATION WITH NAME	POWER SUBSTATION
TRIANGULATION STATION	BOOSTER STATION
BENCH MARK (WITH ELEVATION)	WATER SUPPLY, STAND PIPE, OR TANK
.....	RADIO STATION (WITH CALL LETTERS)
.....	RADIO RANGE STATION
.....	MISCELLANEOUS	
.....	FORT, ARMY CAMP, BARRACKS, OR OTHER
.....	MILITARY POST
.....

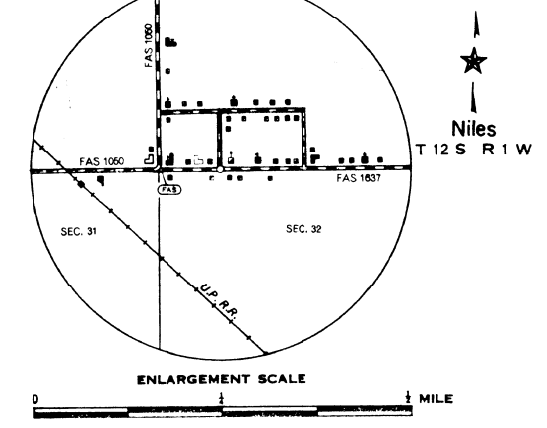
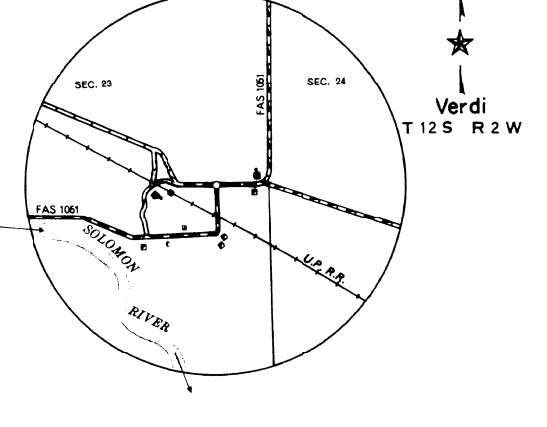
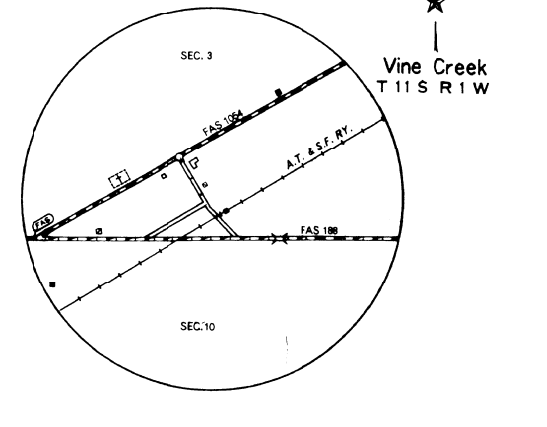
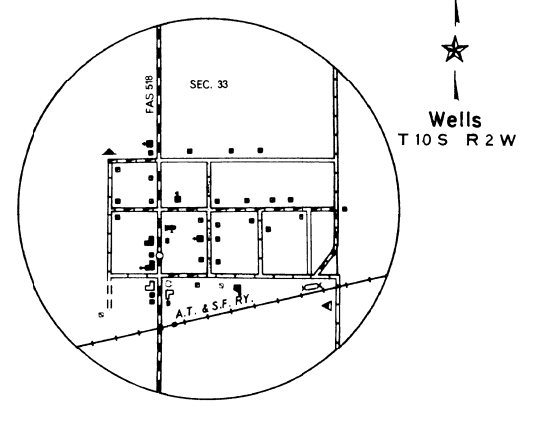
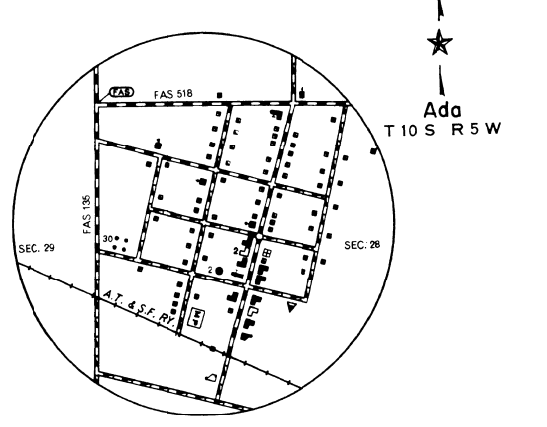
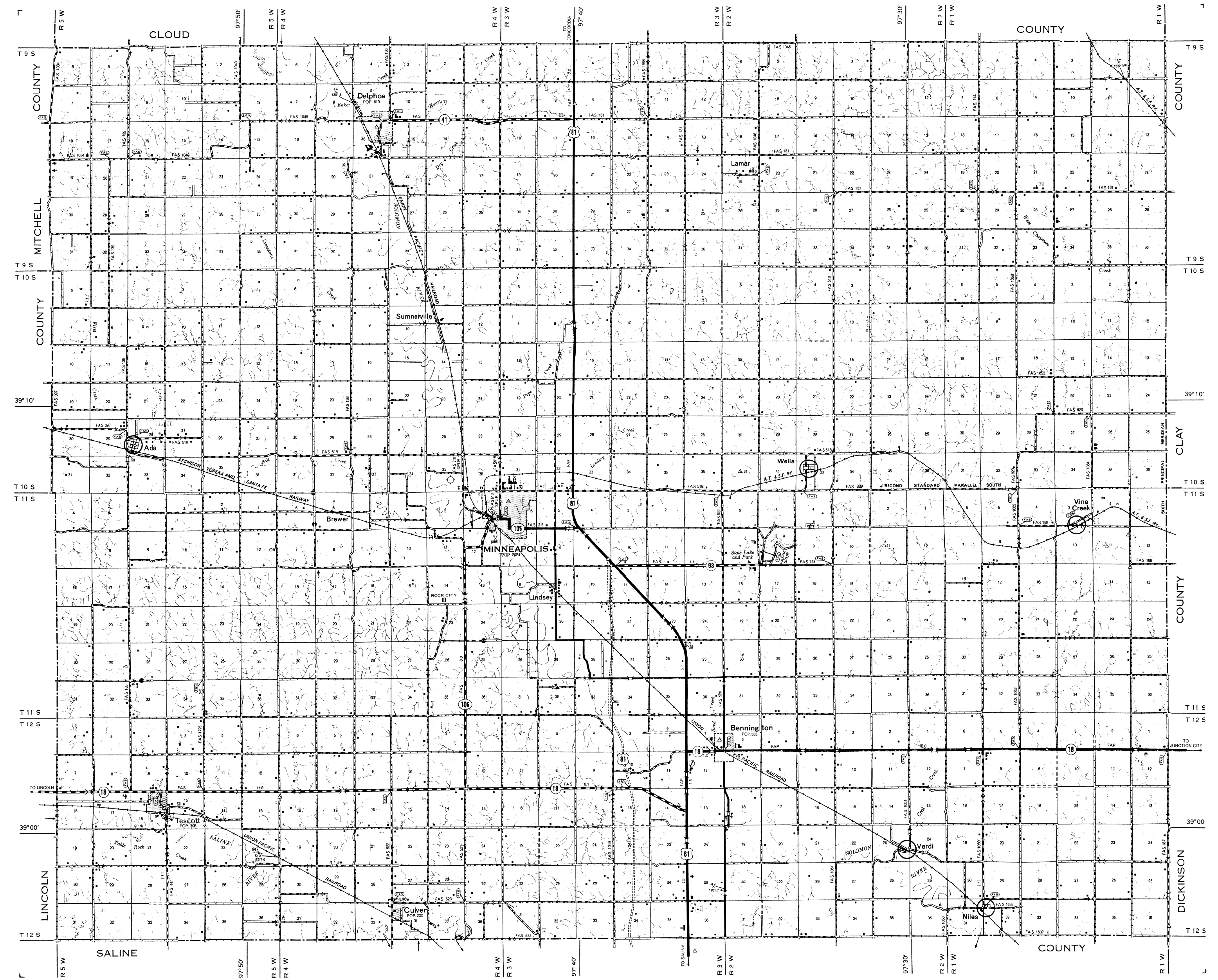

**GENERAL HIGHWAY MAP
OTTAWA COUNTY
KANSAS**

PREPARED BY THE
STATE HIGHWAY COMMISSION OF KANSAS
DEPARTMENT OF PLANNING AND DEVELOPMENT
IN COOPERATION WITH THE
U. S. DEPARTMENT OF TRANSPORTATION
FEDERAL HIGHWAY ADMINISTRATION
BUREAU OF PUBLIC ROADS

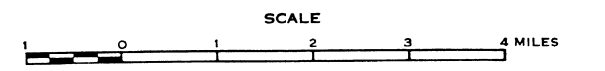

1968
POLYCONIC PROJECTION

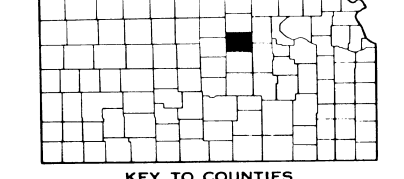

REVISIONS COMPLETED 11-30-66
F. AND STATE
SYSTEMS REVISED TO 8-3-68