

LEGEND

<p>ROADS AND ROADWAY FEATURES</p> <ul style="list-style-type: none"> PRIMITIVE ROAD (TYPE A) UNIMPROVED ROAD (TYPE B) GRADED AND DRAINED ROAD (TYPE C) SOIL SURFACED ROAD (TYPE D) GRAVEL OR STONE ROAD - NOT GRADED OR DRAINED (TYPE E) GRAVEL OR STONE ROAD - GRADED AND DRAINED (TYPE F) GRAVEL OR STONE ROAD WITH STABILIZED SURFACE (TYPE G) BITUMINOUS ROAD-LOW TYPE (TYPE H) PAVED ROAD (TYPE I) DIVIDED HIGHWAY HIGHWAY WITH FULL CONTROL OF ACCESS SIDE ROADS AND STREETS IN UNINCORPORATED URBAN COMPACTS AND EXTENSIONS OF LOCAL ROADS WITHIN MUNICIPALITIES 4 LANE UNDIVIDED HIGHWAY PRIVATE ROAD PROJECTED ROAD 	<p>RAILROADS</p> <ul style="list-style-type: none"> FEDERAL-AID INTERSTATE HIGHWAY SYSTEM FEDERAL-AID PRIMARY HIGHWAY SYSTEM FEDERAL-AID SECONDARY HIGHWAY SYSTEM POINTS BETWEEN WHICH DISTANCES ARE MEASURED INDICATED THUS INTERSTATE NUMBERED HIGHWAY U.S. NUMBERED HIGHWAY STATE HIGHWAY SYSTEM OR STATE NUMBERED HIGHWAY END OF DESIGNATED SYSTEM OR MARKED ROUTE 	<p>CONSERVATION AND RECREATION</p> <ul style="list-style-type: none"> PICNIC GROUND PLAYGROUND, BALL FIELD, ETC. BATHING BEACH OR SWIMMING POOL SCENIC SITE CAMP SITE - NO PERMANENCE (TENT OR TRAILER PARKING) TOURIST COURT OR MOTEL CAMP OR LODGE - PERMANENT SITE WITH BUILDINGS SMALL PARK FISH HATCHERY BIRD SANCTUARY GAME FARM GAME PRESERVE RIFLE CLUB GOLF GROUND OR COUNTRY CLUB POLO GROUNDS RIDING ACADEMY YACHT CLUB AMUSEMENT PARK OR HALL FAIR GROUND, RACE COURSE, BREWERY DRIVE-IN THEATRE
<p>ROAD SYSTEM DESIGNATION</p> <ul style="list-style-type: none"> FEDERAL-AID INTERSTATE HIGHWAY SYSTEM FEDERAL-AID PRIMARY HIGHWAY SYSTEM FEDERAL-AID SECONDARY HIGHWAY SYSTEM POINTS BETWEEN WHICH DISTANCES ARE MEASURED INDICATED THUS INTERSTATE NUMBERED HIGHWAY U.S. NUMBERED HIGHWAY STATE HIGHWAY SYSTEM OR STATE NUMBERED HIGHWAY END OF DESIGNATED SYSTEM OR MARKED ROUTE 	<p>RAILROADS</p> <ul style="list-style-type: none"> RAILROAD (NUMBER OF TRACKS INDICATED BY NUMBER OF SHORT DASHES) RAILROAD (NUMBER OF TRACKS INDICATED BY NUMBER OF LONG DASHES) NARROW GAUGE RAILROAD ELECTRIC INTERURBAN OR SUBURBAN RAILROAD ABANDONED RAILROAD (TRACK REMOVED) ABANDONED ELECTRIC LINE (TRACK REMOVED) RAILROAD STATION 	<p>FARM UNITS, DWELLINGS, ETC.</p> <ul style="list-style-type: none"> FARM UNIT DWELLING (OTHER THAN FARM) ROWS OR GROUPS OF DWELLINGS CLOSELY SPACED (FIGURE INDICATES NUMBER OF DWELLINGS) COMBINED DWELLING AND STORE DWELLING AND POST OFFICE DWELLING AND FILLING STATION DWELLING, BUSINESS, AND FILLING STATION TENANT HOUSE SEASONAL OR SUMMER COLONY DWELLING HOTEL, INN CHURCH OR OTHER RELIGIOUS INSTITUTION CHURCH AND SCHOOL (HINT USE) CEMETERY CHURCH WITH GENESEEY ADJACENT FRESH AIR FARM OR REST HOME HOSPITAL STATE PORT OF ENTRY OR WEIGHT STATION GROUP OF MIXED CULTURAL FEATURES CLOSELY SPACED (FIGURE INDICATES NUMBER OF EACH INCLUDED REGARDLESS OF DISTANCE)
<p>AIRWAYS AND AIRPORTS</p> <ul style="list-style-type: none"> AIR ROUTE MILITARY FIELD (SEEN FACILITIES AVAILABLE) AIRPORT COMPLETE FACILITIES (GENERAL OR NON-MILITARY) AIRFIELD, LIMITED FACILITIES LANDING AREA OR STRIP AIRWAY LIGHT BEACON - GENERAL AIRPORT - GENERAL 	<p>RAILROAD CROSSINGS</p> <ul style="list-style-type: none"> RAILROAD CROSSING RAILROAD ABOVE RAILROAD BELOW RAILROAD BRIDGE 	<p>INDUSTRIAL</p> <ul style="list-style-type: none"> STORE OR SMALL BUSINESS ESTABLISHMENT BUSINESS AND POST OFFICE BUSINESS AND FILLING STATION BUSINESS, FILLING STATION, AND POST OFFICE FACTORY OR INDUSTRIAL PLANT MINE-SHAFT OR DRIFT (ANY KIND) OIL OR GAS WELL OIL OR GAS FIELD OIL TANK GAS TANK GROUP OF STORAGE TANKS (ON OR NEAR FILLING STATION - NOT CONNECTED WITH OTHER BUSINESS) PUMPING STATION (ON OR NEAR CAULDRON OR PUMPING STATION - GENERAL) VALVE HOUSE SEASONAL INDUSTRY (BARNYARD OR SMALL MEAT WELL) MILK DEPOT, CREAMERY OR CHEESE FACTORY FRUIT OR NUT ORCHARD ROAD STAND FARM PRODUCTS SALES WAREHOUSE - GENERAL (OF GOVERNMENT AND STATE OR U.S.) GRAIN ELEVATOR GROUP OF GRAIN STORAGE BINS GREENHOUSE NURSERY STOCK YARD - LOADING PEN OR CORRAL STOCK PEN AT RAILROAD SIDING GRAVEL PIT QUARRY MILK OR OVEN LINE (ON OR NEAR BUSINESS)
<p>NAVIGATION</p> <ul style="list-style-type: none"> NAVIGABLE STREAM (NOT INTERMITTENT NAVIGATION) INTERMITTENT STREAM INTERMITTENT STREAM (GENERAL) NARROW STREAM WIDE STREAM DRAINAGE DITCH IRRIGATION DITCH LAKE, RESERVOIR, OR POND LAKE, RESERVOIR, OR POND WITH DAM DRY LAKE SUBJECT TO FLOOD MARSH OR SWAMP LAND OVERFLOW LAND 	<p>DRAINAGE</p> <ul style="list-style-type: none"> INTERMITTENT STREAM INTERMITTENT STREAM (GENERAL) NARROW STREAM WIDE STREAM DRAINAGE DITCH IRRIGATION DITCH LAKE, RESERVOIR, OR POND LAKE, RESERVOIR, OR POND WITH DAM DRY LAKE SUBJECT TO FLOOD MARSH OR SWAMP LAND OVERFLOW LAND 	<p>EDUCATIONAL AND CORRECTIONAL INSTITUTIONS</p> <ul style="list-style-type: none"> SCHOOLHOUSE CONSOLIDATED OR LARGE SCHOOL TOWNSHIP, GRANGE, OR COMMUNITY HALL AGRICULTURAL EXPERIMENT STATION COUNTY FARM CORRECTIONAL INSTITUTION
<p>STRUCTURES</p> <ul style="list-style-type: none"> HIGHWAY BRIDGE, GENERAL SMALL BRIDGES CLOSELY SPACED BRIDGES FOR LONG RIVER CROSSINGS GENERAL ARCH TRUSS OR GIRDER (WOOD & STEEL) CANTILEVER BRIDGE COVERED BRIDGE HIGHWAY GRADE SEPARATION MISCELLANEOUS STRUCTURES DAM WITH ROAD LEVEE OR DIKE LEVEE OR DIKE WITH ROAD CONCRETE FORD OR DIP FORD-ROAD ESTABLISHED CATTLE GUARD GATE ACROSS ROAD (ANY TYPE) 	<p>BOUNDARIES</p> <ul style="list-style-type: none"> STATE COUNTY CORPORATE LINES BOUNDARY LINES ESTABLISHED FOR DELIMITED URBAN PLACES SECTION LINE MATCH LINE BETWEEN ADJOINING SHEETS OF SAME COUNTY BOUNDARY TO MARK ENLARGEMENT INSET PARKS AND OTHER RESERVATIONS NATIONAL STATE COUNTY OR MUNICIPAL PARK INDIAN RESERVATION, NATIONAL MONUMENT, FEDERAL DEVELOPMENT PROJECT MONUMENT - SMALL HISTORIC SITE 	<p>PUBLIC SERVICE FACILITIES</p> <ul style="list-style-type: none"> POST OFFICE HIGHWAY GARAGE FIRE ENGINE HOUSE GARAGE OR RUBBISH DUMP SEWAGE DISPOSAL PLANT AUTO SALVAGE YARD TRANSFORMER STATION POWER PLANT BOOSTER STATION WATER SUPPLY, STAND PIPE, OR TANK RADIO STATION - CALL LETTERS RADIO RANGE STATION
<p>CITY AND VILLAGE CENTERS</p> <ul style="list-style-type: none"> STATE CAPITAL COUNTY SEAT OTHER CITIES AND VILLAGES INCORPORATED CITY OR VILLAGE BOUNDARY LIMITS FIXED FOR SPECIAL TAXING AREAS AND OTHER UNINCORPORATED URBAN PLACES DELIMITED 	<p>MISCELLANEOUS</p> <ul style="list-style-type: none"> FORT, ARMY CAMP, BARRACKS, OR OTHER MILITARY POST TRIANGULATION STATION BENCH MARK (WITH ELEVATION) 	<p>NATURAL FEATURES</p> <ul style="list-style-type: none"> PROMINENT ELEVATIONS WITH NAMES SINK OR DEPRESSION

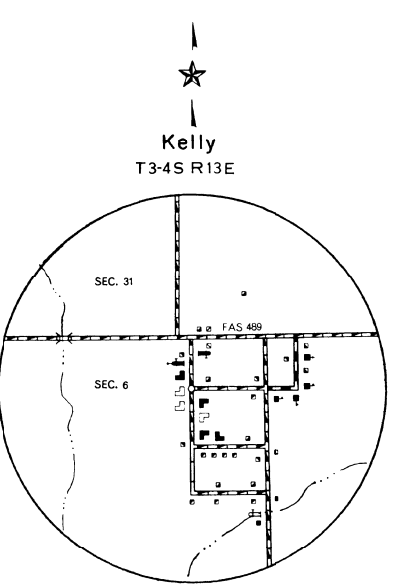
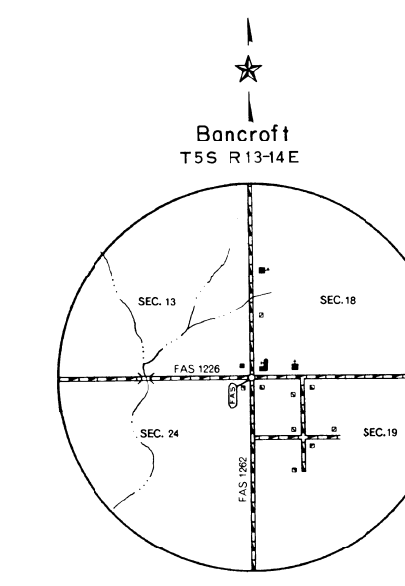
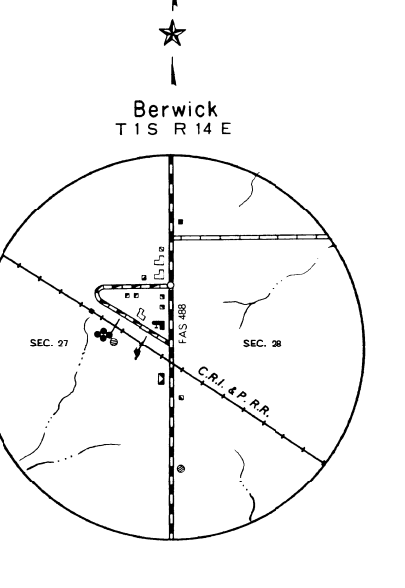
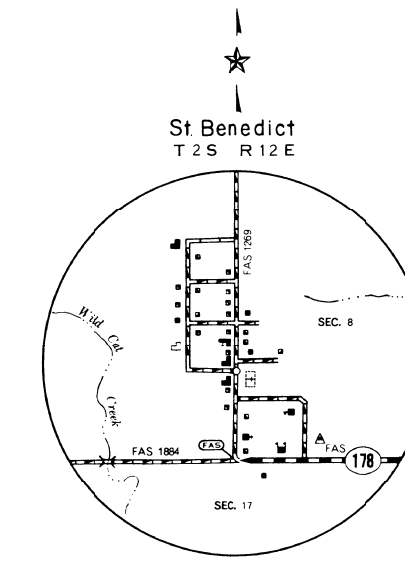
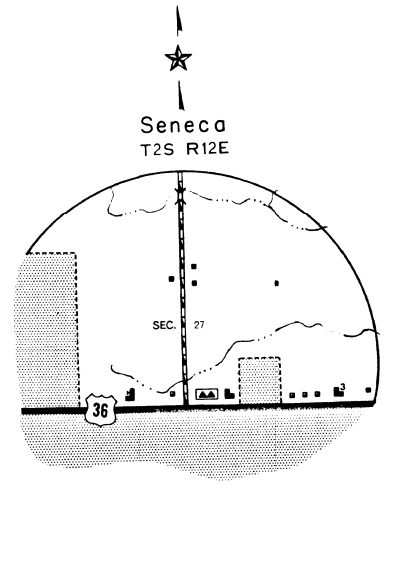
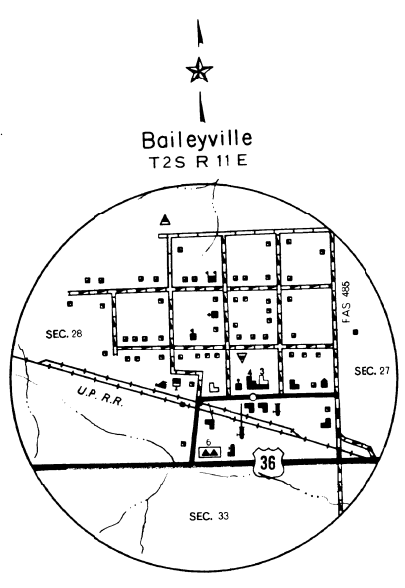

GENERAL HIGHWAY MAP NEMAHA COUNTY KANSAS

PREPARED BY THE
STATE HIGHWAY COMMISSION OF KANSAS
PLANNING AND RESEARCH DEPARTMENT
IN COOPERATION WITH THE
U. S. DEPARTMENT OF COMMERCE
BUREAU OF PUBLIC ROADS

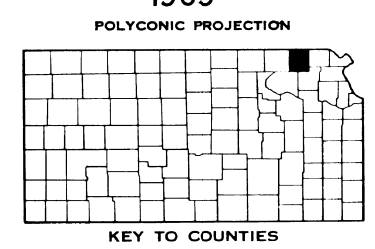
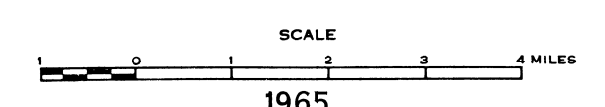

REINVENTURY COMPLETED 8-1-55
F.A. AND STATE
SYSTEM REVISED TO 8-18-55