

Solomon Rapids
T7S R8W

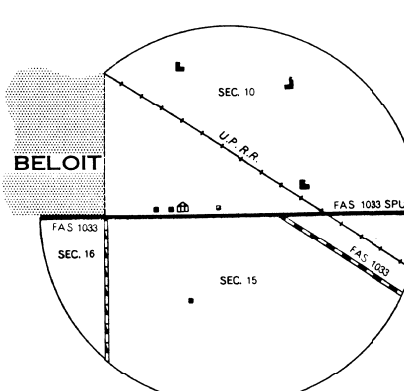

BELOIT
T7S R7W

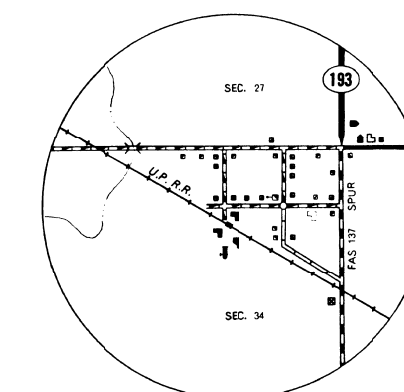

Asherville
T7S R6W



LEGEND

<p>ROADS AND ROADWAY FEATURES</p> <p>PRIMITIVE ROAD (TYPE 1) UNIMPROVED ROAD (TYPE 2) GRADED AND DRAINED ROAD (TYPE 3) SOIL SURFACED ROAD (TYPE 4) GRAVEL OR STONE ROAD - NOT GRADED OR DRAINED (TYPE 5) GRAVEL OR STONE ROAD - GRADED AND DRAINED (TYPE 6) STABILIZED SURFACE (TYPE 7) BITUMINOUS ROAD-LOW TYPE (TYPE 8) PAVED ROAD (TYPE 9) DIVIDED HIGHWAY HIGHWAY WITH FULL CONTROL OF ACCESS SIDE ROADS AND STREETS IN UNINCORPORATED URBAN COMPACTS AND EXTENSIONS OF LOCAL ROADS WITHIN MUNICIPALITIES 4 LANE UNDIVIDED HIGHWAY PRIVATE ROAD PROJECTED ROAD</p> <p>ROAD SYSTEM DESIGNATION</p> <p>FEDERAL-AID INTERSTATE HIGHWAY SYSTEM FEDERAL-AID PRIMARY HIGHWAY SYSTEM FEDERAL-AID SECONDARY HIGHWAY SYSTEM INTERSTATE NUMBERED HIGHWAY U.S. NUMBERED HIGHWAY STATE NUMBERED HIGHWAY END OF DESIGNATED SYSTEM OR MARKED ROUTE</p> <p>RAILROADS</p> <p>RAILROAD (TYPE 1) RAILROADS IN JUNCTURE NARROW GAUGE RAILROAD OR SUBURBAN RAILROAD ABANDONED RAILROAD (TYPE 2) RAILROAD STATION RAILROAD CROSSING GRADE CROSSING RAILROAD ABOVE RAILROAD BELOW RAILROAD BRIDGE AIR ROUTE MILITARY FIELD (TYPE 1) AIRPORT - COMPLETE FACILITIES (TYPE 2) AIRFIELD - LIMITED FACILITIES LANDING AREA OR STRIP (TYPE 3) AIRWAY LIGHT BEACON - GENERAL AIRPORT - GENERAL NAVIGABLE STREAM (TYPE 1) INTERMITTENT STREAM INTERMITTENT STREAM NARROW STREAM WIDE STREAM DRAINAGE DITCH LAKE, RESERVOIR, OR POND LAKE, RESERVOIR, OR POND WITH DAM DRY LAKE SUBJECT TO FLOOD MARSH OR SWAMP LAND OVERFLOW LAND</p> <p>STRUCTURES</p> <p>HIGHWAY BRIDGE - GENERAL SMALL BRIDGES CLOSELY SPACED BRIDGES FOR LONG RIVER CROSSINGS GENERAL TRUSS OR GIRDER CANTILEVER BRIDGE COVERED BRIDGE HIGHWAY GRADE SEPARATION DAM WITH ROAD LEVEE OR DIKE WITH ROAD CONCRETE FORD OR DIP FORD-ROAD ESTABLISHED CATTLE GUARD GATE ACROSS ROAD</p> <p>BOUNDARIES</p> <p>STATE COUNTY CORPORATE LINES BOUNDARY LINES ESTABLISHED FOR DELIMITED URBAN PLACES SECTION LINE MATCH LINE BETWEEN ADJOINING SHEETS OF SAME COUNTY BOUNDARY TO MARK ENLARGEMENT INSET PARKS AND OTHER RESERVATIONS NATIONAL, STATE, COUNTY, OR MUNICIPAL PARK INDIAN RESERVATION NATIONAL MONUMENT FEDERAL DEVELOPMENT PROJECT MONUMENT - SMALL HISTORIC SITE</p> <p>CITY AND VILLAGE CENTERS</p> <p>STATE CAPITAL COUNTY SEAT OTHER CITIES AND VILLAGES INCORPORATED CITY OR VILLAGE BOUNDARY LIMITS FIXED FOR SPECIAL TAXING AREAS AND OTHER UNINCORPORATED URBAN PLACES DELIMITED</p>	<p>CONSERVATION AND RECREATION</p> <p>PICNIC GROUND PLAYGROUND, BALL FIELD, ETC. BATHING BEACH OR SWIMMING POOL SCENIC SITE CAMP SITE, NO PERMANENCE (TYPE 1) CAMP OR LODGE WITH BUILDINGS SMALL PARK FISH HATCHERY BIRD SANCTUARY GAME FARM GAME PRESERVE RIFLE CLUB GOLF GROUND OR COUNTRY CLUB POLIO GROUND RIDING ACADEMY YACHT CLUB AMUSEMENT PARK OR HALL FAIR GROUND, RACE COURSE, SPEEDWAY DRIVE-IN THEATRE</p> <p>FARM UNITS, DWELLINGS, ETC.</p> <p>FARM UNIT DWELLING OTHER THAN FARM ROWS OR GROUPS OF DWELLINGS CLOSELY SPACED COMBINED DWELLING AND STORE DWELLING AND POST OFFICE DWELLING AND FILLING STATION DWELLING, BUSINESS, AND FILLING STATION TENANT HOUSE SEASONAL OR SUMMER COLONY DWELLING HOTEL, INN CHURCH OR OTHER RELIGIOUS INSTITUTION CHURCH AND SCHOOL CEMETERY CHURCH WITH CEMETERY ADJACENT FRESH AIR FARM OR REST HOME HOSPITAL WELL PORT OF ENTRY OR WEIGHT STATION GROUP OF MIXED CULTURAL FEATURES CLOSELY SPACED HIGH SCHOOL INDUSTRIAL</p> <p>STORE OR SMALL BUSINESS ESTABLISHMENT BUSINESS AND POST OFFICE BUSINESS FILLING STATION, AND POST OFFICE FACTORY OR INDUSTRIAL PLANT MINE-SHAFT OIL OR GAS WELL OIL OR GAS FIELD OIL TANK GAS TANK GROUP OF STORAGE TANKS (OIL OR GAS) FILLING STATION (NOT CONNECTED WITH BUSINESS) PUMPING STATION (OIL OR GAS) GAUGING OR PUMPING STATION - GENERAL VALVE HOUSE SEASONAL INDUSTRY (CANNERY OR SMALL DRY MILL) MILK DEPOT, CREAMERY OR CHEESE FACTORY FRUIT OR NUT GARDEN FRUIT OR PRODUCE PACKING HOUSE ROAD STAND FARM PRODUCTS SALES WAREHOUSE - GENERAL, IF SHEDDING AND STATE OR U.S. GRAIN ELEVATOR GROUP OF GRAN OR STORAGE BINS GREENHOUSE NURSERY STOCK YARD - LOADING PEN OR CORRAL STOCK PEN AT RAILROAD SIDING GRAVEL PIT QUARRY KILN OR OVEN (LIME, CLAY PRODUCTS, ETC.)</p> <p>EDUCATIONAL AND CORRECTIONAL INSTITUTIONS</p> <p>SCHOOLHOUSE CONSOLIDATED OR LARGE SCHOOL TOWNSHIP, GRADING, OR COMMUNITY HALL AGRICULTURAL EXPERIMENT STATION COUNTY FARM CORRECTIONAL INSTITUTION</p> <p>PUBLIC SERVICE FACILITIES</p> <p>POST OFFICE HIGHWAY GARAGE FIRE ENGINE HOUSE GARAGE OR RUBBISH DUMP SEWAGE DISPOSAL PLANT AUTO SALVAGE YARD TRANSFORMER STATION CROSSLING POWER SUBSTATION BOOSTER STATION WATER SUPPLY, STANDPIPE, OR TANK RADIO STATION (WITH CALL LETTERS) RADIO RANGE STATION US WEATHER STATION</p> <p>MISCELLANEOUS</p> <p>FORT, ARMY CAMP, BARRACKS, OR OTHER MILITARY POST TRIANGULATION STATION BENCH MARK (WITH ELEVATION)</p> <p>NATURAL FEATURES</p> <p>PROMINENT ELEVATION WITH NAME SINK OR DEPRESSION</p>
---	--

GENERAL HIGHWAY MAP MITCHELL COUNTY KANSAS

PREPARED BY THE
STATE HIGHWAY COMMISSION OF KANSAS
DEPARTMENT OF PLANNING AND DEVELOPMENT
IN COOPERATION WITH THE
U. S. DEPARTMENT OF TRANSPORTATION
FEDERAL HIGHWAY ADMINISTRATION

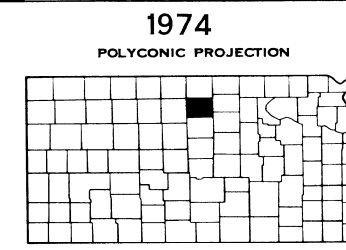
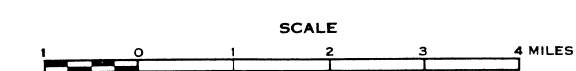

KEY TO COUNTIES

REVISIONS COMPLETED 8-19-38
 F. A. AND STATE
 SYSTEMS REVISED TO 1-2-38