

LEGEND

- ROADS AND ROADWAY FEATURES**
 - PRIMITIVE ROAD (TYPE A)
 - UNIMPROVED ROAD (TYPE B)
 - GRADED AND DRAINED ROAD (TYPE C)
 - SOIL SURFACED ROAD (TYPE D)
 - GRAVEL OR STONE ROAD - NOT GRADED OR DRAINED (TYPE E)
 - GRAVEL OR STONE ROAD - GRADED AND DRAINED (TYPE F)
 - GRAVEL OR STONE ROAD WITH STABILIZED SURFACE (TYPE G)
 - BITUMINOUS ROAD - LOW TYPE (TYPE H)
 - PAVED ROAD (TYPE I)
 - HIGHWAY WITH FULL CONTROL OF ACCESS
 - SIDE ROADS AND STREETS IN UNINCORPORATED URBAN COMPACTS AND EXTENSIONS OF LOCAL ROADS WITHIN MUNICIPALITIES
 - 4 LANE UNDIVIDED HIGHWAY
 - PRIVATE ROAD
 - PROJECTED ROAD
- ROAD SYSTEM DESIGNATION**
 - FEDERAL-AID INTERSTATE HIGHWAY SYSTEM
 - FEDERAL-AID PRIMARY HIGHWAY SYSTEM
 - FEDERAL-AID SECONDARY HIGHWAY SYSTEM
 - POINTS BETWEEN WHICH DISTANCES ARE MEASURED INDICATED THUS
 - INTERSTATE NUMBERED HIGHWAY
 - U S NUMBERED HIGHWAY
 - STATE HIGHWAY SYSTEM OR STATE NUMBERED HIGHWAY
 - END OF DESIGNATED SYSTEM OR MARKED ROUTE
- RAILROADS**
 - RAILROAD (TYPE A)
 - RAILROADS IN JUNCTURE POSITION
 - NARROW GAUGE RAILROAD
 - ELECTRIC INTERURBAN OR SUBURBAN RAILROAD
 - ABANDONED RAILROAD (TRACK REMOVED)
 - ABANDONED ELECTRIC LINE (TRACK REMOVED)
 - RAILROAD STATION
- RAILROAD CROSSINGS**
 - GRADE CROSSING
 - RAILROAD ABOVE
 - RAILROAD BELOW
 - RAILROAD BRIDGE
- AIRWAYS AND AIRPORTS**
 - AIR ROUTE
 - MILITARY FIELD (GENERAL OR LIMITED FACILITIES)
 - AIRPORT - COMPLETE FACILITIES (COMMERCIAL OR MUNICIPAL)
 - AIRFIELD - LIMITED FACILITIES
 - LANDING AREA OR STRIP (INCLUDING PRIVATE AIR FIELDS)
 - AIRWAY LIGHT BEACON - GENERAL
 - AIRPORT - GENERAL
- NAVIGATION**
 - NAVIGABLE STREAM (NOT CONNECTED WITH OTHER SUBSYSTEMS)
 - FILLING STATION (NOT CONNECTED WITH OTHER SUBSYSTEMS)
 - PUMPING STATION (ON OR OFF)
 - GAUGING OR PUMPING STATION (GENERAL)
 - VALVE HOUSE
 - SEASONAL INDUSTRY (CANNERY OR SMALL DRAIN MILK MILK BENT; CREAMERY OR CHEESE FACTORY)
 - FRUIT OR NUT ORCHARD
 - FRUIT OR PRODUCE PACKING HOUSE
 - ROAD STAND FARM PRODUCTS SALES
 - WAREHOUSE - GENERAL (IF STORAGE AND SHED OR YARD)
 - GRAIN ELEVATOR
 - GROUP OF GRAIN STORAGE BINS
 - GREENHOUSE
- DRAINAGE**
 - INTERMITTENT STREAM (GENERAL)
 - INTERMITTENT STREAM (WOOD)
 - NARROW STREAM
 - WIDE STREAM
 - DRAINAGE DITCH
 - IRRIGATION DITCH
 - LAKE, RESERVOIR, OR POND
 - LAKE, RESERVOIR, OR POND WITH DAM
 - DRY LAKE SUBJECT TO FLOOD
 - MARSH OR SWAMP LAND
 - OVERFLOW LAND
- STRUCTURES**
 - HIGHWAY BRIDGES
 - RAILROAD BRIDGE
 - SMALL BRIDGES CLOSELY SPACED
 - BRIDGES FOR LONG RIVER CROSSINGS
 - GENERAL
 - ARCH
 - TRUSS OR GIRDER
 - CANTILEVER BRIDGE
 - COVERED BRIDGE
 - HIGHWAY GRADE SEPARATION
 - MISCELLANEOUS STRUCTURES
 - DAM WITH ROAD
 - LEVEE OR DIKE WITH ROAD
 - CONCRETE POND OR DIP
 - FORD - ROAD ESTABLISHED
 - CATTLE GUARD
 - GATE ACROSS ROAD (ANY TYPE)
- BOUNDARIES**
 - STATE
 - COUNTY
 - CORPORATE LINES
 - BOUNDARY LINES ESTABLISHED FOR UNINCORPORATED URBAN PLACES
 - DELIMITED URBAN PLACES
 - SECTION LINE
 - MATCH LINE BETWEEN ADJOINING SHEETS OF SAME COUNTY
 - BOUNDARY TO MARK ENLARGEMENT INSET
 - PARKS AND OTHER RESERVATIONS NATIONAL
 - STATE COUNTY OR MUNICIPAL PARK
 - INDIAN RESERVATION NATIONAL MONUMENT - SMALL HISTORIC SITE
 - CITY AND VILLAGE CENTERS
 - STATE CAPITAL
 - COUNTY SEAT
 - OTHER CITIES AND VILLAGES
 - INCORPORATED CITY OR VILLAGE
 - BOUNDARY LIMITS FIXED FOR SPECIAL TAXING AREAS AND OTHER UNINCORPORATED URBAN PLACES DELIMITED
- CONSERVATION AND RECREATION**
 - PICNIC GROUND
 - PLAYGROUND, BALL FIELD, ETC.
 - BATHING BEACH OR SWIMMING POOL
 - SCENIC SITE
 - CAMP SITE, NO PERMANENCE (TENTS OR TRAILER PARKING)
 - TOURIST SQUAT OR MOTEL
 - CAMP OR LODGE (PERMANENT SITE WITH BUILDINGS)
 - SMALL PARK
 - FISH HATCHERY
 - BIRD SANCTUARY
 - GAME FARM
 - GAME PRESERVE
 - RIFLE CLUB
 - GOLF COURSE OR COUNTRY CLUB
 - POLO GROUNDS
 - RIDING ACADEMY
 - YACHT CLUB
 - AMUSEMENT PARK OR HALL
 - FAIR GROUND, RACE COURSE, SPEEDWAY
 - DRIVE-IN THEATRE
- FARM UNITS, DWELLINGS, ETC.**
 - FARM UNIT
 - DWELLING (OTHER THAN FARM)
 - ROWS OR GROUPS OF DWELLINGS CLOSELY SPACED (RESIDE DENOTES NUMBER OF DWELLINGS)
 - COMBINED DWELLING AND STORE
 - DWELLING AND POST OFFICE
 - DWELLING AND FILLING STATION
 - DWELLING AND FILLING STATION
 - TEENY HOUSE
 - SEASONAL OR SUMMER COLONY DWELLING
 - HOTEL, INN
 - CHURCH OR OTHER RELIGIOUS INSTITUTION
 - CHURCH AND SCHOOL (MOUNT USE)
 - CEMETERY
 - CHURCH WITH CEMETERY ADJACENT
 - FRESH AIR FARM OR REST HOME
 - HOSPITAL
 - WELL
 - STATE PORT OF ENTRY OR WEIGHT STATION
 - GROUP OF MIXED CULTURAL FEATURES CLOSELY SPACED (INCLUDES ALL TYPES OF CULTURAL FEATURES EXCEPT PUBLIC SQUARES)
- INDUSTRIAL**
 - STORE OR SMALL BUSINESS ESTABLISHMENT
 - BUSINESS AND FILING STATION
 - BUSINESS, FILING STATION, AND POST OFFICE
 - FACTORY OR INDUSTRIAL PLANT
 - MINE-SHAFT OR DRIFT (ANY KIND)
 - OIL OR GAS WELL
 - OIL OR GAS FIELD
 - DIL TANK
 - GAS TANK
 - GROUP OF STORAGE TANKS (ON OR OFF)
 - FILLING STATION (NOT CONNECTED WITH OTHER SUBSYSTEMS)
 - PUMPING STATION (ON OR OFF)
 - GAUGING OR PUMPING STATION (GENERAL)
 - VALVE HOUSE
 - SEASONAL INDUSTRY (CANNERY OR SMALL DRAIN MILK MILK BENT; CREAMERY OR CHEESE FACTORY)
 - FRUIT OR NUT ORCHARD
 - FRUIT OR PRODUCE PACKING HOUSE
 - ROAD STAND FARM PRODUCTS SALES
 - WAREHOUSE - GENERAL (IF STORAGE AND SHED OR YARD)
 - GRAIN ELEVATOR
 - GROUP OF GRAIN STORAGE BINS
 - GREENHOUSE
 - NURSERY
 - STOCK YARD - LOADING PEN OR CORRAL
 - STOCK PEN AT RAILROAD SIDING (SMALL)
 - GRAVEL PIT
 - QUARRY
 - KILN OR OVEN (CLAY, BRICK, CEMENT, ETC.)
- EDUCATIONAL AND CORRECTIONAL INSTITUTIONS**
 - SCHOOLHOUSE
 - CONSOLIDATED OR LARGE SCHOOL
 - TOWN HALL, GRANGE, OR COMMUNITY HALL
 - AGRICULTURAL EXPERIMENT STATION
 - COUNTY FARM
 - CORRECTIONAL INSTITUTION
- PUBLIC SERVICE FACILITIES**
 - POST OFFICE
 - HIGHWAY GARAGE
 - FIRE ENGINE HOUSE
 - GARBAGE OR RUBBISH DUMP
 - SEWAGE DISPOSAL PLANT
 - AUTO SALVAGE YARD
 - TRANSFORMER STATION
 - POWER PLANT
 - POWER SUBSTATION
 - BOILER STATION
 - WATER SUPPLY, STAND PIPE, OR TANK
 - RADIO STATION (WITH CALL LETTERS)
 - RADIO RANGE STATION
- MISCELLANEOUS**
 - FORT, ARMY CAMP, BARRACKS, OR OTHER MILITARY POST
 - TRIANGULATION STATION
 - BEACH MARK (WITH ELEVATION)
- NATURAL FEATURES**
 - PROMINENT ELEVATION - WITH NAME
 - WATER COURSE (WITH ELEVATION)
 - SINK OR DEPRESSION

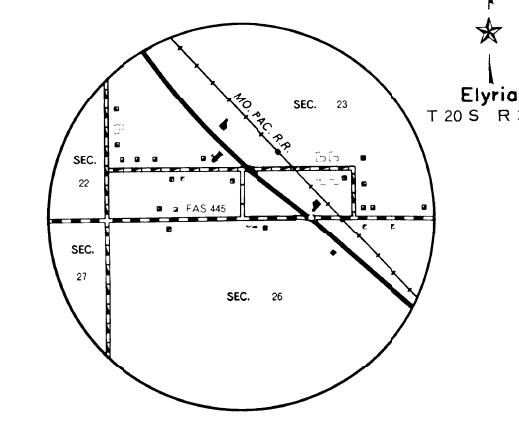
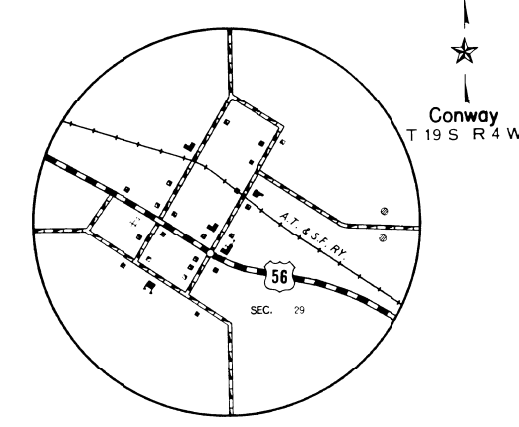
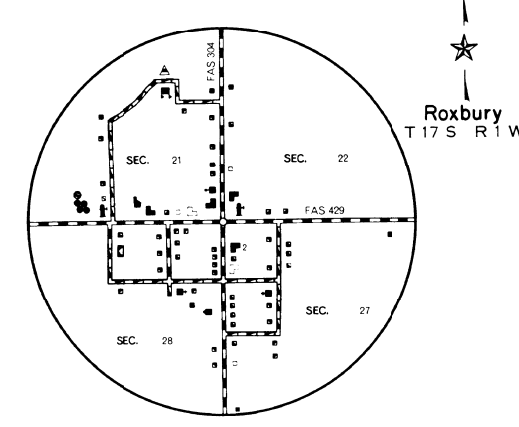
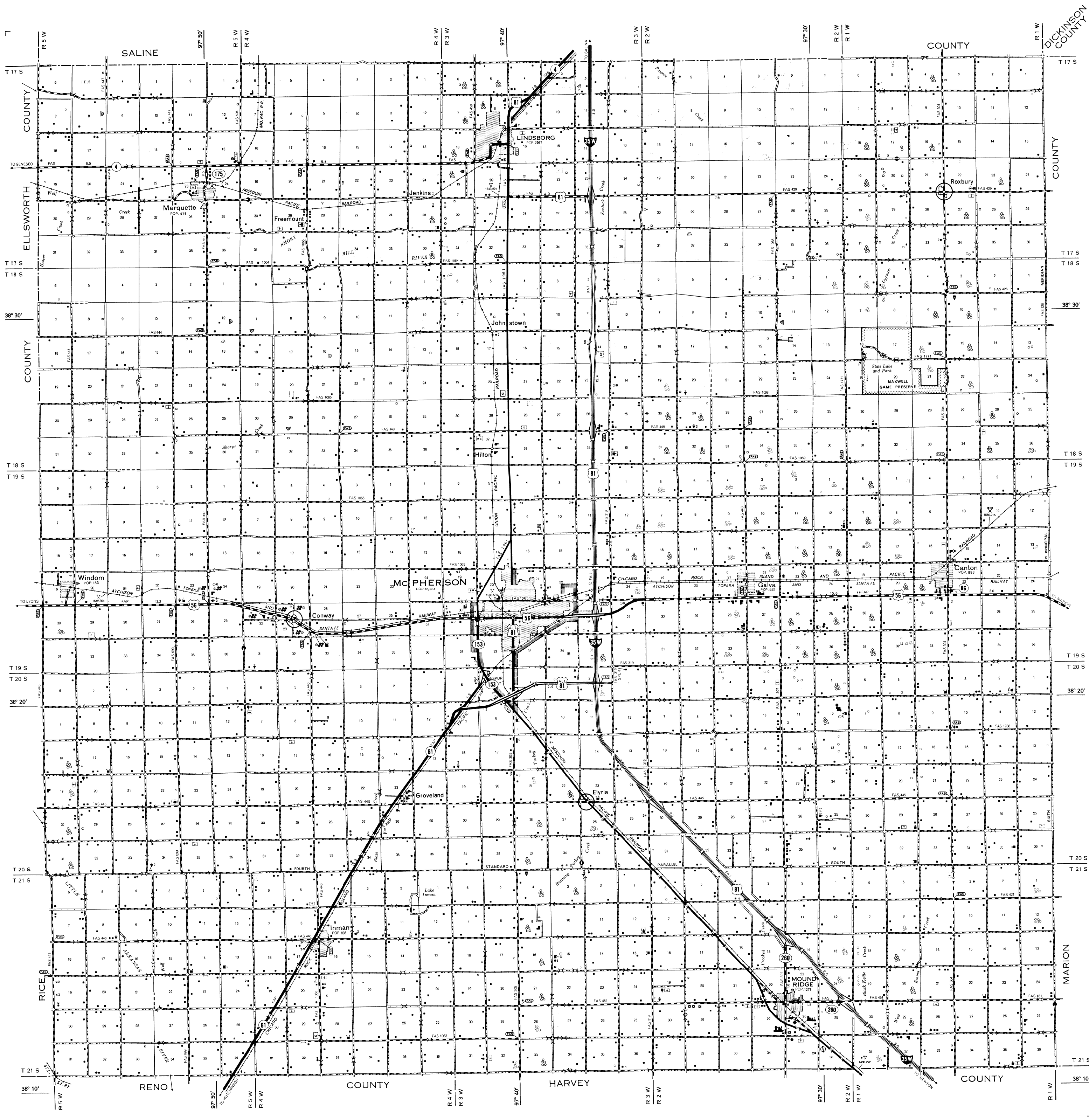

GENERAL HIGHWAY MAP MCPHERSON COUNTY KANSAS

PREPARED BY THE
STATE HIGHWAY COMMISSION OF KANSAS
DEPARTMENT OF PLANNING AND DEVELOPMENT
IN COOPERATION WITH THE
U. S. DEPARTMENT OF TRANSPORTATION
FEDERAL HIGHWAY ADMINISTRATION

SCALE
0 1 2 3 4 MILES

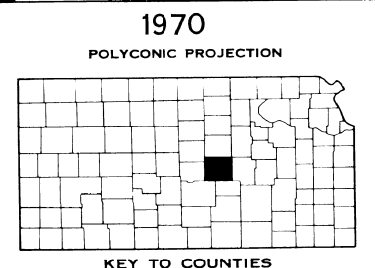

KEY TO COUNTIES
HORIZONTAL CONTROL, BASED ON
U. S. GEOLOGICAL SURVEY
SYSTEMS, REVISED TO 1970 (N. A. D.)