

LEGEND

ROADS AND ROADWAY FEATURES	CONSERVATION AND RECREATION
PRIMITIVE ROAD TYPE 41	PICNIC GROUND
UNIMPROVED ROAD TYPE 42	PLAYGROUND, BALL FIELD, ETC.
GRADED AND DRAINED ROAD TYPE 43	BATHING BEACH OR SWIMMING POOL
SOIL SURFACED ROAD TYPE 44	SCENIC SITE
GRAVEL OR STONE ROAD	CAMP SITE, NO PERMANENCE THERE OR TRAILER PARKING
NOT GRADED OR DRAINED TYPE 45	TOURIST COURT, OR MOTEL, OR RESTAURANT
GRADED AND DRAINED TYPE 46	CAMP OR LODGE
GRAVEL OR STONE ROAD WITH STABILIZED SURFACE TYPE 47	SMALL PARK
BUTYRUMINOUS ROAD-LOW TYPE TYPE 48	FISH HATCHERY
PAVED ROAD TYPE 49	BIRD SANCTUARY
DIVIDED HIGHWAY	GAME FARM
HIGHWAY WITH FULL CONTROL OF ACCESS	GAME PRESERVE
SIDE ROADS AND STREETS IN UNINCORPORATED URBAN COMPACTS AND EXTENSIONS OF LOCAL ROADS WITHIN MUNICIPALITIES.	RIFLE CLUB
4 LANE UNDIVIDED HIGHWAY	GOLF GROUND OR COUNTRY CLUB
PRIVATE ROAD	POLO GROUNDS
PROJECTED ROAD	RIDING ACADEMY
	YACHT CLUB
	AMUSEMENT PARK OR HALL
	FAIR GROUND, RACE COURSE, SPEEDWAY
	DRIVE-IN THEATRE
	FARM UNITS, DWELLINGS, ETC.
ROAD SYSTEM DESIGNATION	FARM UNIT
FEDERAL-AID INTERSTATE HIGHWAY SYSTEM	ROWS OR GROUPS OF DWELLINGS CLOSELY SPACED
FEDERAL-AID PRIMARY HIGHWAY SYSTEM	COMBINED DWELLING AND STORE
FEDERAL-AID SECONDARY HIGHWAY SYSTEM	DWELLING AND FILLING STATION
POINTS BETWEEN WHICH DISTANCES ARE MEASURED INDICATED THUS	DWELLING, BUSINESS, AND FILLING STATION
INTERSTATE NUMBERED HIGHWAY	TENANT HOUSE
U. S. NUMBERED HIGHWAY	SEASONAL OR SUMMER COLONY DWELLING
STATE HIGHWAY SYSTEM OR STATE NUMBERED HIGHWAY	HOTEL, INN
END OF DESIGNATED SYSTEM OR MARKED ROUTE	CHURCH OR OTHER RELIGIOUS INSTITUTION
	CHURCH AND SCHOOL
RAILROADS	CEMETERY
RAILROAD (NUMBER OF TRACKS USED BY A RAILROAD IN JUST TRACKS NOTED)	CHURCH WITH CEMETERY ADJACENT
RAILROADS IN JUNCTION	FRESH AIR FARM OR REST HOME
NARROW GAUGE RAILROADS	HOSPITAL
ELECTRIC INTERURBAN OR SUBURBAN RAILROAD	WELL
ABANDONED RAILROAD (TRACK REMAINS)	STATE PORT OF ENTRY OR WEIGHT STATION
ABANDONED ELECTRIC LINE (TRACK REMAINS)	GROUP OF MIXED CULTURAL FEATURES CLOSELY SPACED
RAILROAD STATION	GROUP OF MIXED CULTURAL FEATURES CLOSELY SPACED (SHOW NUMBER OF EACH HOUSE, BARRACKS, ETC.)
	INDUSTRIAL
RAILROAD CROSSINGS	STORE OR SMALL BUSINESS ESTABLISHMENT
GRADE CROSSING	BUSINESS AND POST OFFICE
RAILROAD ABOVE	BUSINESS AND FILLING STATION
RAILROAD BELOW	BUSINESS, FILLING STATION, AND POST OFFICE
RAILROAD BRIDGE	FACTORY OR INDUSTRIAL PLANT
	MINE-SHAFT OR DRIFT (AND KIND)
AIRWAYS AND AIRPORTS	OIL OR GAS WELL
AIR ROUTE	OIL OR GAS FIELD
AIRFIELD, LIMITED FACILITIES	OIL TANK
AIRPORT, COMPLETE FACILITIES (COMMERCIAL OR MILITARY)	GAS TANK
LANDING AREA OR STRIP (INCLUDING PRIVATE AIR FIELD)	GROUP OF STORAGE TANKS (OIL OR GAS)
AIRWAY LIGHT BEACON-GENERAL	FILLING STATION (NOT CONNECTED WITH OTHER BUSINESS)
AIRPORT-GENERAL	PUMPING STATION (OIL OR GAS)
	GAUGING OR PUMPING STATION (GENERAL)
NAVIGATION	VALVE HOUSE
NAVIGABLE STREAM (NOT IDENTIFIED BY NAVIGATION)	SEASONAL INDUSTRY (CANNERY OR MEAT-PACKING MILL)
INTERMITTENT STREAM	MILK DEPOT, CREAMERY OR CHEESE FACTORY
INTERMITTENT STREAM (NARROW)	FRUIT OR NUT ORCHARD
NARROW STREAM	FRUIT OR PRODUCE PACKING HOUSE
WIDE STREAM	ROAD STAND FARM PRODUCTS SALES
DRAINAGE DITCH	WAREHOUSE-GENERAL (OF GOVERNMENT AND STATE OR U. S.)
IRRIGATION DITCH	GRAIN ELEVATOR
LAKE, RESERVOIR, OR POND	GROUP OF GRAIN STORAGE BINS
LAKE, RESERVOIR, OR POND WITH DAM	GREENHOUSE
DRY LAKE SUBJECT TO FLOOD	NURSERY
MARSH OR SWAMP LAND	STOCK YARD-LOADING PEN OR CORRAL
OVERFLOW LAND	STOCK PEN AT RAILROAD SIDING (SMALL)
	GRAVEL PIT
STRUCTURES	QUARRY
HIGHWAY BRIDGE-GENERAL	MILN OR OVEN (LIME, CLAY PRODUCTS, COKE, ETC.)
SMALL BRIDGES CLOSELY SPACED	
BRIDGES FOR LONG RIVER CROSSINGS	EDUCATIONAL AND CORRECTIONAL INSTITUTIONS
	SCHOOLHOUSE
GENERAL	CONSOLIDATED OR LARGE SCHOOL
ARCH	TOWNHALL, GRANGE, OR COMMUNITY HALL
TRUSS OR GIRDER	AGRICULTURAL EXPERIMENT STATION
CANTILEVER BRIDGE	CORRECTIONAL INSTITUTION
COVERED BRIDGE	
HIGHWAY GRADE SEPARATION	PUBLIC SERVICE FACILITIES
	POST OFFICE
MISCELLANEOUS STRUCTURES	HIGHWAY GARAGE
DAM WITH ROAD	FIRE ENGINE HOUSE
LEVEE OR DIKE	GARAGE OR RUBBISH DUMP
LEVEE OR DIKE WITH ROAD	SEWAGE DISPOSAL PLANT
CONCRETE FORD OR DIP	AUTO SALVAGE YARD
FORD-ROAD ESTABLISHED	TRANSFORMER STATION
CATTLE GUARD	POWER PLANT
GATE ACROSS ROAD (ANY TYPE)	POWER SUBSTATION
	BOOSTER STATION
BOUNDARIES	WATER SUPPLY, STAND PIPE, OR TANK
STATE	RADIO STATION (WITH CALL LETTERS)
COUNTY	RADIO RANGE STATION
CORPORATE LINES	US WEATHER STATION
BOUNDARY LINES ESTABLISHED FOR DELIMITED URBAN PLACES	
SECTION LINE	MISCELLANEOUS
MATCH LINE BETWEEN ADJOINING SHEETS OF SAME COUNTY	FORT, ARMY CAMP, BARRACKS, OR OTHER MILITARY POST
BOUNDARY TO MARK ENLARGEMENT INSET	TRIANGULATION STATION
PARKS AND OTHER RESERVATIONS NATIONAL	BENCH MARK (WITH ELEVATION)
STATE, COUNTY, OR MUNICIPAL PARK	
INDIAN RESERVATION, NATIONAL MONUMENT, FEDERAL DEVELOPMENT PROJECT	NATURAL FEATURES
MONUMENT-SMALL, HISTORIC SITE	PROMINENT ELEVATION-WITH NAME
	SINK OR DEPRESSION
CITY AND VILLAGE CENTERS	
STATE CAPITAL	
COUNTY SEAT	
OTHER CITIES AND VILLAGES	
INCORPORATED CITY OR VILLAGE	
BOUNDARY LIMITS FIXED FOR SPECIAL TAXING AREAS AND OTHER UNINCORPORATED URBAN PLACES DELIMITED	

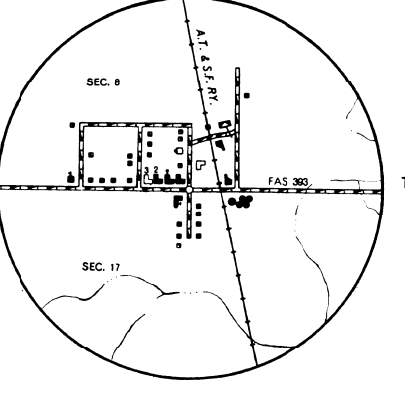
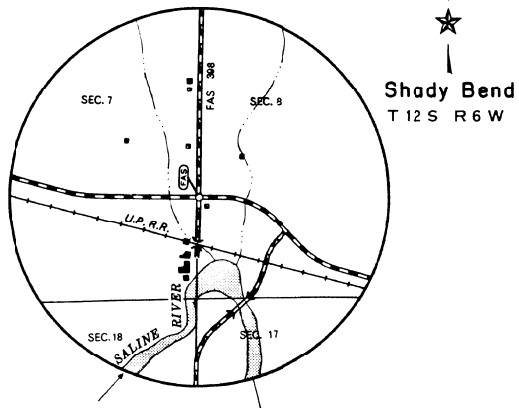
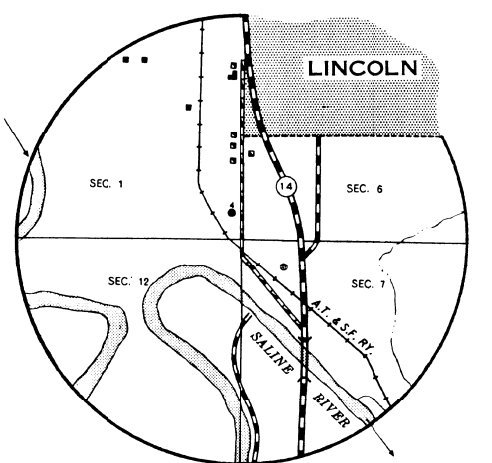
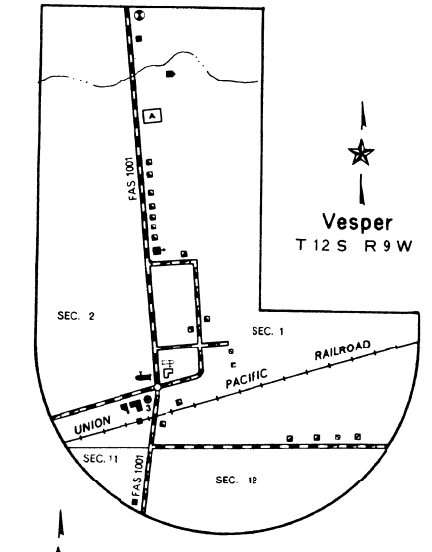
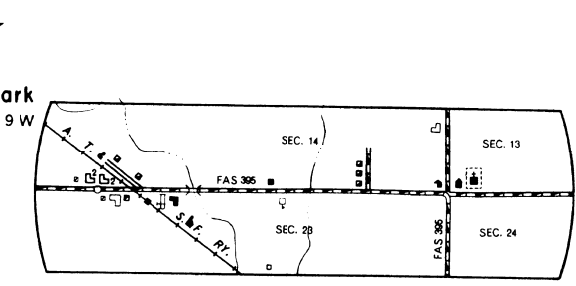
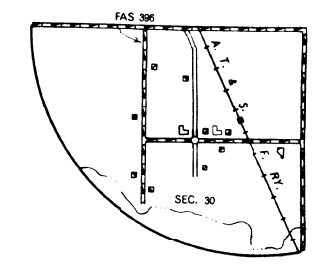
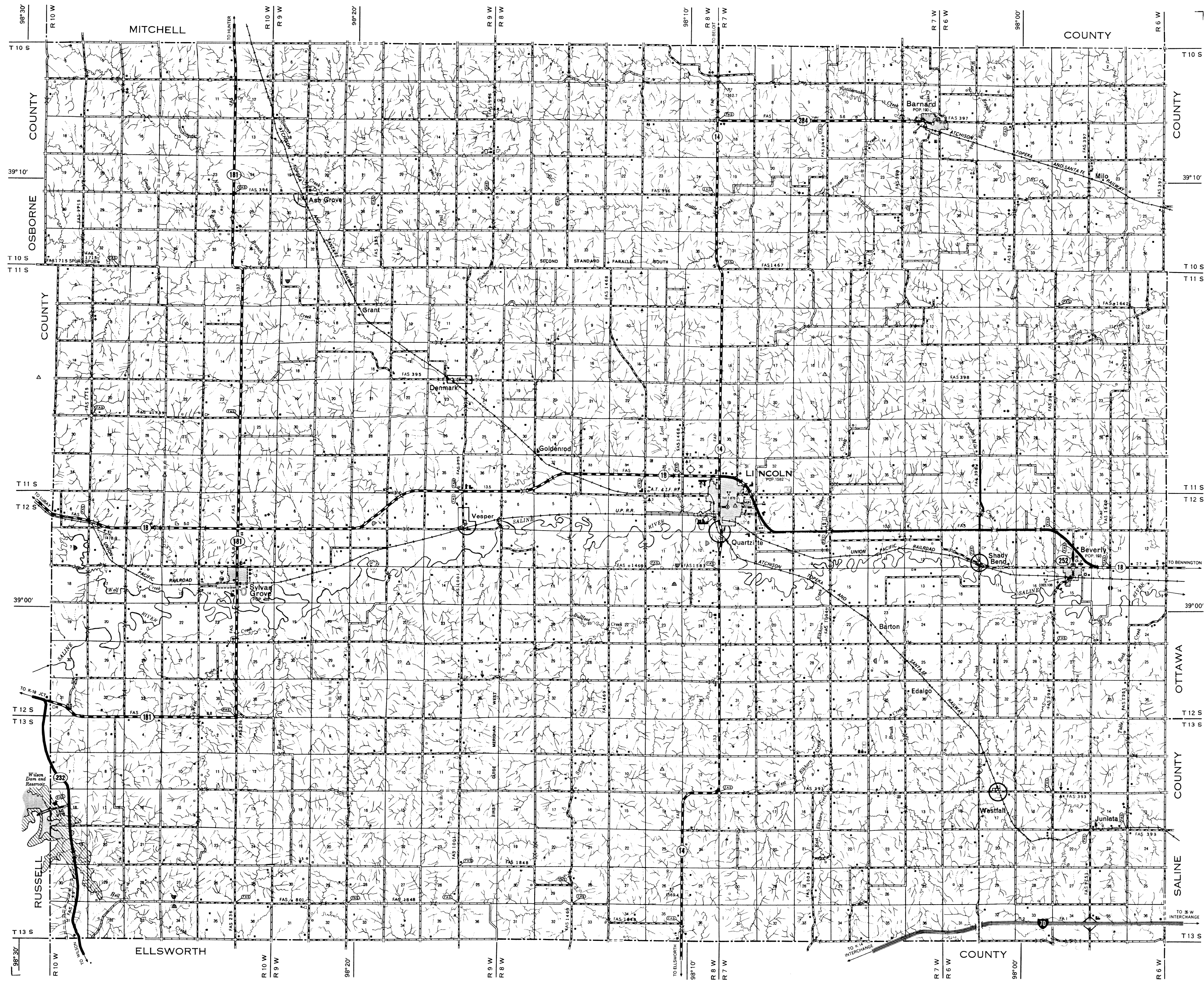

**GENERAL HIGHWAY MAP
LINCOLN COUNTY
KANSAS**

PREPARED BY THE
STATE HIGHWAY COMMISSION OF KANSAS
DEPARTMENT OF PLANNING AND DEVELOPMENT
IN COOPERATION WITH THE
U. S. DEPARTMENT OF TRANSPORTATION
FEDERAL HIGHWAY ADMINISTRATION

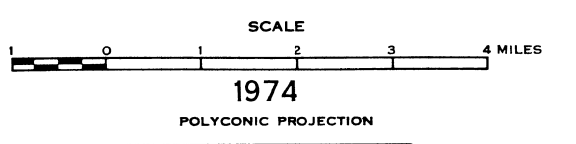

1974

POLYCONIC PROJECTION

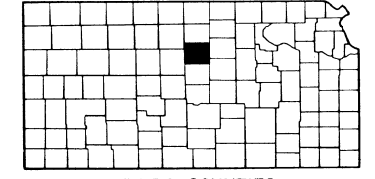

REVISIONARY COMPLETED 5-1-74
P. A. AND STATE
SYSTEMS REVISED TO 5-1-74