

*Road plotted in Reverse
due to wrong Arrow
on inventory*

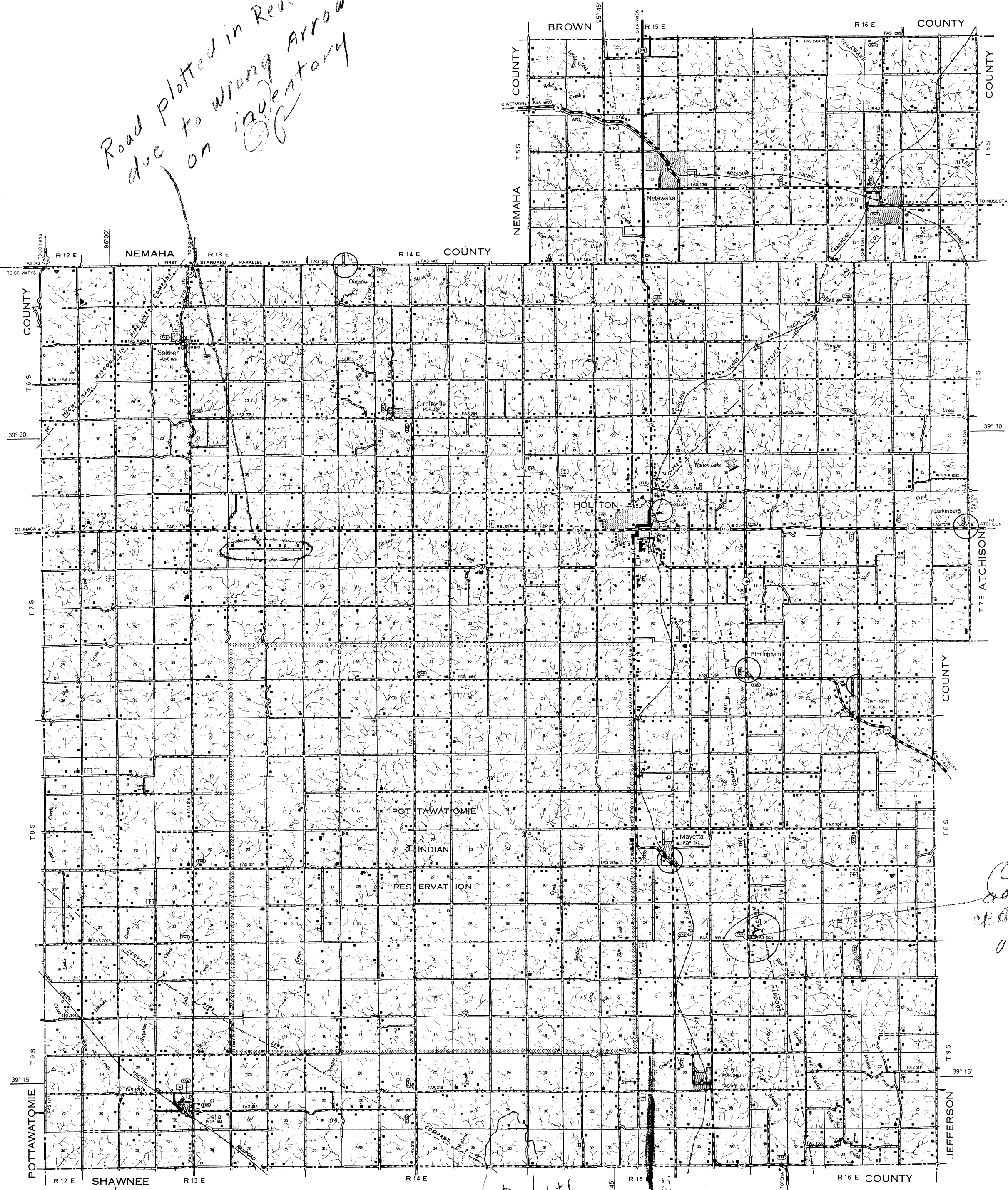

LEGEND

| ROADS AND ROADWAY FEATURES | CONSERVATION AND RECREATION |
|---|--|
| PRIMITIVE ROAD | PICNIC GROUND |
| UNIMPROVED ROAD | PLAYGROUNDS BALL FIELD, ETC. |
| GRADED AND DRAINED ROAD | BATHING BEACH OR SWIMMING POOL |
| SOIL SURFACED ROAD | SCENIC SITE |
| GRAVEL OR STONE ROAD | CAMP SITE NO PERMANENCE MARKS OR TRAILER PARKING |
| NOT GRADED OR DRAINED | TOURIST COURT OR MOTEL |
| GRAVEL OR STONE ROAD | CAMP OR LODGE PERMANENT SITE WITH BUILDINGS |
| STABILIZED SURFACE | SMALL PARK |
| BITUMINOUS ROAD-LOW TYPE | FISH HATCHERY |
| PAVED ROAD | BIRD SANCTUARY |
| DIVIDED HIGHWAY | GAME FARM |
| SIDE ROADS AND STREETS IN UNINCORPORATED URBAN COMPACTS AND EXTENSIONS OF LOCAL ROADS WITHIN MUNICIPALITIES | GOLF GROUND OR COUNTRY CLUB |
| PORTED URBAN COMPACTS AND EXTENSIONS OF LOCAL ROADS WITHIN MUNICIPALITIES | POLO GROUND |
| 4 LANE UNDIVIDED HIGHWAY | RIDING ACADEMY |
| PRIVATE ROAD | YACHT CLUB |
| PROJECTED ROAD | AMUSEMENT PARK OR MALL |
| | FAIR GROUND, RACE COURSE, SPEEDWAY |
| | DRIVE-IN THEATRE |
| | FARM UNITS, DWELLINGS, ETC. |
| | FARM UNIT |
| | DWELLING OTHER THAN FARM |
| | ROWS OR GROUPS OF DWELLINGS CLOSELY SPACED |
| | COMBINED DWELLING AND STORE |
| | DWELLING AND POST OFFICE |
| | DWELLING AND FILLING STATION |
| | DWELLING, BUSINESS, AND FILLING STATION |
| | TENANT HOUSE |
| | SEASONAL OR SUMMER COLONY DWELLING |
| | HOTEL (INN) |
| | CHURCH OR OTHER RELIGIOUS INSTITUTION |
| | CHURCH AND SCHOOL |
| | CHURCH WITH CEMETERY ADJACENT |
| | FRESH AIR FARM OR REST HOME |
| | WELL |
| | STATE HIGHWAY OF ENTRY OR WEIGHT STATION |
| | GROUP OF MIXED CULTURAL FEATURES CLOSELY SPACED |
| | INDUSTRIAL |
| | STORE OR SMALL BUSINESS ESTABLISHMENT |
| | BUSINESS AND POST OFFICE |
| | BUSINESS AND FILLING STATION |
| | BUSINESS, FILLING STATION, AND POST OFFICE |
| | FACTORY OR INDUSTRIAL PLANT |
| | MINE-SHAFT OR DRIFT |
| | OIL OR GAS WELL |
| | OIL OR GAS FIELD |
| | OIL TANK |
| | GAS TANK |
| | GROUP OF STORAGE TANKS |
| | FILLING STATION |
| | PUMPING STATION |
| | GAUGING OR PUMPING STATION |
| | SEASONAL INDUSTRY |
| | MILK DEPOT, CREAMERY OR CHEESE FACTORY |
| | FRUIT OR NUT ORCHARD |
| | FRUIT OR PRODUCE PACKING HOUSE |
| | ROAD STAND FARM PRODUCTS SALES |
| | WAREHOUSE-GENERAL |
| | C. C. STORAGE BINS |
| | GREENHOUSE |
| | NURSERY |
| | STOCK YARD-LOADING PEN OR CORRAL |
| | STOCK PEN AT RAILROAD SIDING |
| | GRAVEL PIT |
| | QUARRY |
| | KILN OR OVEN |
| | EDUCATIONAL AND CORRECTIONAL INSTITUTIONS |
| | SCHOOLHOUSE |
| | CONSOLIDATED OR LARGE SCHOOL |
| | TOWNHALL, GRANGE, OR COMMUNITY HALL |
| | AGRICULTURAL EXPERIMENT STATION |
| | COUNTY FARM |
| | CORRECTIONAL INSTITUTION |
| | PUBLIC SERVICE FACILITIES |
| | POST OFFICE |
| | HIGHWAY GARAGE |
| | FIRE ENGINE HOUSE |
| | GARBAGE OR RUBBISH DUMP |
| | SEWAGE DISPOSAL PLANT |
| | WATER TOWER |
| | PIPE LINE, GAS |
| | PIPE LINE, OIL |
| | PIPE LINE, PRODUCTS |
| | TRANSMISSION LINE |
| | POWER PLANT |
| | POWER SUBSTATION |
| | BOOSTER STATION |
| | UNDERGROUND TELEPHONE OR RADIO CABLE |
| | RADIO STATION |
| | RADIO RANGE STATION |
| | MISCELLANEOUS |
| | FORT, ARMY CAMP, BARRACKS, OR OTHER |
| | MILITARY POST |
| | TRIANGULATION STATION |
| | BEACH MARK |
| | NATURAL FEATURES |
| | PROMINENT ELEVATION WITH NAME |
| | SINK OR DEPRESSION |

GENERAL HIGHWAY MAP
JACKSON COUNTY
KANSAS

PREPARED BY THE
STATE HIGHWAY COMMISSION OF KANSAS
HIGHWAY PLANNING DEPARTMENT

IN COOPERATION WITH THE
U. S. DEPARTMENT OF COMMERCE
BUREAU OF PUBLIC ROADS

