

**LEGEND**

<p><b>ROADS AND ROADWAY FEATURES</b></p> <ul style="list-style-type: none"> <li>UNIMPROVED ROAD (TYPE A)</li> <li>GRADED AND DRAINED ROAD (TYPE B)</li> <li>SOIL SURFACED ROAD (TYPE C)</li> <li>GRAVEL OR STONE ROAD - NOT GRADED OR DRAINED (TYPE D)</li> <li>GRAVEL OR STONE ROAD - GRADED AND DRAINED (TYPE E)</li> <li>GRAVEL OR STONE ROAD WITH STABILIZED SURFACE (TYPE F)</li> <li>BITUMINOUS ROAD - LOW TYPE (TYPE G)</li> <li>PAVED ROAD (TYPE H)</li> <li>DIVIDED HIGHWAY</li> <li>HIGHWAY WITH FULL CONTROL OF ACCESS</li> <li>SIDE ROADS AND STREETS IN UNINCORPORATED URBAN LOCALITIES AND EXTENSIONS OF LOCAL ROADS WITHIN MUNICIPALITIES</li> <li>4 LANE UNDIVIDED HIGHWAY</li> <li>PRIVATE ROAD</li> <li>PROJECTED ROAD</li> </ul> <p><b>ROAD SYSTEM DESIGNATION</b></p> <ul style="list-style-type: none"> <li>FEDERAL-AID INTERSTATE HIGHWAY SYSTEM</li> <li>FEDERAL-AID PRIMARY HIGHWAY SYSTEM</li> <li>FEDERAL-AID SECONDARY HIGHWAY SYSTEM</li> <li>POINTS BETWEEN WHICH DISTANCES ARE MEASURED INDICATED THUS</li> <li>INTERSTATE NUMBERED HIGHWAY</li> <li>U.S. NUMBERED HIGHWAY</li> <li>STATE HIGHWAY SYSTEM OR STATE NUMBERED HIGHWAY</li> <li>END OF DESIGNATED SYSTEM OR MARKED ROUTE</li> </ul> <p><b>RAILROADS</b></p> <ul style="list-style-type: none"> <li>RAILROAD (TYPE A)</li> <li>RAILROADS IN DISPOSITION (TYPE B)</li> <li>NARROW GAUGE RAILROAD</li> <li>ELECTRIC INTERURBAN OR SUBURBAN RAILROAD</li> <li>ABANDONED RAILROAD (TRACK REMOVED)</li> <li>ABANDONED ELECTRIC LINE (TRACK REMOVED)</li> <li>RAILROAD STATION</li> </ul> <p><b>RAILROAD CROSSINGS</b></p> <ul style="list-style-type: none"> <li>GRADE CROSSING</li> <li>RAILROAD ABOVE</li> <li>RAILROAD BELOW</li> <li>RAILROAD BRIDGE</li> </ul> <p><b>AIRWAYS AND AIRPORTS</b></p> <ul style="list-style-type: none"> <li>AIR ROUTE</li> <li>MILITARY FIELD (SEE FACILITIES AVAILABLE)</li> <li>AIRPORT, COMPLETE FACILITIES (COMMERCIAL OR MUNICIPAL)</li> <li>AIRFIELD LIMITED FACILITIES</li> <li>LANDING AREA OR STRIP (INCLUDING PRIVATE AIR FIELDS)</li> <li>AIRWAY LIGHT BEACON - GENERAL</li> <li>AIRPORT - GENERAL</li> </ul> <p><b>NAVIGATION</b></p> <ul style="list-style-type: none"> <li>NAVIGABLE STREAM (WITH OTHER NAVIGATION)</li> </ul> <p><b>DRAINAGE</b></p> <ul style="list-style-type: none"> <li>INTERMITTENT STREAM</li> <li>INTERMITTENT STREAM</li> <li>NARROW STREAM</li> <li>WIDE STREAM</li> <li>DRAINAGE DITCH</li> <li>IRRIGATION DITCH</li> <li>LAKE, RESERVOIR, OR POND</li> <li>LAKE, RESERVOIR, OR POND WITH DAM</li> <li>DRY LAKE SUBJECT TO FLOOD</li> <li>MARSH OR SWAMP LAND</li> <li>OVERFLOW LAND</li> </ul> <p><b>STRUCTURES</b></p> <ul style="list-style-type: none"> <li>HIGHWAY BRIDGE, GENERAL</li> <li>GRAVEL PIT</li> <li>SMALL BRIDGES CLOSELY SPACED</li> </ul> <p><b>BRIDGES FOR LONG RIVER CROSSINGS</b></p> <ul style="list-style-type: none"> <li>GENERAL</li> <li>ARCH</li> <li>TRUSS OR GIRDER (WOOD &amp; STEEL)</li> <li>CANTILEVER BRIDGE</li> <li>COVERED BRIDGE</li> <li>HIGHWAY GRADE SEPARATION</li> </ul> <p><b>MISCELLANEOUS STRUCTURES</b></p> <ul style="list-style-type: none"> <li>DAM WITH ROAD</li> <li>LEVEE OR DIKE</li> <li>LEVEE OR DIKE WITH ROAD</li> <li>CONCRETE FORD OR DIP</li> <li>FORD - ROAD ESTABLISHED</li> <li>CATTLE GUARD</li> <li>GATE ACROSS ROAD</li> </ul> <p><b>BOUNDARIES</b></p> <ul style="list-style-type: none"> <li>STATE</li> <li>COUNTY</li> <li>CORPORATE LINES</li> <li>BOUNDARY LINES ESTABLISHED FOR DELIMITED URBAN PLACES</li> <li>SECTION LINE</li> <li>MATCH LINE BETWEEN ADJOINING SHEETS OF SAME COUNTY</li> <li>BOUNDARY TO MARK ENLARGEMENT INSET</li> <li>PARKS AND OTHER RESERVATIONS NATIONAL</li> <li>STATE, COUNTY, OR MUNICIPAL PARK</li> <li>INDIAN RESERVATION - NATIONAL MONUMENT</li> <li>FEDERAL DEVELOPMENT PROJECT</li> <li>MONUMENT - SMALL HISTORIC SITE</li> </ul> <p><b>CITY AND VILLAGE CENTERS</b></p> <ul style="list-style-type: none"> <li>STATE CAPITAL</li> <li>COUNTY SEAT</li> <li>OTHER CITIES AND VILLAGES</li> <li>INCORPORATED CITY OR VILLAGE</li> <li>BOUNDARY LIMITS FIXED FOR SPECIAL TAXING AREAS AND OTHER UNINCORPORATED URBAN PLACES DELIMITED</li> </ul>	<p><b>CONSERVATION AND RECREATION</b></p> <ul style="list-style-type: none"> <li>PICNIC GROUND</li> <li>PLAYGROUND, BALL FIELD, ETC.</li> <li>BATHING BEACH OR SWIMMING POOL</li> <li>SCENIC SITE</li> <li>CAMP SITE, NO PERMANENCE (TENTS OR TRAILER PARKING)</li> <li>TOURIST COURT OR MOTEL (UNLESS INDICATED OTHERWISE)</li> <li>CAMP OR LODGE (PERMANENT SITE WITH BUILDINGS)</li> <li>SMALL PARK (UNLESS OTHERWISE MARKED)</li> <li>FISH HATCHERY</li> <li>BIRD SANCTUARY</li> <li>GAME FARM</li> <li>GAME PRESERVE</li> <li>RIFLE CLUB</li> <li>GOLF GROUND OR COUNTRY CLUB</li> <li>POLO GROUNDS</li> <li>RIDING ACADEMY</li> <li>YACHT CLUB</li> <li>AMUSEMENT PARK OR HALL</li> <li>FAIR GROUND, RACE COURSE, SKEWADWAY</li> <li>DRIVE-IN THEATRE</li> </ul> <p><b>FARM UNITS, DWELLINGS, ETC.</b></p> <ul style="list-style-type: none"> <li>FARM UNIT</li> <li>DWELLING (OTHER THAN FARM)</li> <li>ROWS OR GROUPS OF DWELLINGS CLOSELY SPACED</li> <li>COMBINED DWELLING AND STORE</li> <li>DWELLING AND FILLING STATION</li> <li>DWELLING, BUSINESS, AND FILLING STATION</li> <li>TENANT HOUSE</li> <li>SEASONAL OR SUMMER COLONY DWELLING</li> <li>HOTEL, INN</li> <li>CHURCH OR OTHER RELIGIOUS INSTITUTION</li> <li>CHURCH AND SCHOOL (UNLESS NOTED)</li> <li>CEMETERY</li> <li>CHURCH WITH CEMETERY ADJACENT</li> <li>FRESH AIR FARM OR REST HOME</li> <li>HOSPITAL</li> <li>WELL</li> <li>STATE POINT OF ENTRY OR WEIGHT STATION</li> <li>GROUP OF MIXED CULTURAL FEATURES CLOSELY SPACED (INCLUDING THE SPECIAL CASES OF CHURCHES AND SCHOOLS)</li> </ul> <p><b>INDUSTRIAL</b></p> <ul style="list-style-type: none"> <li>STORE OR SMALL BUSINESS ESTABLISHMENT</li> <li>BUSINESS AND FILLING STATION</li> <li>BUSINESS, FILLING STATION, AND POST OFFICE</li> <li>FACTORY OR INDUSTRIAL PLANT</li> <li>MINE SHAFT OR DRIFT (SEE ROAD)</li> <li>OIL OR GAS WELL</li> <li>OIL OR GAS FIELD</li> <li>OIL TANK</li> <li>GAS TANK</li> <li>GROUP OF STORAGE TANKS (OIL OR GAS)</li> <li>FILLING STATION (OIL OR GAS)</li> <li>PUMPING STATION (OIL OR GAS)</li> <li>GAUGING OR PUMPING STATION (GENERAL)</li> <li>VALVE HOUSE</li> <li>SEASONAL INDUSTRY (EQUIPMENT OF SMALL SCALE)</li> <li>MILK DEPOT, CREAMERY, OR CHEESE FACTORY</li> <li>FRUIT OR NUT ORCHARD</li> <li>FRUIT OR PRODUCE PACKING HOUSE</li> <li>ROAD STAND FARM PRODUCTS SALES</li> <li>WAREHOUSE - GENERAL (IF GOVERNMENT AND STATE OR U.S. GRAIN ELEVATOR)</li> <li>GROUP OF GRAIN STORAGE BINS</li> <li>GREENHOUSE</li> <li>NURSERY</li> <li>STOCK YARD - LOADING PEN OR CORRAL</li> <li>STOCK PEN AT RAILROAD SIDING (SMALL)</li> <li>QUARRY</li> <li>KILN OR COVER (LIME, CLAY, PRODUCE, COKE, ETC.)</li> </ul> <p><b>EDUCATIONAL AND CORRECTIONAL INSTITUTIONS</b></p> <ul style="list-style-type: none"> <li>SCHOOLHOUSE</li> <li>CONSOLIDATED OR LARGE SCHOOL</li> <li>TOWNHALL, GRANGE, OR COMMUNITY HALL</li> <li>AGRICULTURAL EXPERIMENT STATION</li> <li>COUNTY FARM</li> <li>CORRECTIONAL INSTITUTION</li> </ul> <p><b>PUBLIC SERVICE FACILITIES</b></p> <ul style="list-style-type: none"> <li>POST OFFICE</li> <li>HIGHWAY GARAGE</li> <li>FIRE ENGINE HOUSE</li> <li>GARAGE OR REPAIR SHOP</li> <li>SEWAGE DISPOSAL PLANT</li> <li>WATER SUPPLY STAND PIPE OR TANK</li> <li>TRANSMISSION LINE (WITH TRANSFORMER STATION)</li> <li>POWER PLANT</li> <li>POWER SUBSTATION</li> <li>BOODER STATION</li> <li>UNDERGROUND TELEPHONE OR RADIO CABLE</li> <li>RADIO STATION (WITH CALL LETTERS)</li> <li>RADIO RANGE STATION</li> </ul> <p><b>MISCELLANEOUS</b></p> <ul style="list-style-type: none"> <li>FORT, ARMY CAMP, BARRACKS, OR OTHER MILITARY POST</li> <li>TRIANGULATION STATION</li> <li>BENCH MARK (WITH ELEVATION)</li> </ul> <p><b>NATURAL FEATURES</b></p> <ul style="list-style-type: none"> <li>PROMINENT ELEVATION WITH NAME</li> <li>CLIFF</li> <li>SINK OR DEPRESSION</li> </ul>
---	---

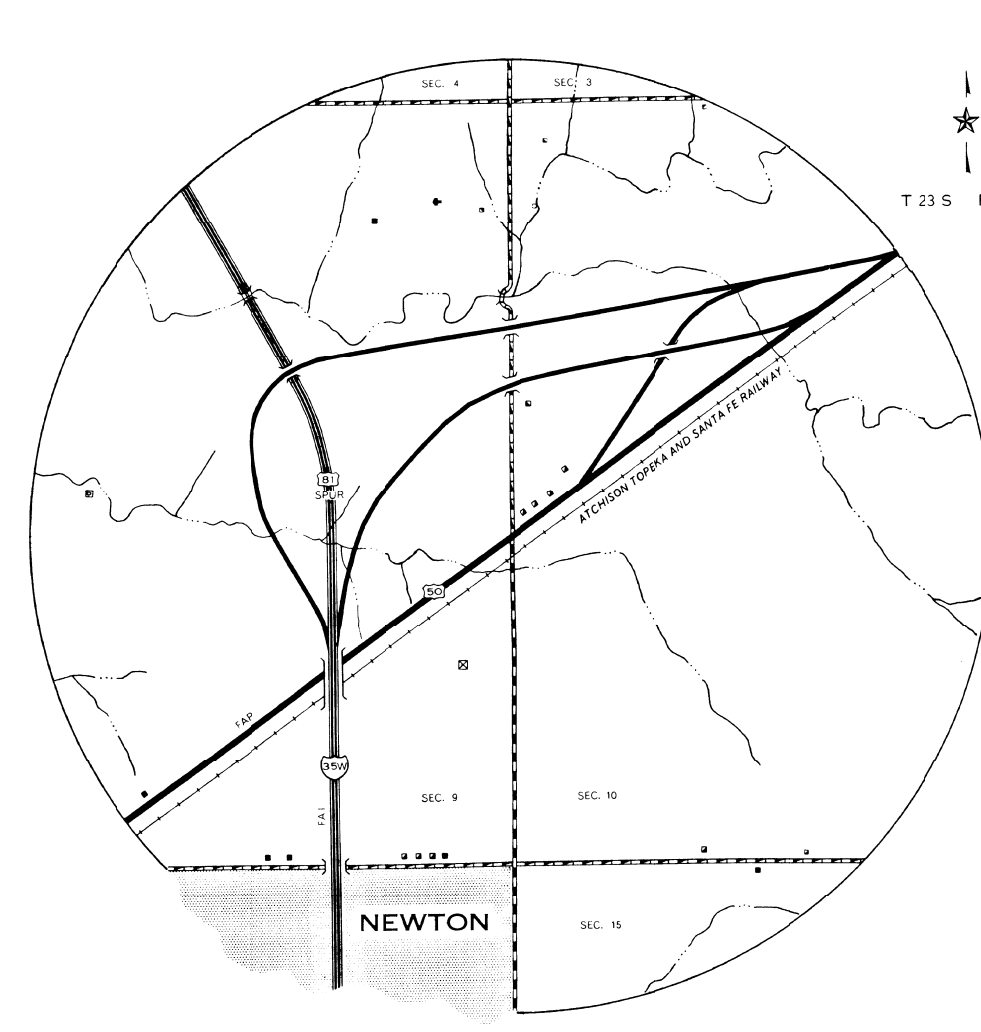
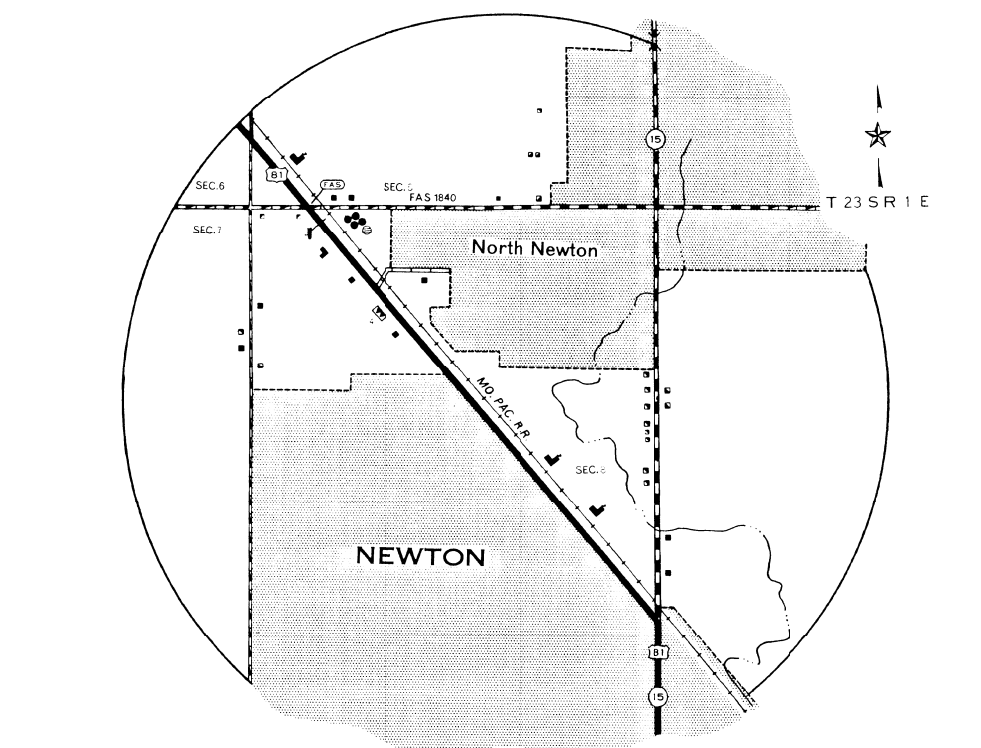
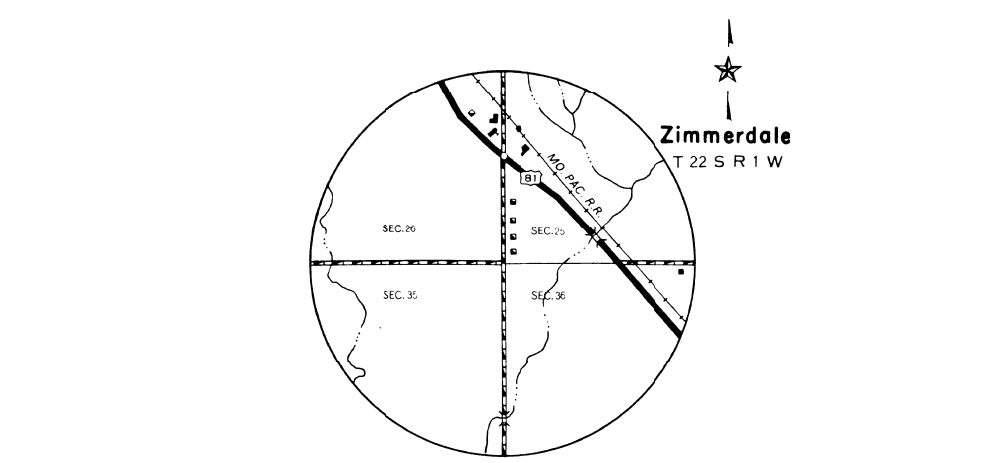
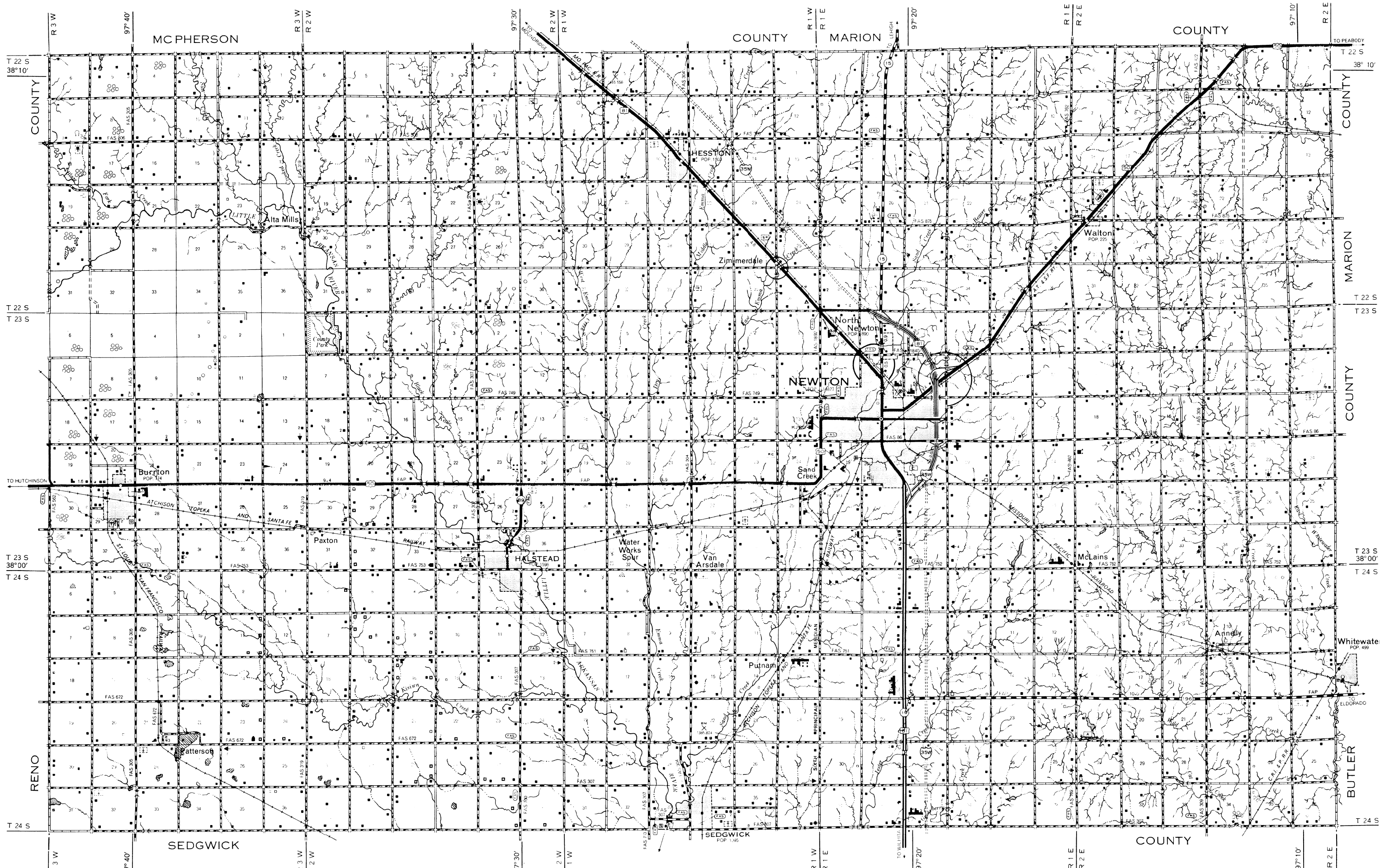

ENLARGEMENT SCALE  
0 1 2 MILE

**GENERAL HIGHWAY MAP  
HARVEY COUNTY  
KANSAS**

PREPARED BY THE  
STATE HIGHWAY COMMISSION OF KANSAS  
HIGHWAY PLANNING DEPARTMENT  
IN COOPERATION WITH THE  
U. S. DEPARTMENT OF COMMERCE  
BUREAU OF PUBLIC ROADS

SCALE  
0 1 2 3 MILES

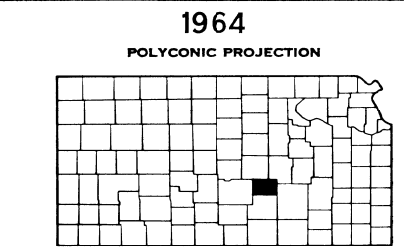

REINVENTORY COMPLETED 12-31-54  
F. A. AND STATE  
SYSTEMS REVISED TO 5-10-54

1964  
POLYCONIC PROJECTION  
KEY TO COUNTIES  
ORIGINAL CONTROL MARKS  
U.S. COAST AND GEODETIC SURVEY  
1967 (C.A.S.)