

ENLARGEMENT SCALE
0 1 2 3 4 MILE

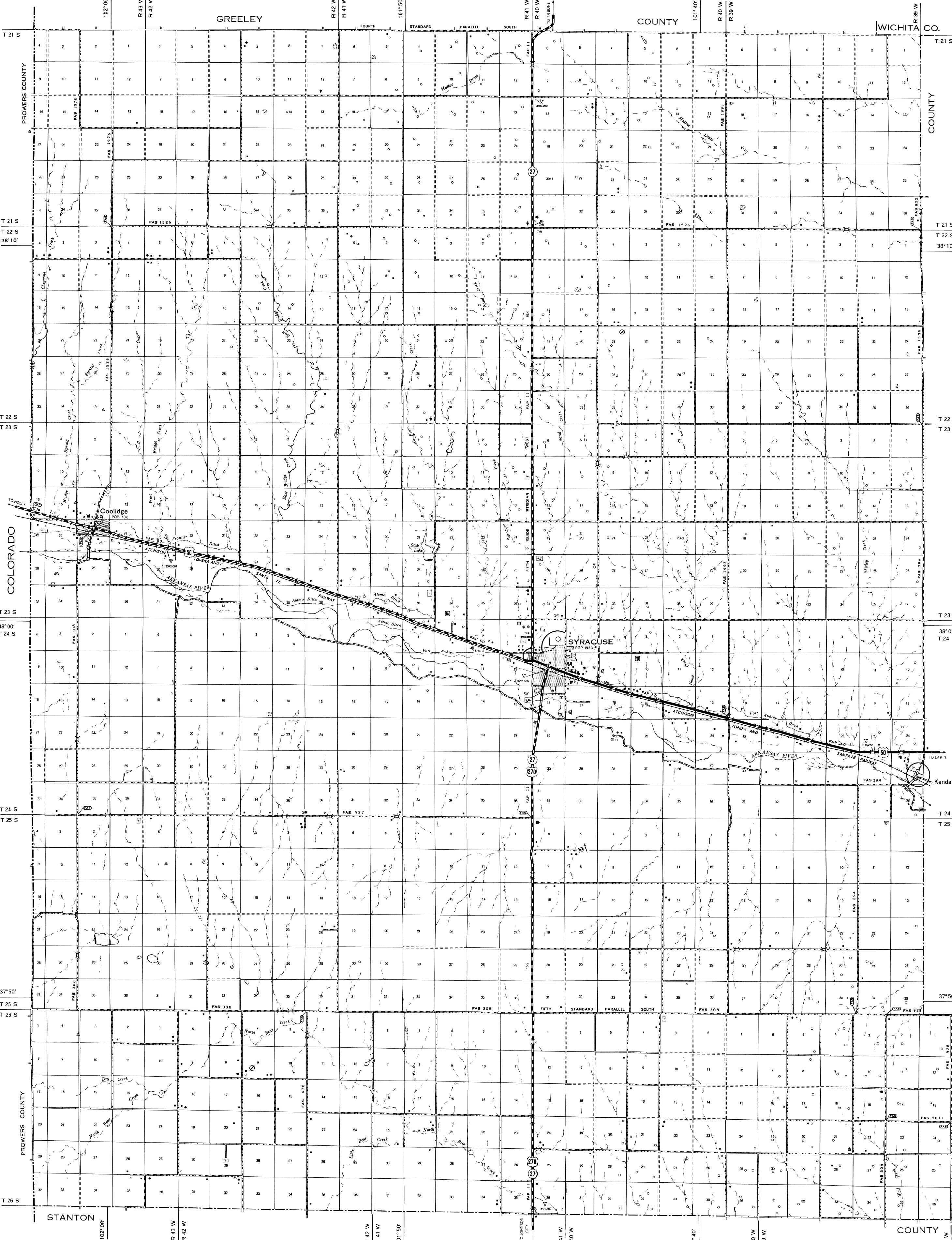

LEGEND

- ROADS AND ROADWAY FEATURES**
 - Primitive Road (Type A)
 - Unimproved Road (Type B)
 - Graded and Drained Road (Type C)
 - Seal Surfaced Road (Type D)
 - Gravel or Stone Road
 - Not Graded or Drained (Type E-1)
 - Gravel or Stone Road
 - Graded and Drained (Type E-2)
 - Gravel or Stone Road
 - Standard Surface (Type E-3)
 - Burnished Road-Low Type (Type F, G, H, I)
 - Paved Road (Type G, H, I, J, K, L)
 - Divided Highway
 - Highway With Full Control of Access
 - Side Roads and Drives in Incorporated Urban Compacts and Extensions of Local Roads Within Municipalities
 - 4 Lane Undivided Highway
 - Projected Road
 - Road System Designation
 - Federal-Aid Interstate Highway System
 - Federal-Aid Primary Highway System
 - Federal-Aid Secondary Highway System
 - Federal-Aid Urban Highway System
 - Points Between Which Distances are Measured
 - Measured
 - U.S. Numbered Highway
 - State Highway System or State Numbered Highway
 - End of Designated Highway
 - Marked Road
- RAILROADS**
 - Railroad (Any Number of Tracks Used by a Single Operating Company or by Trains of Another Carrier Under Trackage Rights)
 - Railroads in Jurisdiction Two or More
 - Trackage of Separate Operating Companies on Adjacent Rights-of-Way
 - Abandoned Railroad (Track Retained)
 - Railroad Crossing
 - Grade Crossing
 - Railroad Above
 - Railroad Below
 - Railroad Bridge
 - City and Village Centers
 - State Capital
 - County Seat
 - Other Cities and Villages
 - Incorporated City or Village
 - Boundary Limits Placed for Special Tracing Areas and Other Unincorporated Urban Places Delimited
 - Miscellaneous
 - Fort, Army Camp, Barracks, or Other Military Post
 - Transection Station
 - Section Mark (With Elevation)
- CONSERVATION AND RECREATION**
 - Picnic Ground
 - Playground, Ball Field, Etc.
 - Bathing Beach or Swimming Pool
 - Scenic Site
 - Camp Site, No Permanence (Tents or Trailer Parking)
 - Tourist Court or Motel (Figures Indicate Number of Permanent Cottages or Cottages)
 - Camp or Lodge (Permanent Site With Building)
 - Small Park (SP-State, CP-County, WM-Municipal, SR-Safety Rest Area)
 - Fair Grounds
 - Game Preserve
 - Game Farm
 - Game Preserve
 - Rifle Club
 - Golf Ground or Country Club
 - Riding Academy
 - Yacht Club
 - Amusement Park or Hall
 - Fair Ground, Race Course, Speedway
 - Dunes in Thicket
 - Manna
 - Rabbit Grounds
 - Guide House or Gate House (Add Letters for S to indicate National or State Park)
- BOUNDARIES**
 - State
 - County
 - Corporate Lines
 - Boundary Lines Established For Delimited Urban Places
 - Section Line
 - Boundary to Mark Encroachment Inset
 - Parks and Other Reservations National, State, County, or Municipal Park, Indian Reservation, National Monument, Federal Development Project, Monument—Small, Historic Site
- STRUCTURES**
 - Highway Bridge—General (Total Span Greater Than 30 Feet)
 - Small Bridge—Closely Spaced
 - Miscellaneous Structures
 - Levee Or Dike
 - Levee Or Dike With Road
 - Concrete Ford Or Dip
 - Ford Road Established
 - Cattle Guard
 - Gate Across Road (Any Type)
 - Bridges For Long River Crossings
- FARM UNITS, DWELLINGS, ETC.**
 - Farm Unit
 - Dwelling (Other Than Farm)
 - Roses or Groups of Dwellings Closely Spaced (Figure Denotes Number of Dwellings)
 - Combined Dwelling and Store
 - Dwelling and Post Office
 - Dwelling and Filing Station
 - Dwelling, Business, and Filing Station
 - Tenant House
 - Seasonal or Summer Colony Dwelling
 - Hall in Thicket
 - Human Society Quarters
 - Church or Other Religious Institution
 - Church and School (Joint Use)
 - Cemetery
 - Church With Cemetery Adjacent
 - Farm or Farm or Rest Home
 - Hospital
 - Well
 - State Port of Entry or Weight Station
 - Group of Mixed Cultural Features Closely Spaced (Figure above bar indicates number of dwellings included in the group; Figures over individual units show number of each included regardless of order)
- EDUCATIONAL AND CORRECTIONAL INSTITUTIONS**
 - Schoolhouse
 - Consolidated or Large School
 - Townhall, Garage, or Community Hall
 - Agricultural Experiment Station
 - Correctional Institution
 - Museum—General
 - Public Library
- PUBLIC SERVICE FACILITIES**
 - Post Office
 - Highway Garage
 - Fire Engine House
 - Garage or Rubbish Dump
 - Sanitary Disposal Plant
 - Auto Washing Yard
 - Transformer Station
 - Power Station
 - Power Substation
 - Water Supply Stand Pipe or Tank
 - Radio Station (With Call Letters)
 - Radio Range Station
 - Water Treatment Plant
 - Juniper
 - U.S. Corps of Engineers Office
- NATURAL FEATURES**
 - Prominent Elevation—With Name (Numbers Indicate Elevation Above Sea Level)
 - Sea or Depression
 - Highway Grade Separation
- INDUSTRIAL**
 - Show or Small Business Establishment
 - Business and Post Office
 - Business and Filing Station
 - Business, Filing Station, and Post Office
 - Factory or Industrial Plant
 - Metal-Shop or Drill (Any Kind)
 - Oil or Gas Well
 - Oil or Gas Field
 - Storage Tank (Gas or Oil Figure Denotes Number of Tanks)
 - Filing Station (Not Connected With Other Business)
 - Pumping Station (Oil or Gas)
 - Gassing or Pumping Station (General)
 - Valve House
 - Seasonal Industry (Cannery or Small Grain Mill)
 - Fruit or Nut Orchard
 - Milk Depot, Creamery or Cheese Factory
 - Fruit or Produce Packing House
 - Road Stand Farm Products Sales
 - Warehouse—General (If Government Add State or U.S.)
 - Grain Elevator
 - Group of Grain Storage Bins
 - Greenhouse
 - Nursery
 - Stock Yard Loading Pen or Corral
 - Stock Pen or Retained Being (Small)
 - Gravel Pit
 - Quarry
 - Kim or Oven (Lime, Clay Products, Coke, Etc.)
 - Feed Lot
 - Shopping Center
 - Sawmill (Stationary)
- NAVIGATION**
 - Navigable Stream (N=intermittent navigation)
- DRAINAGE**
 - Intermittent Stream (Normal)
 - Intermittent Stream (Wet)
 - Narrow Stream
 - Wet Stream
 - Drainage Ditch
 - Impoundment
 - Lake, Reservoir, or Pond
 - Lake, Reservoir, or Pond With Dam
 - Dry, Lake Subject To Flood
 - Dam or Weir
 - Overtlow Land
- AIRWAYS AND AIRPORTS**
 - Military Field (Some Facilities Available)
 - Airport Complete Facilities (Commercial or Municipal)
 - Fielded Limited Facilities
 - Landing Area or Strip (Including Private Air Fields)
 - Army Light Station, General
 - Airport General

GENERAL HIGHWAY MAP
HAMILTON COUNTY
KANSAS

PREPARED BY THE
KANSAS DEPARTMENT OF TRANSPORTATION
PLANNING AND DEVELOPMENT DEPARTMENT
IN COOPERATION WITH THE
U. S. DEPARTMENT OF TRANSPORTATION
FEDERAL HIGHWAY ADMINISTRATION

SCALE
0 1 2 3 4 MILES

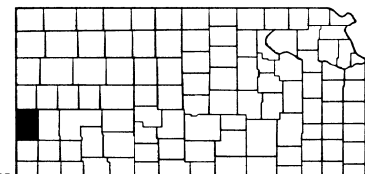

1980

POLYCONIC PROJECTION

POPULATIONS - STATE BOARD OF AGRICULTURE
INVENTORY COMPLETED 1978
F. A. AND STATE
SYSTEM REVISED TO 1980

KEY TO COUNTIES