

LEGEND

ROADS AND ROADWAY FEATURES		CONSERVATION AND RECREATION	
PRIMITIVE ROAD TYPE A1	PICNIC GROUND
UNIMPROVED ROAD TYPE B1	PLAYGROUND, BALL FIELD, ETC.
GRAVEL AND DRAINED ROAD TYPE B2	BATHING BEACH OR SWIMMING POOL
SOIL SURFACED ROAD TYPE B3	SCENIC SITE
GRAVEL OR STONE ROAD NOT GRADED OR DRAINED TYPE B4	CAMP SITE, NO PERMANENCE WITH OR WITHOUT PARKING
GRAVEL OR STONE ROAD GRADED AND DRAINED TYPE B5	TOILET FACILITY (CAMP OR TRAIL)
GRAVEL OR STONE ROAD WITH STABILIZED SURFACE TYPE B6	CAMP OR LODGE, PERMANENT SITE WITH BUILDINGS
BITUMINOUS ROAD-LOW TYPE TYPE B7, B8, B9	SMALL PARK
PAVED ROAD TYPE B10, B11, B12, B13, B14	FISH HATCHERY
DIVIDED HIGHWAY	BIRD SANCTUARY
HIGHWAY WITH FULL CONTROL OF ACCESS	GAME FARM
SIDE ROADS AND STREETS IN URBAN	GAME PRESERVE
PORTED URBAN COMPACTS AND EXTENSIONS OF LOCAL ROADS WITHIN MUNICIPALITIES	HIGHWAY WITH FULL CONTROL OF ACCESS
4 LANE UNDIVIDED HIGHWAY	GOLF GROUND OR COUNTRY CLUB
PRIVATE ROAD	RIFLE CLUB
PROJECTED ROAD	AMUSEMENT PARK OR MALL
		FAIR GROUND, RACE COURSE, SPEEDWAY
		DRIVE-IN THEATRE
		FARM UNITS, DWELLINGS, ETC.
		FARM UNIT
		DWELLING OTHER THAN FARM
		ROWS OR GROUPS OF DWELLINGS CLOSELY SPACED
		COMBINED DWELLING AND STORE
		DWELLING AND POST OFFICE
		DWELLING AND FILLING STATION
		DWELLING, BUSINESS, AND FILLING STATION
		TENANT HOUSE
		SEASONAL OR SUMMER COLONY DWELLING
		HOTEL, INN
		CHURCH OR OTHER RELIGIOUS INSTITUTION
		CHURCH AND SCHOOL
		CEMETERY
		CHURCH WITH CEMETERY ADJACENT
		FRESH AIR FARM OR REST HOME
		HOSPITAL
		WELL
		STATE PORT OF ENTRY OR WEIGHT STATION
		GROUP OF MIXED CULTURAL FEATURES CLOSELY SPACED
		INDUSTRIAL
		STORE OR SMALL BUSINESS ESTABLISHMENT
		BUSINESS AND POST OFFICE
		BUSINESS AND FILLING STATION
		BUSINESS, FILLING STATION, AND POST OFFICE
		FACTORY OR INDUSTRIAL PLANT
		MINE SHAFT OR DRIFT
		OIL OR GAS WELL
		OIL TANK
		GAS TANK
		GROUP OF STORAGE TANKS (OIL OR GAS)
		FILLING STATION (NOT CONNECTED WITH OTHER BUSINESS)
		PUMPING STATION (OIL OR GAS)
		GAUGING OR PUMPING STATION (GENERAL)
		VALVE HOUSE
		SEASONAL INDUSTRY (CANNERY OR SMALL SWAIN WELLY)
		MILK DEPOT, CREAMERY OR CHEESE FACTORY
		FRUIT OR NUT ORCHARD
		ROAD STAND FARM PRODUCTS SALES
		WAREHOUSE-GENERAL (UP TO 100,000 SQ. FT. OR MORE)
		GRAIN ELEVATOR
		GROUP OF GRAIN STORAGE BINS
		GREENHOUSE
		NURSERY
		STOCK YARD-LOADING PEN OR CORRAL
		STOCK PEN AT RAILROAD SIDING
		GRAVEL PIT
		QUARRY
		KILN OR OVEN (LIME, CLAY, PRODUCTS, COKE, ETC.)
		EDUCATIONAL AND CORRECTIONAL INSTITUTIONS
		SCHOOLHOUSE
		CONSOLIDATED OR LARGE SCHOOL
		TOWNHALL, GRANGE, OR COMMUNITY HALL
		AGRICULTURAL EXPERIMENT STATION
		COUNTY FARM
		CORRECTIONAL INSTITUTION
		PUBLIC SERVICE FACILITIES
		POST OFFICE
		HIGHWAY GARAGE
		FIRE ENGINE HOUSE
		GARAGE OR RUBBISH DUMP
		SEWAGE DISPOSAL PLANT
		AUTO SALVAGE YARD
		TRANSFORMER STATION
		POWER PLANT
		BOOSTER STATION
		WATER SUPPLY, STAND PIPE, OR TANK
		RADIO STATION
		RADIO RANGE STATION
		MISCELLANEOUS
		FORT, ARMY CAMP, BARRACKS, OR OTHER
		MILITARY POST
		TRIANGULATION STATION
		BENCH MARK (with elevation)
		NATURAL FEATURES
		PROMINENT ELEVATION WITH NAME
		SINK OR DEPRESSION

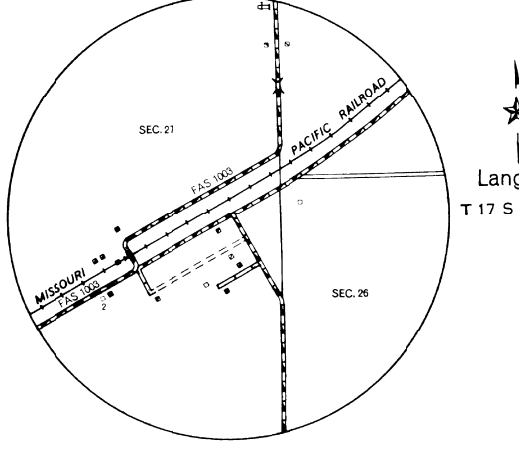
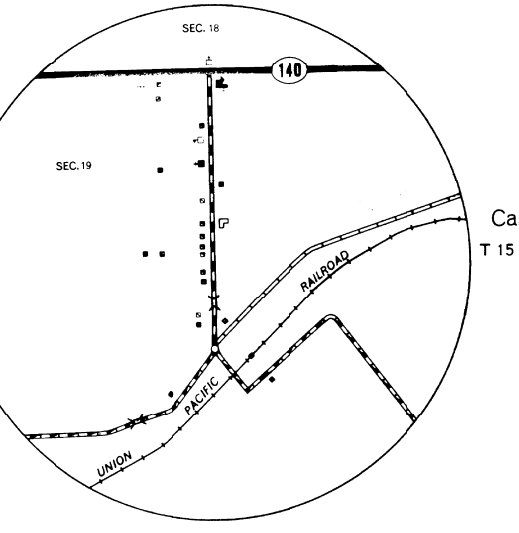
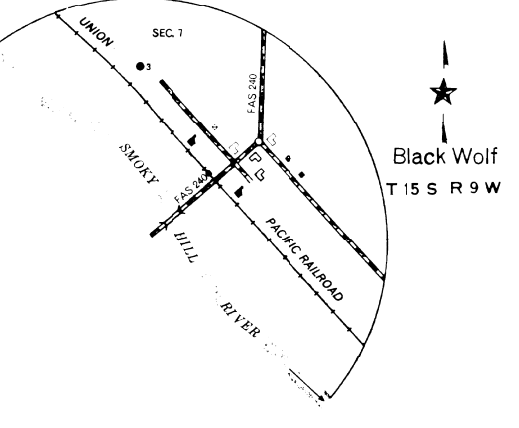
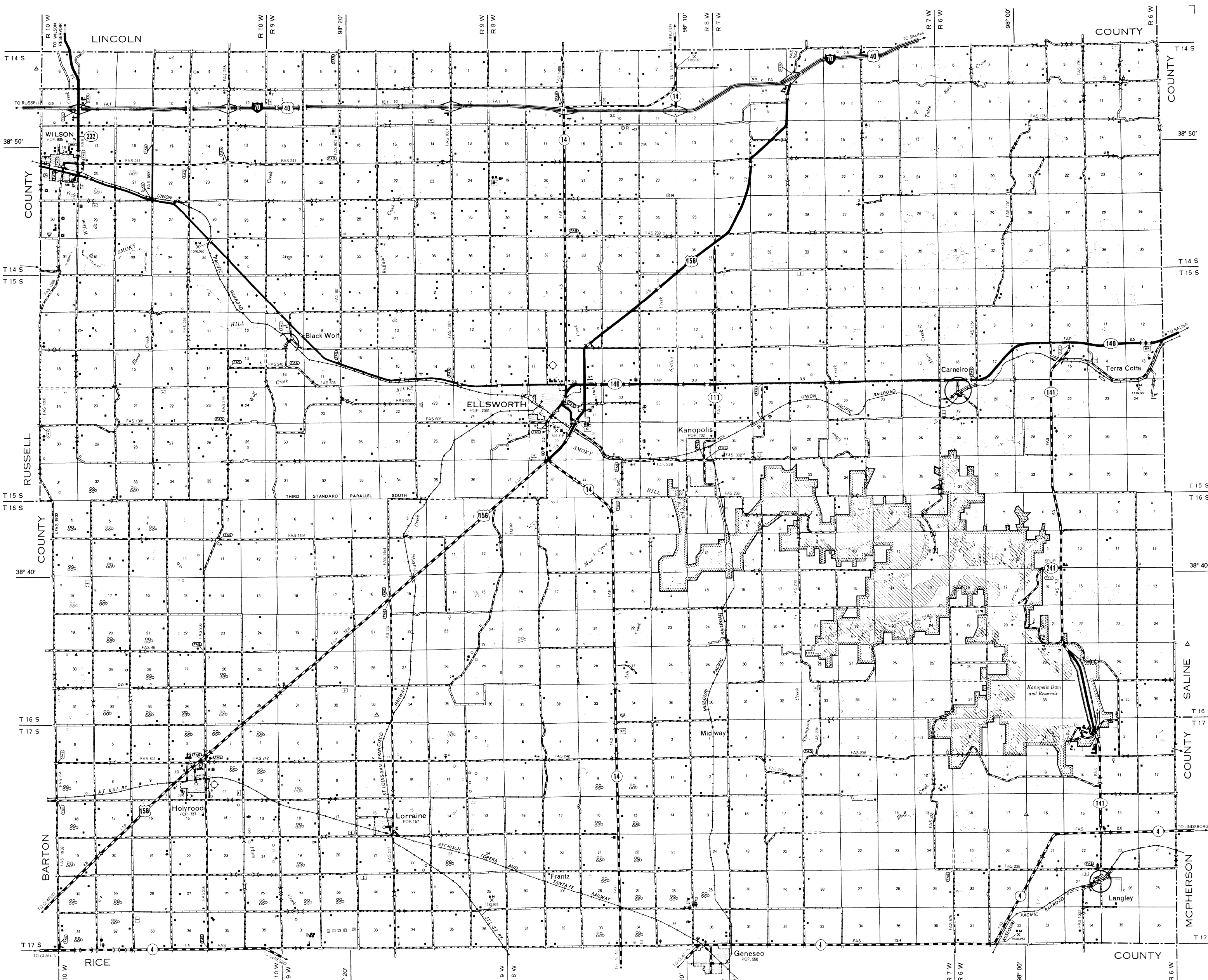

GENERAL HIGHWAY MAP ELLSWORTH COUNTY KANSAS

PREPARED BY THE
STATE HIGHWAY COMMISSION OF KANSAS
DEPARTMENT OF PLANNING AND DEVELOPMENT
IN COOPERATION WITH THE
U. S. DEPARTMENT OF TRANSPORTATION
FEDERAL HIGHWAY ADMINISTRATION

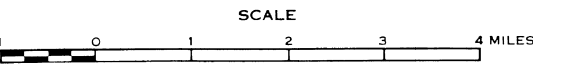

1970

POLYCONIC PROJECTION

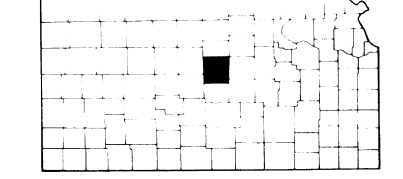

KEY TO COUNTIES

BOUNDARY COMPLETED BY THE U.S. GEOLOGICAL SURVEY AND STATE SYSTEMS REVISION TO 1970

