

Saffordville
T 19 S R 6 E

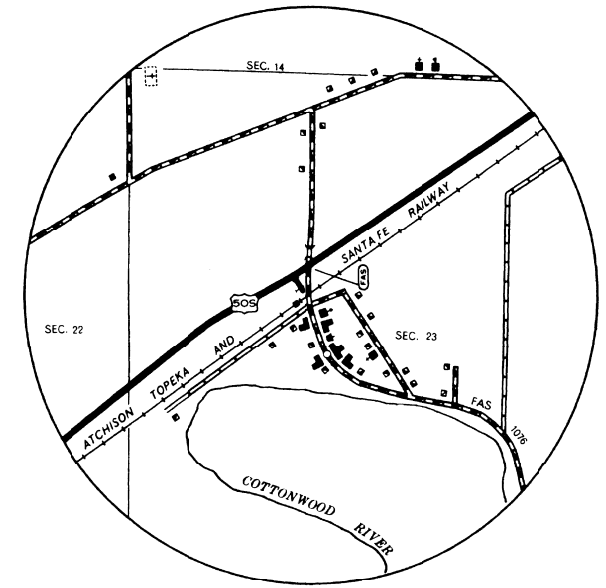

Clements
T 20 S R 6 E

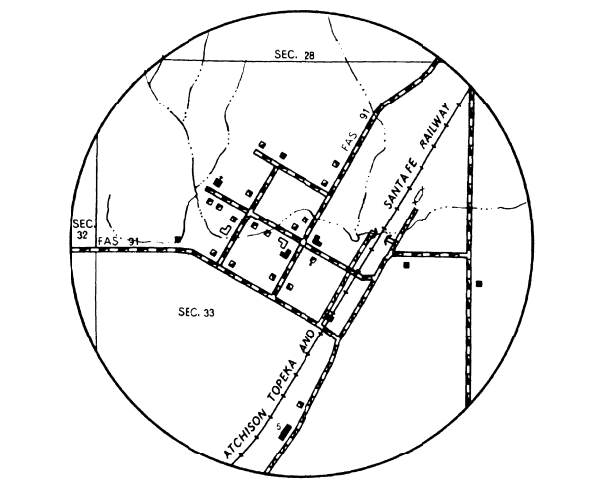

Bazaar
T 20 S R 8 E

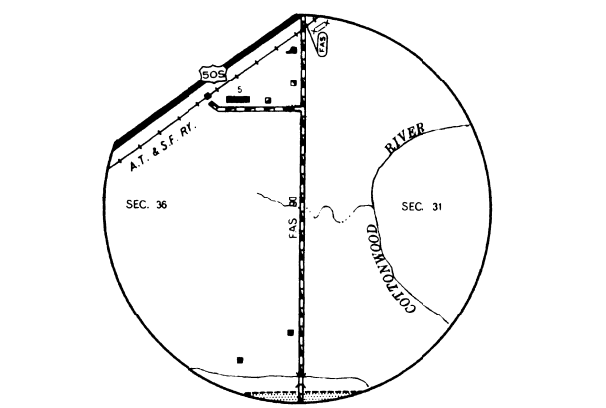

Wonevevu
T 22 S R 6 E

ENLARGEMENT SCALE
1 MILE

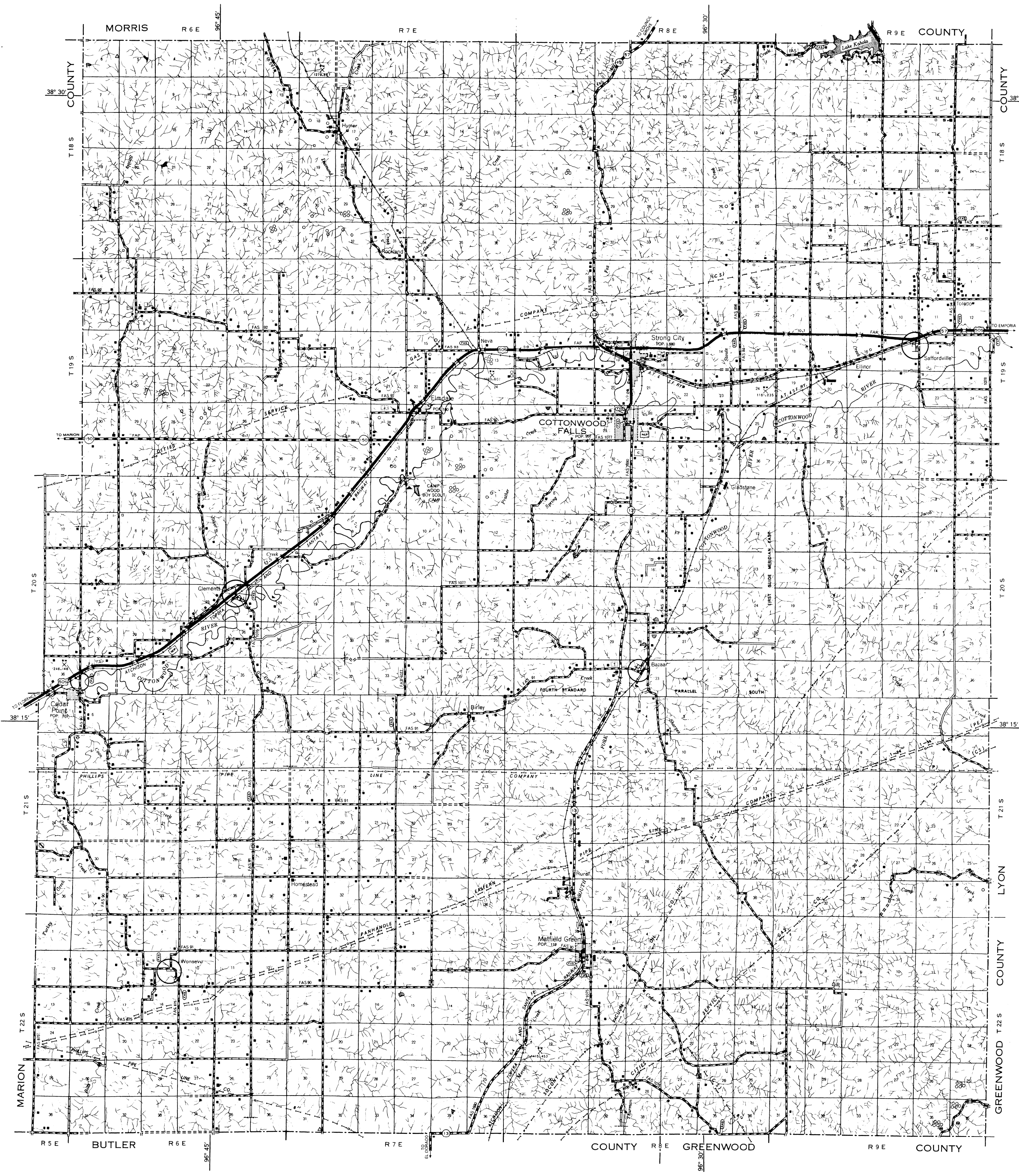

ROADS AND ROADWAY FEATURES		CONSERVATION AND RECREATION		
PRIMITIVE ROAD (TYPE 21)	UNIMPROVED ROAD (TYPE 22)	PICNIC GROUND	PLAYGROUND-PARK FIELD, ETC.	
GRADED AND DRAINED ROAD (TYPE 23)	SOIL SURFACED ROAD (TYPE 24)	BATHING BEACH OR SWIMMING POOL	SCENIC SITE	
GRAVEL OR STONE ROAD (TYPE 25)	GRAVEL OR STONE ROAD (TYPE 26)	CAMP SITE AND PERMANENCE TRAIL OR TRAILER PARKING	TOURIST COURT OR MOTEL	
GRADED AND DRAINED ROAD (TYPE 27)	GRAVEL OR STONE ROAD WITH STABILIZED SURFACE (TYPE 28)	CAMP OR LODGE (PERMANENT SITE WITH BUILDINGS)	SMALL PARK (ACRES 1-10)	
BITUMINOUS ROAD-LOW TRAFFIC (TYPE 29, 30, 31)	PAVED ROAD (TYPE 32, 33, 34, 35)	FISH HATCHERY	BIRD SANCTUARY	
DIVIDED HIGHWAY	SIDE ROADS AND STREETS IN UNINCORPORATED AREAS	GOLF COURSE	GAME FARM	
PORATED URBAN COMPACTS AND EXTENSIONS OF LOCAL ROADS WITH MUNICIPALITIES	4 LANE UNDIVIDED HIGHWAY	GAME PRESERVE	RIFLE CLUB	
PRIVATE ROAD	PROJECTED ROAD	POLO GROUNDS	POLO GROUNDS	
ROAD SYSTEM DESIGNATION		AMUSEMENT PARK OR HALL	FAIR GROUND, RACE COURSE, SPEEDWAY	
FEDERAL AID PRIMARY HIGHWAY SYSTEM	FEDERAL AID SECONDARY HIGHWAY SYSTEM	DRIVE-IN THEATRE		
FEDERAL AID URBAN HIGHWAY SYSTEM	STATE AID ROAD	FARM UNITS, DWELLINGS, ETC.		
POINTS BETWEEN WHICH DISTANCES ARE MEASURED INDICATED THUS	TRAFFIC CIRCLE	FARM UNIT	DWELLING (OTHER THAN FARM)	
CLOVER LEAF	U. S. NUMBERED HIGHWAY	ROWS OR GROUPS OF DWELLINGS CLOSELY SPACED	COMBINED DWELLING AND STORE	
STATE HIGHWAY SYSTEM OR STATE NUMBERED HIGHWAY	END OF DESIGNATED SYSTEM OR MARKED ROUTE	DWELLING AND FILLING STATION	DWELLING, BUSINESS, AND FILLING STATION	
RAILROADS		SEASONAL OR SUMMER COLONY DWELLING	HOTEL, INN	
RAILROAD (GENERAL)	RAILROAD IN URBAN PORTION	CHURCH OR OTHER RELIGIOUS INSTITUTION	CHURCH AND SCHOOL (JOINT USE)	
NARROW GAUGE RAILROAD	ELECTRIC INTERURBAN OR SUBURBAN RAILROAD	CEMETERY	FRESH AIR FARM OR REST HOME	
ABANDONED RAILROAD (TRACK REMOVED)	ABANDONED ELECTRIC LINE (TRACK REMOVED)	HOSPITAL	WELL	
RAILROAD STATION	RAILROAD CROSSINGS	STATE PORT OF ENTRY OR WEIGHT STATION	GROUP OF MIXED CULTURAL FEATURES CLOSELY SPACED	
GRADE CROSSING	RAILROAD ABOVE	INDUSTRIAL		
RAILROAD BELOW	RAILROAD BRIDGE	STORE OR SMALL BUSINESS ESTABLISHMENT	BUSINESS AND FILLING STATION	
RAILROADS ON STREETS OR ROADS		BUSINESS AND FILLING STATION	BUSINESS AND FILLING STATION AND POST OFFICE	
STANDARD GAUGE RAILROAD	ELECTRIC RAILROAD	FACTORY OR INDUSTRIAL PLANT	MINE-SHAFT OR DRIFT (SEE NOTE)	
AIRWAYS AND AIRPORTS		OIL OR GAS WELL	OIL OR GAS FIELD	
AIR ROUTE	MILITARY FIELD (SEE NOTE)	GAS TANK	GROUP OF STORAGE TANKS (SEE NOTE)	
AIRFIELD, COMPLETE FACILITIES (COMMERCIAL OR MILITARY)	AIRFIELD, LIMITED FACILITIES	FILLING STATION (NOT CONNECTED WITH OTHER BUSINESS)	PUMPING STATION (SEE NOTE)	
LANDING AREA OR STRIP (INCLUDING PRIVATE AIRFIELD)	AIRWAY LIGHT BEACON, GENERAL	GAUGING OR PUMPING STATION (FEDERAL)	VALVE HOUSE	
AIRPORT-GENERAL		SEASONAL INDUSTRY (ICEHARVEST OR SMALL GRAIN MILL)	MILK DEPOT, CREAMERY OR CHEESE FACTORY	
NAVIGATION		FRUIT OR NUT ORCHARD	FRUIT OR PRODUCE PACKING HOUSE	
NAVIGABLE STREAM (SEE NOTE)	INTERMITTENT STREAM	ROAD STAND FARM PRODUCTS SALES	WAREHOUSE-GENERAL (IF GOVERNMENT AND STATE OR U. S. MILITARY)	
DRAINAGE		GRAIN ELEVATOR	BEST DUMP	
INTERMITTENT STREAM	INTERMITTENT STREAM	GREENHOUSE	HURRIERY	
NARROW STREAM	WIDE STREAM	STOCK YARD-LOADING PEN OR CORRAL	STOCK PEN AT RAILROAD SIDING	
DRAINAGE DITCH	LAKE, RESERVOIR, OR POND WITH DAM	GRAVEL PIT	QUARRY	
LAKE, RESERVOIR, OR POND WITHOUT DAM	DRY LAKE SUBJECT TO FLOOD	EDUCATIONAL AND CORRECTIONAL INSTITUTIONS		
MARSH OR SWAMP LAND	OVERFLOW LAND	SCHOOLHOUSE	CONSOLIDATED OR LARGE SCHOOL	
HIGHWAY BRIDGES		TOWNHALL, GRANGE, OR COMMUNITY HALL	AGRICULTURAL EXPERIMENT STATION	
GENERAL	ANCH	COUNTY FARM	CORRECTIONAL INSTITUTION	
TRUSS OR GIRDER (SEE NOTE)	CANTILEVER BRIDGE	PUBLIC SERVICE FACILITIES		
COVERED BRIDGE	HIGHWAY GRADE SEPARATION	POST OFFICE	HIGHWAY GARAGE	
MISCELLANEOUS STRUCTURES		FIRE ENGINE HOUSE	GARBAGE OR RUBBISH DUMP	
DAM WITH ROAD	LEVEE OR DIKE	SEWAGE DISPOSAL PLANT	WATER SUPPLY, STAND PIPE OR TANK	
LEVEE OR DIKE WITH ROAD	FORD-ROAD ESTABLISHED	PIPE LINE, GAS	PIPE LINE, OIL	
CATTLE GUARD	GATE ACROSS ROAD	PIPE LINE, PRODUCTS	TRANSMISSION LINE (WITH TRANSFORMER STATION)	
BOUNDARIES		POWER PLANT	POWER SUBSTATION	
STATE	COUNTY	BOOSTER STATION	UNDERGROUND TELEPHONE OR RADIO CABLE	
CORPORATE LINES	BOUNDARY LINES ESTABLISHED FOR DELIMITED URBAN PLACES	RADIO STATION (WITH CALL LETTERS)	RADIO RANGE STATION	
SECTION LINE	MATCH LINE BETWEEN ADJOINING SHEETS OF SAME COUNTY	MISCELLANEOUS		
BOUNDARY TO MARK ENLARGEMENT INSET	PARKS AND OTHER RESERVATIONS NATIONAL, STATE, COUNTY, OR MUNICIPAL PARK, INDIAN RESERVATION, NATIONAL MONUMENT, FEDERAL DEVELOPMENT PROJECT, MONUMENT-SMALL, HISTORIC SITE	FORT, ARMY CAMP, BARRACKS, OR OTHER MILITARY POST	TRIANGULATION STATION	
STATE CAPITAL	CITY AND VILLAGE CENTERS	BENCH MARK (WITH ELEVATION)	NATURAL FEATURES	
COUNTY SEAT	OTHER CITIES AND VILLAGES	PROMINENT ELEVATIONS WITH ACRES		
BOUNDARY LIMITS FIXED FOR SPECIAL TOWN AND OTHER UNINCORPORATED URBAN PLACES DELIMITED		SINK OR DEPRESSION		

GENERAL HIGHWAY MAP CHASE COUNTY KANSAS

PREPARED BY THE
STATE HIGHWAY COMMISSION OF KANSAS
HIGHWAY PLANNING DEPARTMENT
IN COOPERATION WITH THE
U. S. DEPARTMENT OF COMMERCE
BUREAU OF PUBLIC ROADS

SCALE
0 1 2 3 4 MILES

1953
POLYCONIC PROJECTION

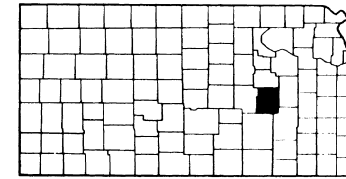

KEY TO COUNTIES
UNINCORPORATED CITIES AND VILLAGES
U. S. COUNTY AND QUARTER SURVEY
1890 (U. S. D.)