

Geneva
T 23 S R 17 E

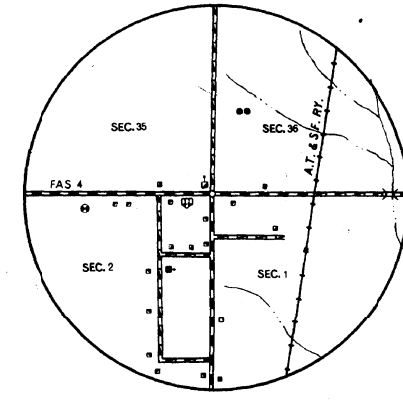

Carlyle
T 23-24 S R 18 E

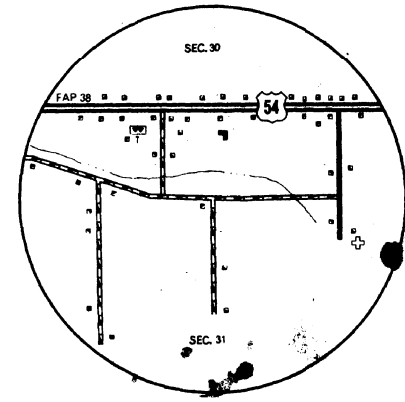

Gas City
T 24 S R 19 E

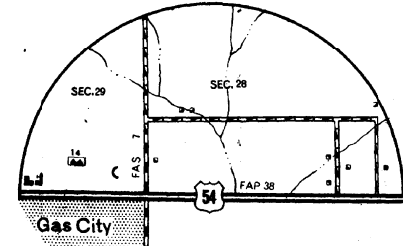

Gas City
T 24 S R 19 E

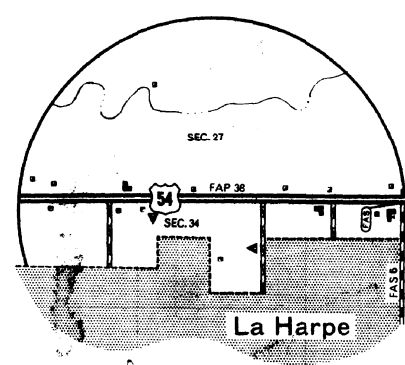

La Harpe
T 24 S R 19 E

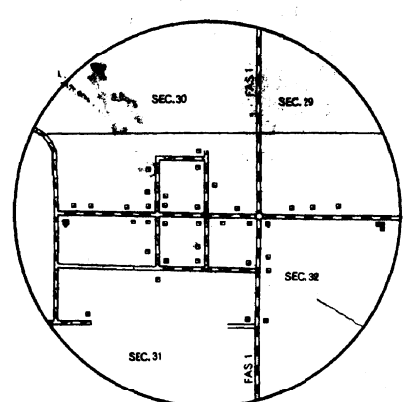

Petrolia
T 26 S R 18 E

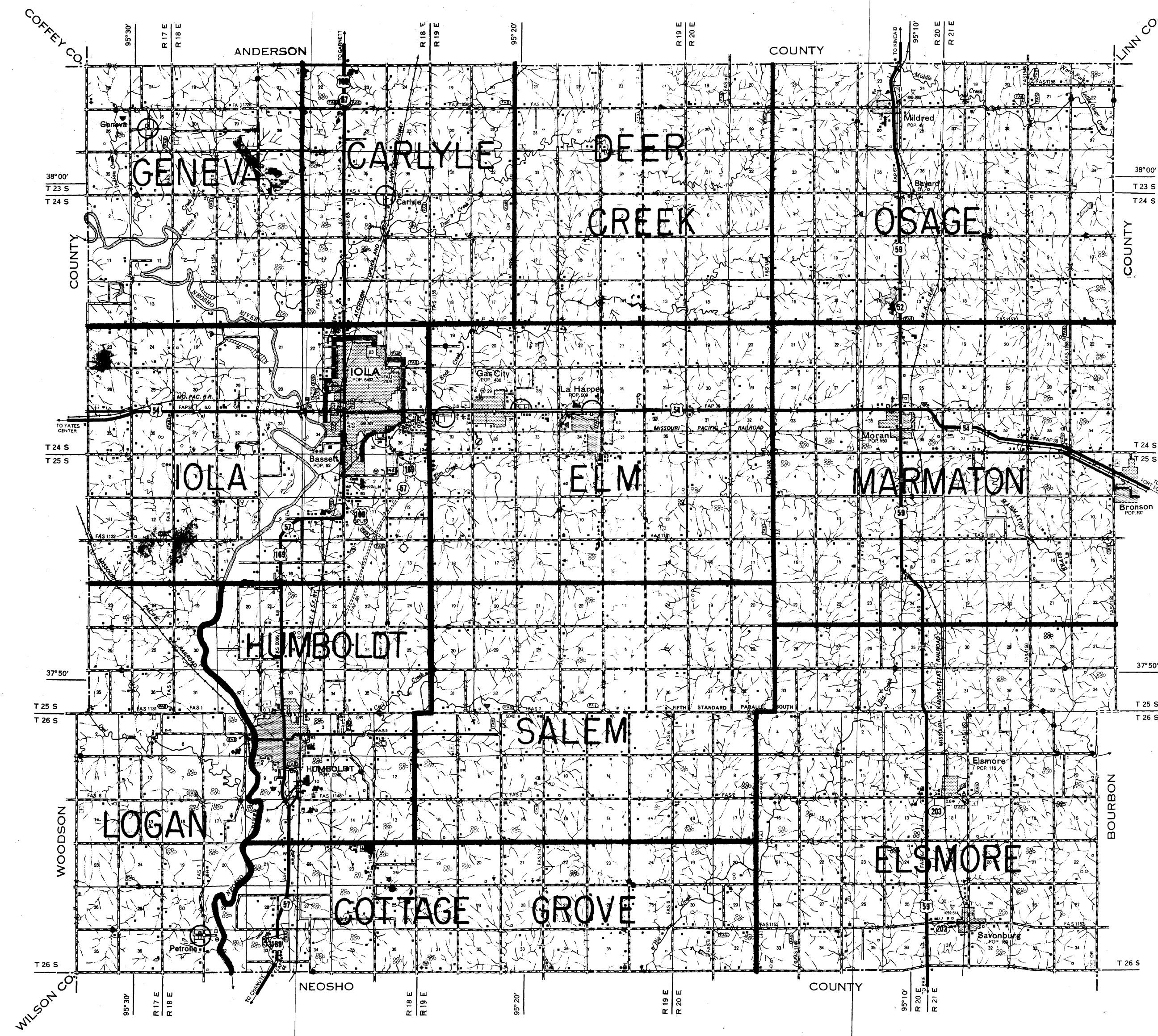

LEGEND

ROADS AND ROADWAY FEATURES	CONSERVATION AND RECREATION
<ul style="list-style-type: none"> Primitive Road (Type A) Unimproved Road (Type B) Graded and Drained Road (Type C) Soil Surfaced Road (Type D) Gravel or Stone Road Not Graded or Drained (Type E-1) Gravel or Stone Road With Stabilized Surface (Type E-2) Stabilized Surface (Type E-3) Bituminous Road - Low Type (Type F-1, F-2, F-3, F-4, F-5) Paved Road (Type G-1, G-2, H-1, H-2, H-3, H-4, H-5) Divided Highway Highway With Full Control of Access Side Roads and Streets in Unincorporated Urban Centers and Extensions of Local Roads Within Municipalities 4 Lane Undivided Highway Proposed Road 	<ul style="list-style-type: none"> Picnic Ground Playground, Ball Field, Etc. Bathing Beach or Swimming Pool State Park Camp Site (No Performance (Tents or Trailer Parking)) Tourist Court or Motel (Figure Indicates Number of Permanent Cabins or Cottages) Camp or Lodge (Permanent Site With Building) Small Park (State, City, County) MP-Municipal, SR-Safety Rest Area Game Farm Game Preserve Rifle Club Golf Ground or Country Club Riding Academy Riding Club Amusement Park or Fair Fair Ground, Race Course, Speedway Drive-In Theatre Museum Rodden Grounds Guide House or Gate House (Add Letters N or S to Indicate National or State Park)
ROAD SYSTEM DESIGNATION	FARM UNITS, DWELLINGS, ETC.
<ul style="list-style-type: none"> Federal-Aid Interstate Highway System Federal-Aid Primary Highway System Federal-Aid Secondary Highway System Federal-Aid Urban Highway System Points Between Which Distances are Measured Interstate Numbered Highway U.S. Numbered Highway State Highway System or State Numbered Highway End of Designated System or Merged Road 	<ul style="list-style-type: none"> Farm Unit Dwelling (Other Than Farm) Rows or Groups of Dwellings Closely Spaced (Figure Denotes Number of Dwellings) Combined Dwelling and Store Dwelling and Post Office Dwelling and Filling Station Dwelling, Business, and Filling Station Seasonal or Summer Colony Dwelling Home Humane Society Quarters Church or Other Religious Institution Church and School (Unit) Church With Cemetery Adjacent Fire Station Post Office State Port of Entry or Weight Station Group of Mixed Cultural Features Closely Spaced (Figure Above Line Indicates Number of Dwellings Included in this group. Figures over individual units show number of each included regardless of order)
RAILROADS	INDUSTRIAL
<ul style="list-style-type: none"> Railroad (Any Number of Tracks Used by a Single Operating Company or by Trains of Another Carrier Under Trackage Rights) Railroads in Jurisdiction (Two or More Tracks or Separately Operated Companies on Adjacent Rights-of-Way) Abandoned Railroad (Track Retained) Railroad Station 	<ul style="list-style-type: none"> Store or Small Business Establishment Business and Post Office Business and Filling Station Factory or Industrial Plant Line-Of-Work or Dam (Any Kind) Oil or Gas Well Oil or Gas Field Storage Tank (Gas or Oil Figure Denotes Number of Tanks) Filling Station (Not Connected With Other Business) Pumping Station (Oil or Gas) Gauging or Pumping Station (General) Valve House Seasonal Industry (Caninery or Small Grain Mill) Milk Depot, Creamery or Cheese Factory Fruit or Nut Orchard Fruit or Produce Picking House Road Stand Farm Produce Sales Warehouse - General (If Government Add State or U.S.) Grain Elevator Group of Grain Storage Bins Greenhouse Nursery Stock Yards (Loading Pen or Corral) Stock Pen at Railroad Siding (Small) Feed Lot Quarry High or Open (Lime, Clay Products, Coak, Etc.) Seasonal Business Shed (Stationary)
RAILROAD CROSSING	EDUCATIONAL AND CORRECTIONAL INSTITUTIONS
<ul style="list-style-type: none"> Grade Crossing Railroad Above Railroad Below Railroad Bridge 	<ul style="list-style-type: none"> Schoolhouse Consolidated or Large School Journal, Garage, or Community Hall Agricultural Experiment Station Museum - General Public Library
ARWAYS AND AIRPORTS	PUBLIC SERVICE FACILITIES
<ul style="list-style-type: none"> Military Field (Some Facilities Available) Airport Complete Facilities (Commercial or Municipal) Airfield, Limited Facilities Landing Area or Strip (Including Private Air Fields) Alley Light Season, General Airport, General 	<ul style="list-style-type: none"> Post Office Highway Garage Fire Engine House Garbage or Rubbish Dump Sewage Disposal Plant Add: Salvage Yard Transfer Station Power Plant Power Substation Booster Station Water Supply, Stand Pipe, or Tank Water Supply (With Call Letters) Radio Station Water Treatment Plant Jail U.S. Corps of Engineers Office
NAVIGATION	BOUNDARIES
<ul style="list-style-type: none"> Navigable Stream (N - intermittent navigation) Intermittent Stream (Narrow) Intermittent Stream (Wide) Narrow Stream Wash Stream Drainage Ditch Irrigation Ditch Lake, Reservoir, or Pond Lake, Reservoir, or Pond With Dam Dry Lake Subject To Flood Maree or Swamp Land Overflow Land 	<ul style="list-style-type: none"> State County Corporate Lines Boundary Lines Established For Delimited Urban Places Section Line Boundary to Mark Entertainment Asset Park and Other Reservations National, State, County, or Municipal Park, Indian Reservation, National Monument, Federal Development Project Monument - Small, Historic Site
BRIDGES	CITY AND VILLAGE CENTERS
<ul style="list-style-type: none"> Highway Bridge, General (Total Span Greater Than 20 Feet) Small Bridges Closely Spaced Bridges For Long River Crossings General Arch Truss or Girder (In Wood or Steel) Canalover Bridge Highway Grade Separation Nonferrous Structures Levee Or Dike Levee Or Dike With Road Concrete Ford Or Dip Ford Road Established Cattle Guard Gate Across Road (Any Type) 	<ul style="list-style-type: none"> State Capital County Seat Other Cities and Villages Incorporated City or Village Boundary Lines Fixed for Special Taxing Areas and Other Unincorporated Urban Places Delimited
STRUCTURES	NATURAL FEATURES
<ul style="list-style-type: none"> Highway Bridge, General Small Bridges Closely Spaced Bridges For Long River Crossings General Arch Truss or Girder (In Wood or Steel) Canalover Bridge Highway Grade Separation Nonferrous Structures Levee Or Dike Levee Or Dike With Road Concrete Ford Or Dip Ford Road Established Cattle Guard Gate Across Road (Any Type) 	<ul style="list-style-type: none"> Prominent Elevation - With Name (Numbers Indicate Elevation Above Sea Level) Sink or Depression

GENERAL HIGHWAY MAP ALLEN COUNTY KANSAS

PREPARED BY THE
KANSAS DEPARTMENT OF TRANSPORTATION
PLANNING AND DEVELOPMENT DEPARTMENT
IN COOPERATION WITH THE
U. S. DEPARTMENT OF TRANSPORTATION
FEDERAL HIGHWAY ADMINISTRATION

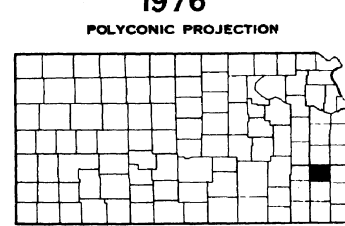
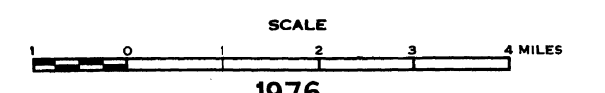

REVISIONS COMPLETED 2-20-76
F.A. AND STATE SYSTEMS REVISED TO 8-20-76